

Improvements to

Mary Ellen Welch Greenway

Community Meeting #3



October 08, 2024
Boston Parks and Recreation



Zoom Interpretation Services



English: For interpretation in [____],

1. Go to the horizontal control bar at the bottom of your screen. Click on “Interpretation.”
2. Then click on the language that you would like to hear.
3. You are now accessing this meeting in [_____]

Spanish: Para traducción en Español,

1. Vaya a la parte baja de la pantalla, en la barra horizontal, y presione la tecla “Interpretation”.
2. Luego seleccione el idioma que desea escuchar.
3. Después de seleccionar, usted entrará a la reunión en el idioma “Español”.

Arabic: للترجمة باللغة العربية

- ١- من خلال شريط التحكم الأفقي الموجود أسفل الشاشة انقر على خيار " Interpretation"
- ٢- ثم اختار اللغة التي تود الاستماع اليها .
- ٣- الآن يمكنك متابعة هذا الاجتماع باللغة العربية .

Brazilian Portuguese: Para interpretação int Português.

1. Vá para a barra de controle horizontal na parte inferior da tela. Clique em “Interpretation”.
2. Em seguida, clique no idioma que deseja ouvir.
3. Agora você está acessando esta reunião em Português

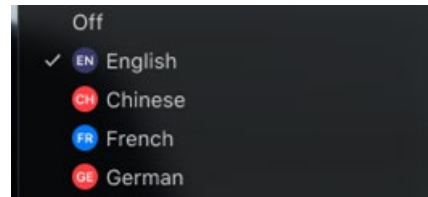

MEETING RECORDING



The Boston Parks and Recreation Department will be recording the meeting and posting to our project webpage for those who are unable to attend the Zoom meeting live.

It is possible that participants may also be recording the meeting with their phones cameras or other devices. If you do not wish to be recorded during this meeting, please keep your microphone and camera off.

VIRTUAL MEETING ETIQUETTE

We want to ensure this conversation feels accessible to everyone and each one of you feels comfortable sharing your questions and comments.

Please be respectful and mindful of other's time when asking questions/ providing comments, so that all attendees are able to participate in the meeting.

Keep questions/ comments project-specific and not personal to yield a solution driven discussion.

You can always set up a conversation with Amy Linné, amy.linne@boston.gov to further discuss the project or process.

ZOOM TIPS

Here is how you can participate during the question and answer part of the presentation.

DURING THE PRESENTATION:



VIA WEB:

Turn video on / off.

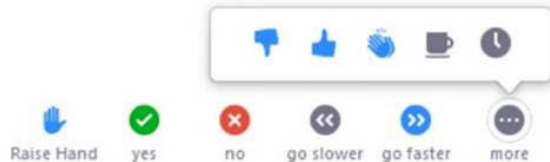

To use these non-verbal options click on participants (bottom of screen); these options will pop up in side bar.

DURING THE Q&A:



JOINING VIA PHONE?

Use *9 to raise hand to ask for audio / video permission to ask questions or provide comments.



VIA WEB:

Chat to ask questions / comments or provide responses to poll questions



Raise hand to ask for audio / video permission to ask questions or provide comments.

AGENDA

1

PROJECT TEAM INTRODUCTION

2

PROJECT OVERVIEW

3

SUMMARY OF WHAT WE HEARD JUNE 2024

4

EXISTING CONDITIONS RECAP

5

GREENWAY DESIGN

6

NEXT STEPS

PROJECT TEAM

Amy Linné

MEW Greenway Project Manager
Boston Parks & Recreation Department
amy.linne@boston.gov

Roberto Gomez

East Boston Liaison
Office of Neighborhood Services
roberto.gomez@boston.gov

Weston & Sampson Design Team:

Cheri Ruane, FASLA, RLA

Practice Leader, Landscape Architecture

Lin Ye, RLA

Project Manager

Farah Dakkak, RLA

Project Landscape Architect



MEETING GOALS AND OBJECTIVES

- Present the final design for the greenway path, entry spaces, and amenities including drainage improvements.
- Respond to questions and comments from the community.



PROJECT SCHEDULE

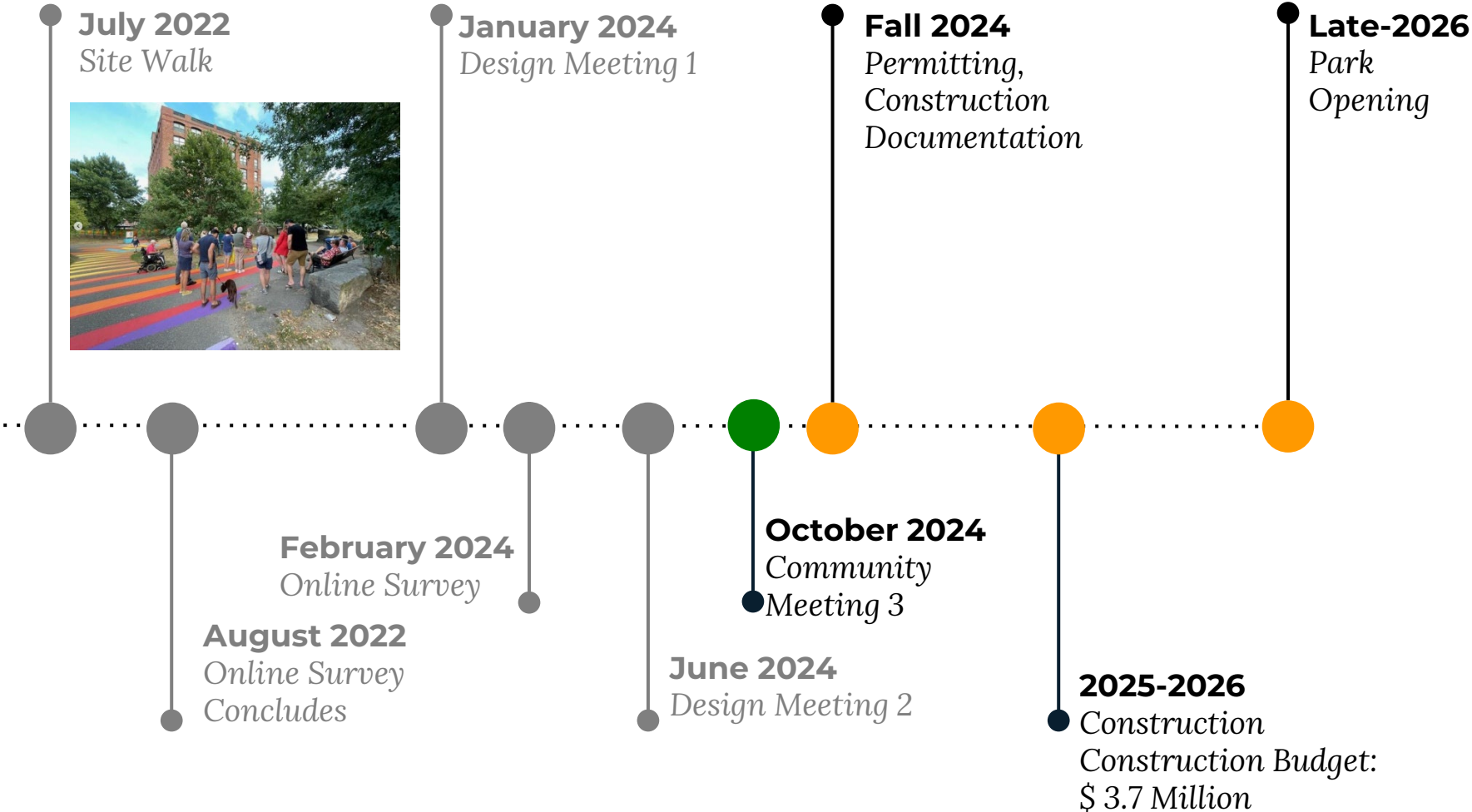

WHAT WE HEARD

June 2024

24 ATTENDEES

- Single path at 12' seems narrow, can it be wider.
- Lighting updates needed and accent lighting should be considered.
- Concern was voiced that the runoff from the adjacent properties is a major contributor to the flooding.
- Gove Street place making opportunities.
- Entrance Special Pavers: Corner of Maverick and Orleans Street needs to be strengthened with pavers, signage, and placemaking strategies.
- Container storage for the deployable barrier would benefit from decorative painting.
- More trash cans.
- Prevent camping on-site.
- Signage can be helpful for wayfinding.
- Dog walkers should be accommodated.

EXISTING CONDITIONS



MARGINAL STREET

BREMEN STREET

SUMMER ST

MAVERICK STREET

GOVE STREET

BREMEN STREET

ORLEANS STEET

PORTER STREET

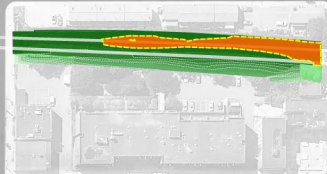
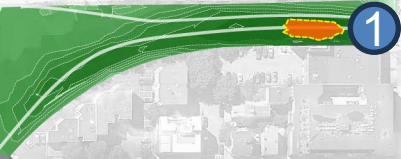

Existing low spots (prone to flooding)

EXISTING CONDITIONS - FLOODING

CAUSES OF STORMWATER FLOODING ON THE GREENWAY

- High water table and low infiltration rates
- Drainage pipes emptying into the Harbor (fill up at high tide)
- Low elevation of the Greenway
- Impervious surfaces and run off at adjacent properties
- Limited capacity of existing BPRD Pump

SOLUTIONS TO ADDRESSING STORMWATER FLOODING

- Green and grey infrastructure
- Tide gates (BWSC)
- Pump Station (BWSC)
- Decreased impervious surfaces
- Elevated portions of the pathway / bridging over wet areas
- Coordinating with abutters on containing runoff on site

GREENWAY DESIGN



- Access and Circulation
- Paving Improvements
- Paving Markings
- Seating and Site Furnishing
- Tree Planting
- Stormwater Management
- Signage
- Lighting

GREENWAY DESIGN OVERVIEW

- Paving Improvements
- Site Furnishings
- Lighting
- Planting Areas



GREENWAY DESIGN – ACCESS & CIRCULATION

MARGINAL STREET ENTRY - NORTH



GOVE STREET ENTRY



PORTER STREET ENTRY



MARGINAL STREET ENTRY - SOUTH



GREENWAY DESIGN – PAVING IMPROVEMENTS

EXTENDED CONCRETE PAVING AT ENTRANCE

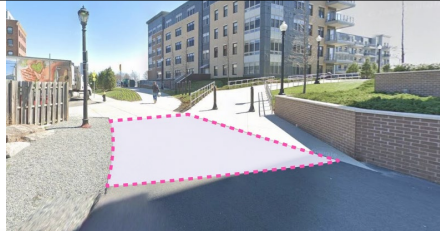
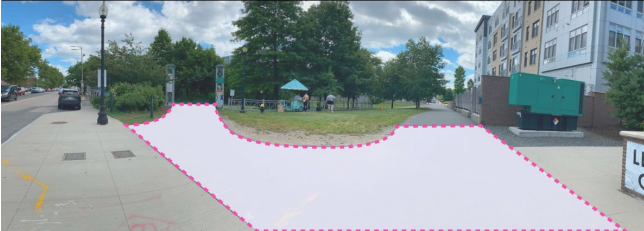

CONCRETE PAVING



BREMEN STREET



MAVERICK STREET



COVE STREET

BREMEN STREET

ORLEANS STEET

PORTER STREET



ORLEANS STEET



SUMMER ST

- █ PEDESTRIAN ASPHALT PAVING
- █ CONCRETE PAVING
- █ CONCRETE UNIT PAVER

CONCRETE UNIT PAVER



PEDESTRIAN ASPHALT PAVING



GREENWAY DESIGN – PAVING MARKINGS



-  USE SEPARATION PAVING MARKINGS
-  ENTRY SPACE CONCRETE PAVING BANDS
-  YIELD PAVING MARKINGS

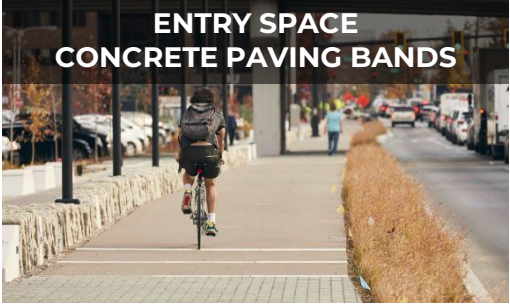

GREENWAY DESIGN – SEATING & SITE FURNISHING



**OUTDOOR CAFÉ
TABLE & CHAIR**



TRASH RECEPTACLE



BIKE RACK



MARGINAL STREET

BREMEN STREET

SUMNER ST

ORLEANS STEET

MAVERICK STREET

GOVE STREET

BREMEN STREET

ORLEANS STEET

GOVE STREET

PORTER STREET

-  OUTDOOR SEATING
-  TRASH RECEPTACLE
-  BIKE RACK
-  BENCH SEATING
-  GRANITE BLOCK SEATING



**BACKED BENCH WITH
MID-ARM REST**



GRANITE BLOCK SEATING

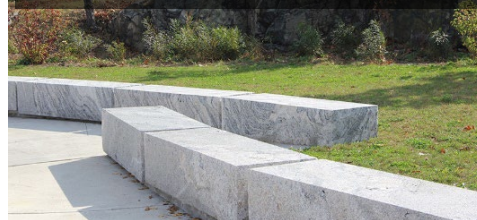

GREENWAY DESIGN – TREE PLANTING



GREENWAY DESIGN – STORMWATER MANAGEMENT



GREENWAY DESIGN – SIGNAGE



City of Boston Regulation Signage

Enjoy Your Park
 Visitors Please Take Notice

- Park closes at dusk unless otherwise posted
- No alcoholic beverages
- No vehicular access
- Dogs on leashes only
- Clean up after your dog

NO SMOKING - \$250.00 FINE

Park users are subject to the rules and regulations of the Boston Parks Department.
 For inquiries regarding this park, please call 3-1-1
 In case of emergency please call 9-1-1

Disfruta Tu Parque
 Visitantes, atención por favor

Este parque cierra al atardecer a menos que se indique lo contrario.
 Prohibido el consumo de bebidas alcohólicas.
 Prohibido el uso de vehículos de motor.
 Perros sujetos con collar y correa solamente.
 Favor de limpiar el excremento de su perro.

NO FUMAR - MULTA DE \$ 250

Los usuarios del parque tienen que seguir las reglas de la Comisión de Parques.
 Si tienes alguna pregunta sobre el parque, por favor llamar a 311-1-1
 En caso de emergencia llama al 911-1-1

Greenway Regulation Signage/no moped



- Marginal Street Signage
- City of Boston Park Name Sign
- City of Boston Regulation Signage



GREENWAY DESIGN – LIGHTING UPDATES



- The design team conducted a nighttime walk and measured light levels along the Greenway noting areas of low light levels and reason for those.
- Site wide lighting updates to convert all light fixtures to LED
- Tree pruning in select areas to allow for better site lighting

 EXISTING LIGHT FIXTURE	 LIGHT POLE IN NEED OF REPLACEMENT	 UNDERPASSES – LIGHTING ISSUES
 LIGHT FIXTURE NEEDS REPAIR/NOT FUNCTIONING DURING SITE WALK	 LIGHT POLE BEING MOVED/REPLACED DUE TO DESIGN NEEDS	 CURRENT INSUFFICIENTLY LIT AREA

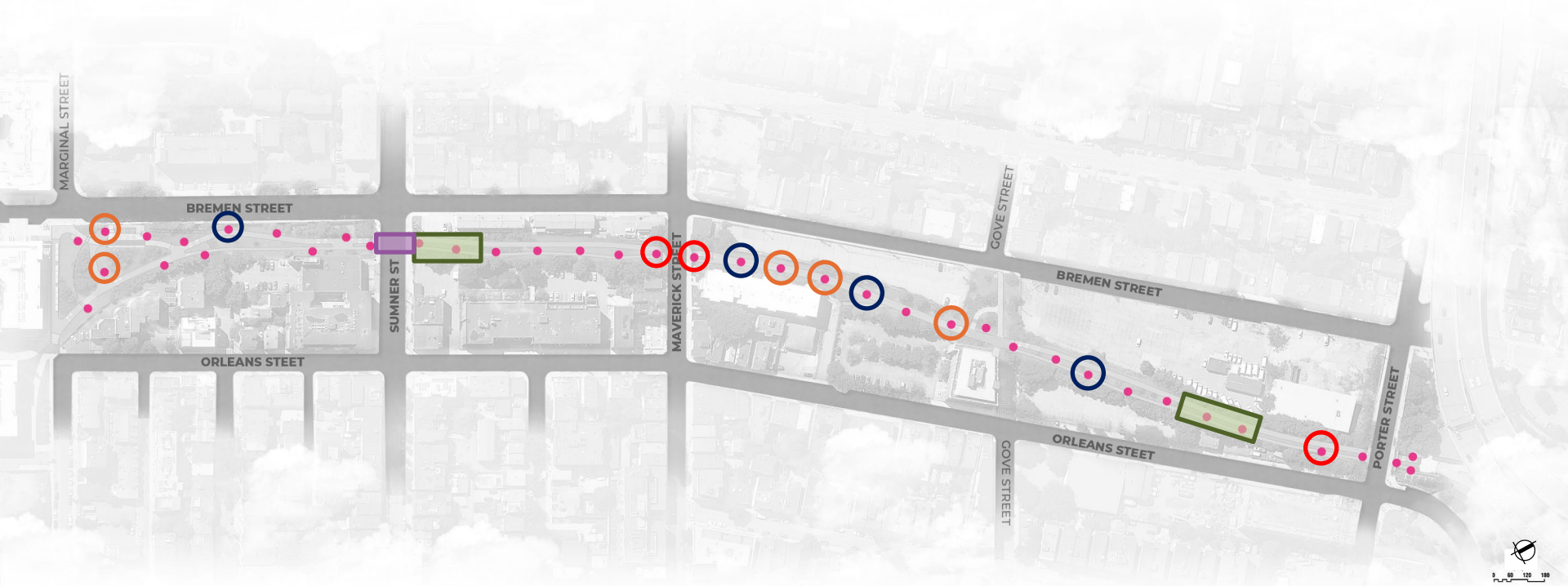

BLUE CABOOSE AREA

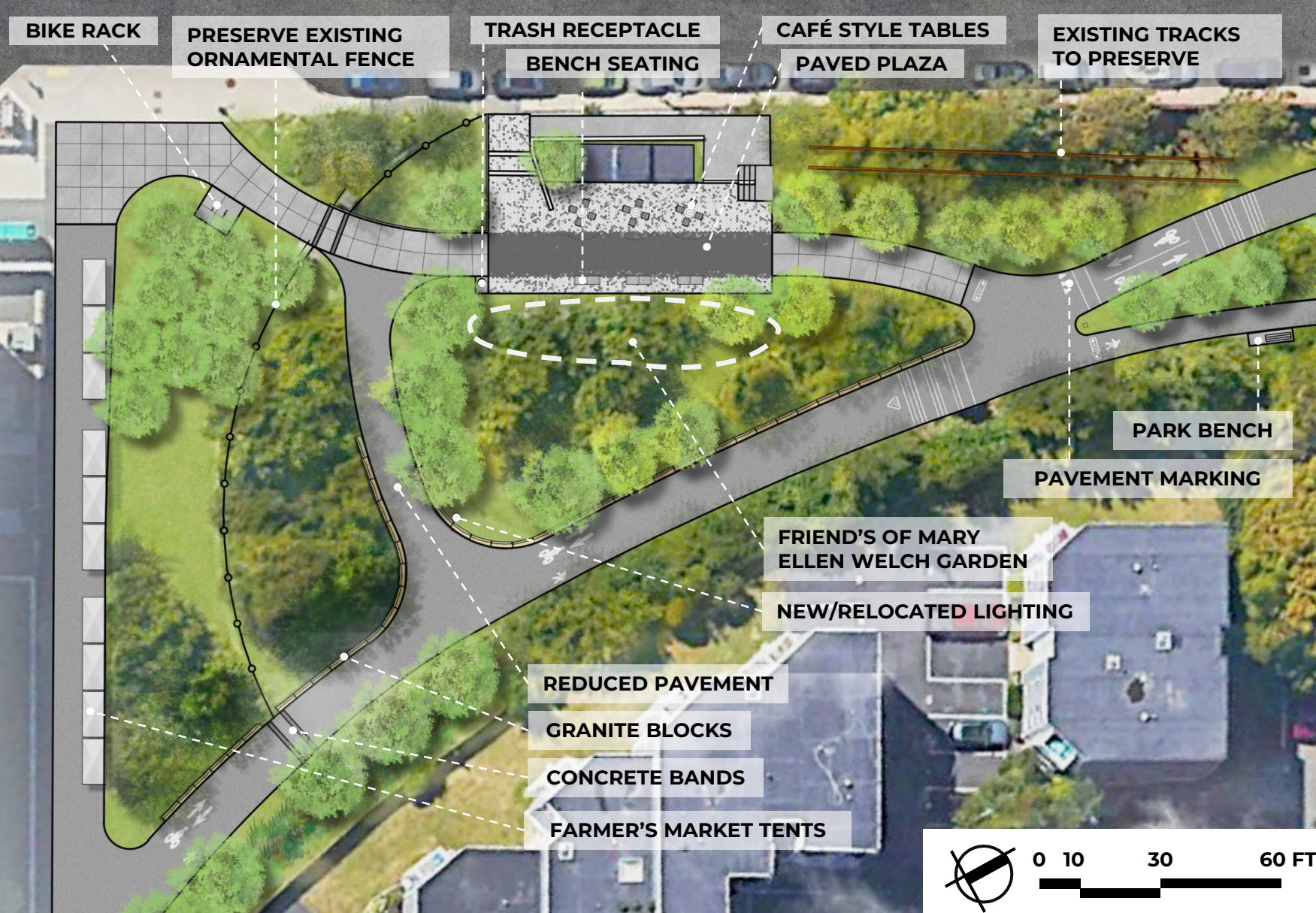

ACTIVITIES AT MARGINAL STREET ENTRY

PICNIC TABLE AND CHAIRS



FRIEND'S OF MARY ELLEN WELCH
GREENWAY GARDEN



MARGINAL ENTRY POTENTIAL
FARMER'S MARKET AREA



MARGINAL STREET ENTRY

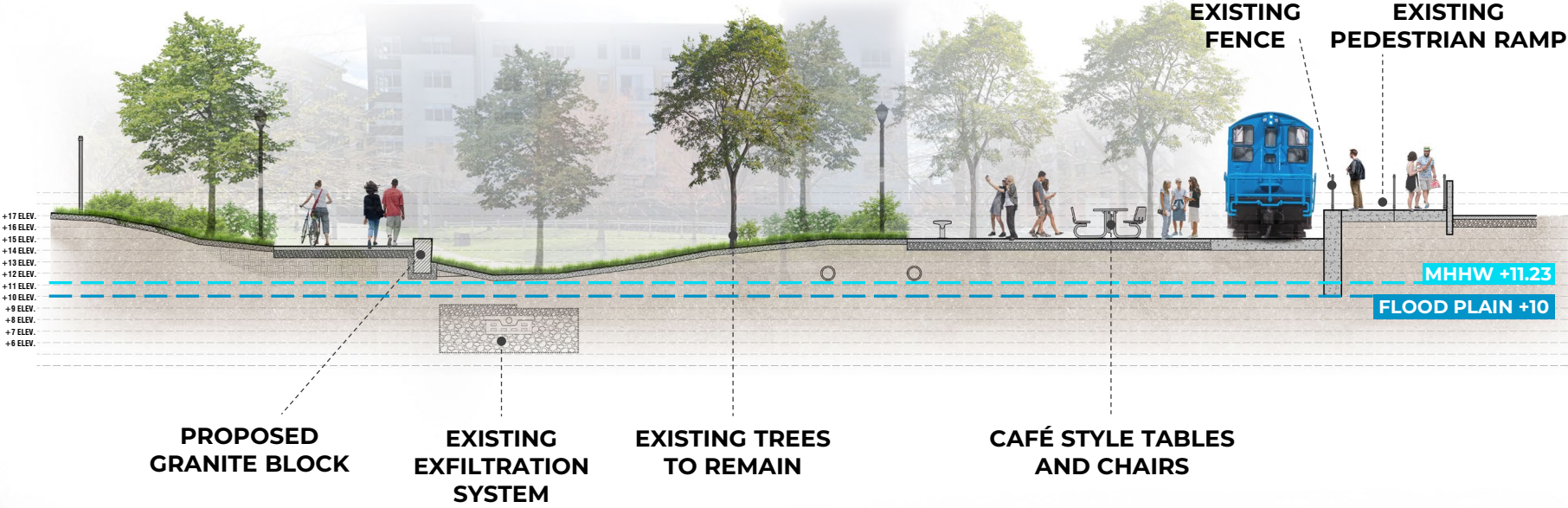

SUMNER STREET TO MAVERICK STREET



SUMNER STREET TO MAVERICK STREET

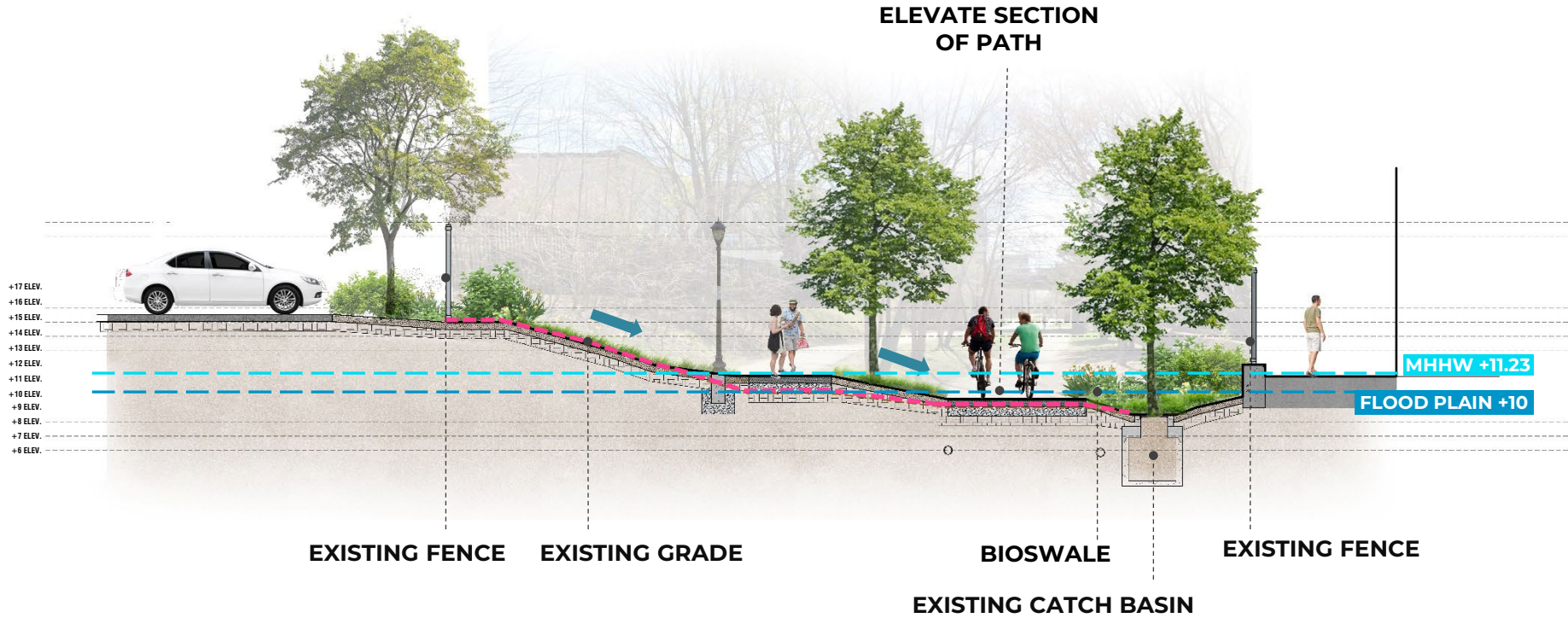

GOVE STREET

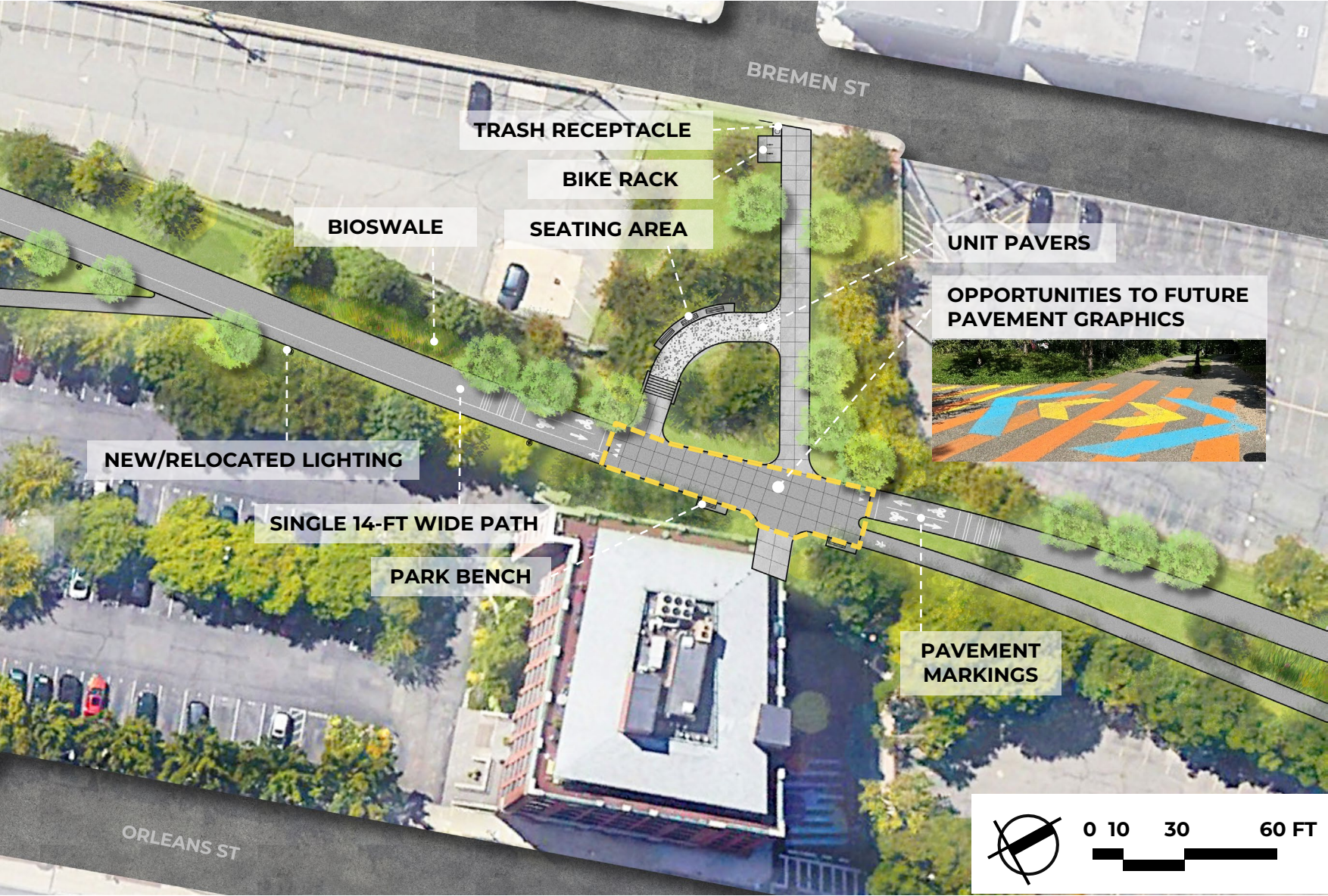

TRASH RECEPTACLE

BIKE RACK

BIOSWALE

SEATING AREA

UNIT PAVERS

OPPORTUNITIES TO FUTURE PAVEMENT GRAPHICS

NEW/RELOCATED LIGHTING

SINGLE 14-FT WIDE PATH

PARK BENCH

PAVEMENT MARKINGS

ORLEANS ST

BREMEN ST

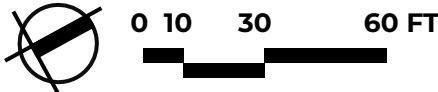

GOVE STREET

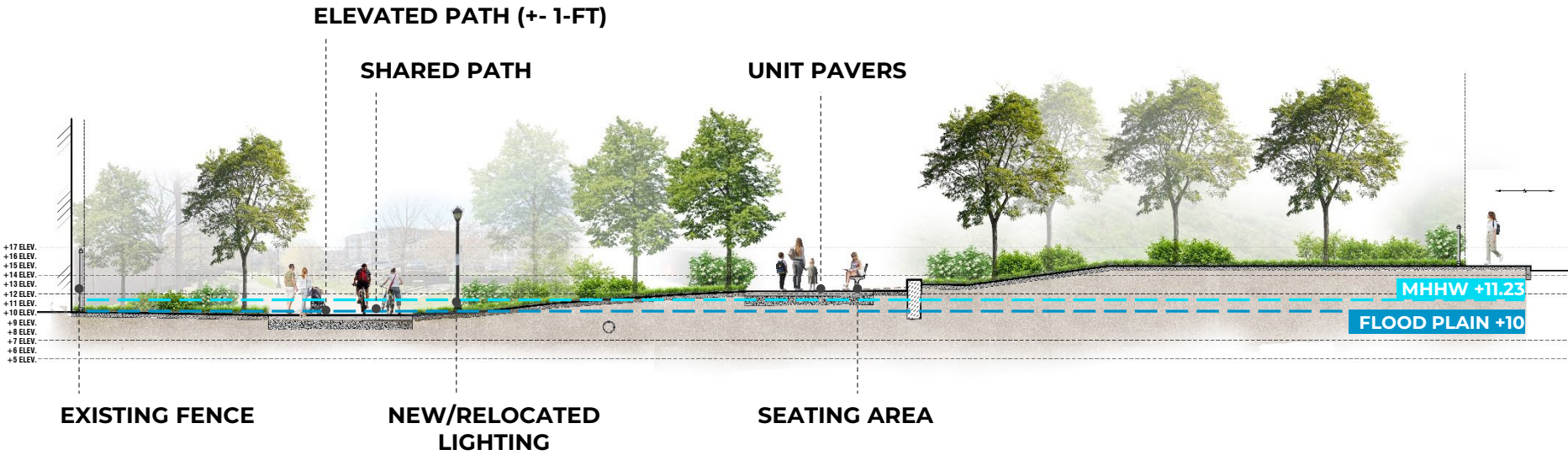
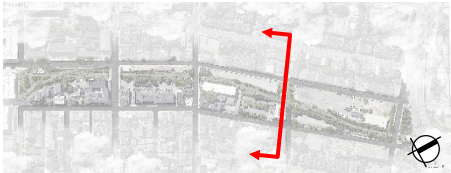

GOVE STREET TO PORTER STREET

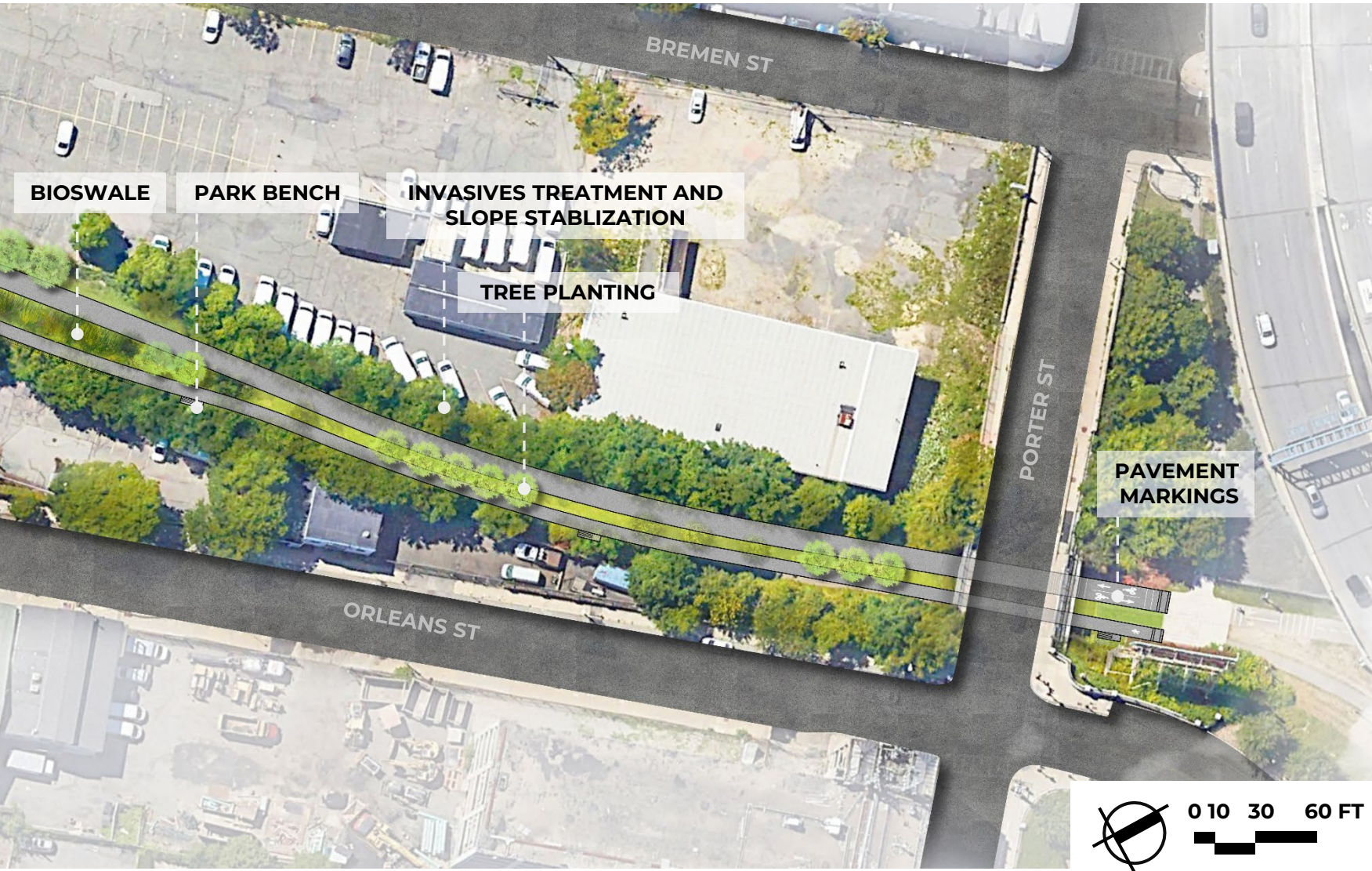



NEXT STEPS

Help us build great parks.
Let us know what matters to you.



THANK YOU!

For questions, maintenance requests or concerns regarding any of our parks contact 311



www.boston.gov/welch-greenway

Amy Linné:
amy.linne@boston.gov

October 08, 2024
Boston Parks and Recreation



EXISTING CONDITIONS

HISTORIC PLAN OF EAST BOSTON

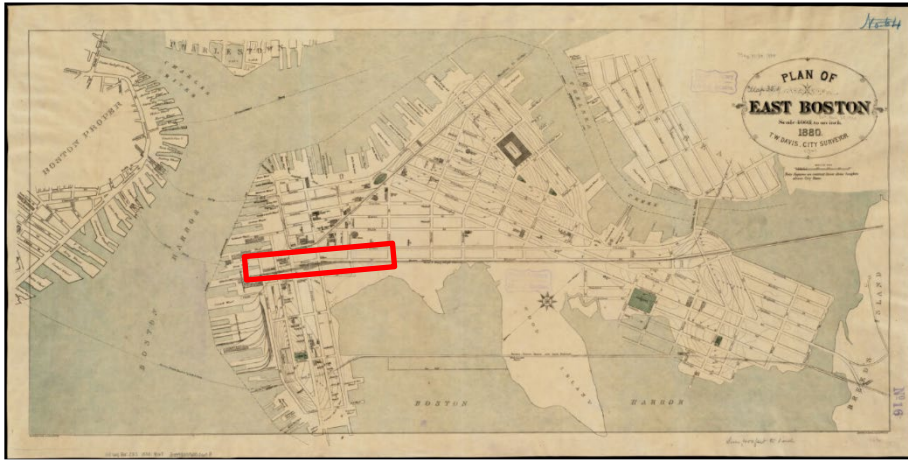

<https://collections.leventhalmap.org/search/commonwealth:1544f5823>

FLOOD MAP



USGS The National Map: Orthoimagery. Data refreshed December, 2021.

GROUNDWATER CONDITIONS

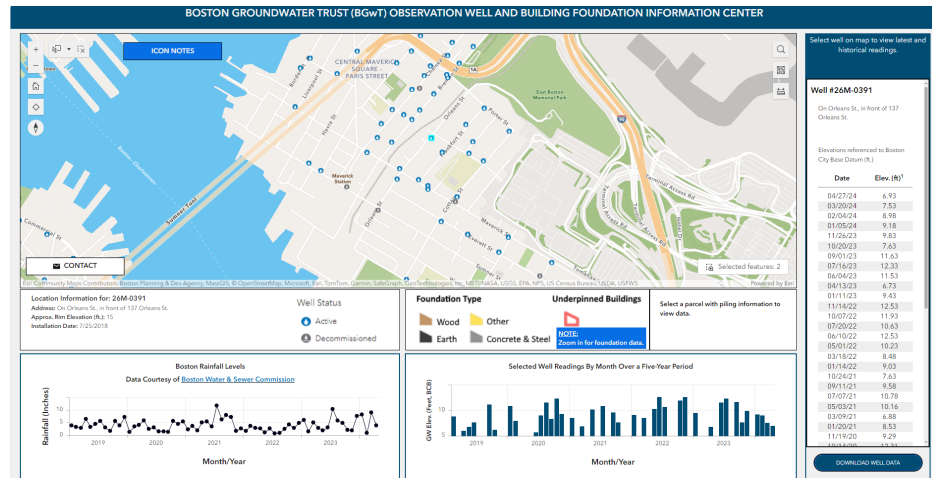

SITE HISTORY



PLAN OF EAST BOSTON

<https://collections.leventhalmap.org/search/commonwealth:1544f5823>

FLOOD MAP



USGS The National Map: Orthoimagery. Data refreshed December, 2021.

<p>PIN</p>	<p>Approximate location based on user input and does not represent an authoritative property location</p>	<p>SPECIAL FLOOD HAZARD AREAS</p>	<p>Without Base Flood Elevation (BFE) <i>Zone A, V, AE, AR</i></p> <p>With BFE or Depth</p> <p>Regulatory Floodway <i>Zone AE, AO, AH, VE, AR</i></p>		<p>OTHER AREAS OF FLOOD HAZARD</p> <p>0.2% Annual Chance Flood Hazard, Areas of 1% annual chance flood with average depth less than one foot or with drainage areas of less than one square mile <i>Zone X</i></p> <p>Future Conditions 1% Annual Chance Flood Hazard <i>Zone X</i></p> <p>Area with Reduced Flood Risk due to Levee. See Notes, <i>Zone X</i></p> <p>Area with Flood Risk due to Levee <i>Zone D</i></p>	<p>CROSS SECTIONS</p> <p> 20.2 Cross Sections with 1% Annual Chance Water Surface Elevation</p> <p> Coastal Transect</p> <p> Base Flood Elevation Line (BFE)</p> <p> Limit of Study</p> <p> Jurisdiction Boundary</p> <p> Coastal Transect Baseline</p> <p> Profile Baseline</p> <p> Hydrographic Feature</p> <p>OTHER FEATURES</p> <p> Channel, Culvert, or Storm Sewer</p> <p> Levee, Dike, or Floodwall</p>
<p>MAP PANELS</p>	<p> Selected FloodMap Boundary</p> <p> Digital Data Available</p> <p> No Digital Data Available</p> <p> Unmapped</p>					
<p>OTHER AREAS</p>	<p> Area of Minimal Flood Hazard <i>Zone X</i></p> <p> Effective LOMRs</p> <p> Area of Undetermined Flood Hazard <i>Zone D</i></p> <p> Otherwise Protected Area</p> <p> Coastal Barrier Resource System Area</p>					

GROUND WATER

BOSTON GROUNDWATER TRUST (BGwT) OBSERVATION WELL AND BUILDING FOUNDATION INFORMATION CENTER

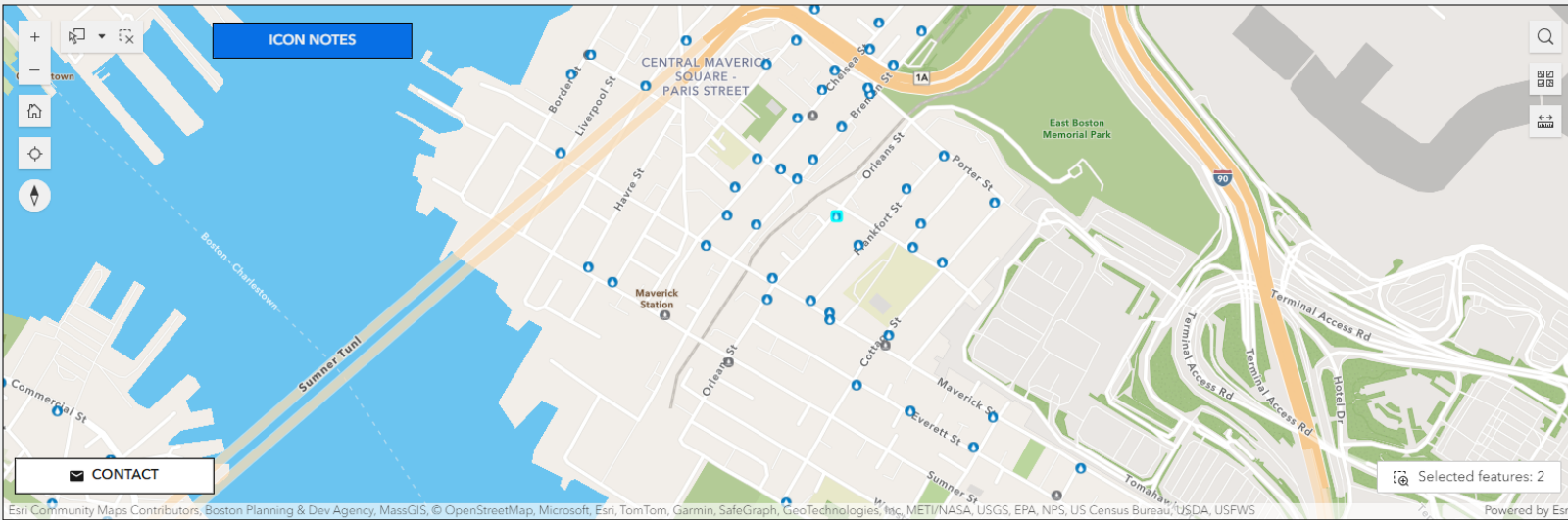

Select well on map to view latest and historical readings.

Well #26M-0391

On Orleans St., in front of 137 Orleans St.

Elevations referenced to Boston City Base Datum (ft.)

Date	Elev. (ft) ¹
04/27/24	6.93
03/20/24	7.53
02/04/24	8.98
01/05/24	9.18
11/26/23	9.83
10/20/23	7.63
09/01/23	11.63
07/16/23	12.33
06/04/23	11.53
04/13/23	6.73
01/11/23	9.43
11/14/22	12.53
10/07/22	11.93
07/20/22	10.63
06/10/22	12.53
05/01/22	10.23
03/18/22	8.48
01/14/22	9.03
10/24/21	7.63
09/11/21	9.58
07/07/21	10.78
05/03/21	10.16
03/09/21	6.88
01/20/21	8.53
11/19/20	9.29
10/11/20	12.31

DOWNLOAD WELL DATA

Location Information for: 26M-0391
 Address: On Orleans St., in front of 137 Orleans St.
 Approx. Rim Elevation (ft.): 15
 Installation Date: 7/25/2018

Well Status

- Active
- Decommissioned

Foundation Type

- Wood
- Other
- Earth
- Concrete & Steel

Underpinned Buildings

NOTE: Zoom in for foundation data.

Select a parcel with piling information to view data.

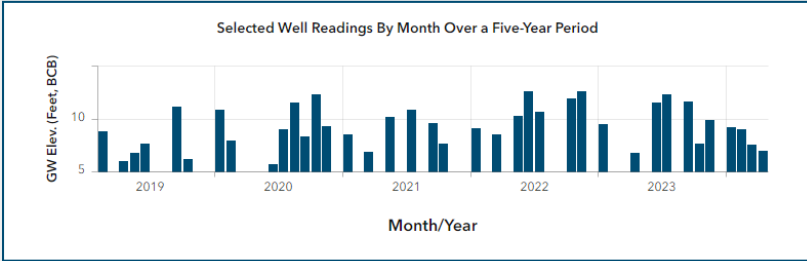
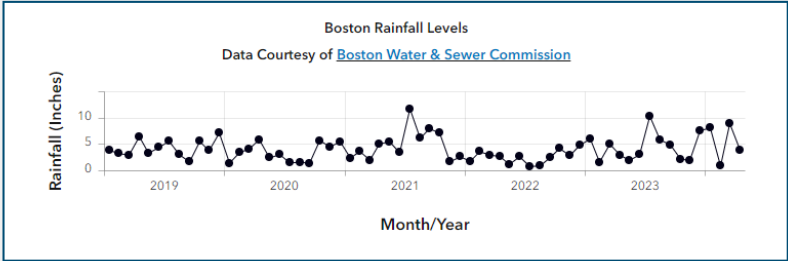

DRAINAGE & STORMWATER



GROUNDWATER
ELV. 9.20'

CATCH BASIN
ELV. 8.02'



DRAINAGE & STORMWATER

