

IRVING BUILDING RENOVATION/ PHILBRICK-SUMNER MERGER COMMUNITY MEETING

Monday, October 23, 2023 at 6:30 PM &
Wednesday, October 25, 2023 at 8:00 AM

Agenda

- Welcome and Introductions
- Recap
- Irving Renovation Update - PFD
- Addition-Renovation Visual Presentation - Mount Vernon Group
- Design Team Next Steps

GREEN NEW DEAL for BPS

Academics: High quality ethnically and culturally responsive curriculum, instruction and career pathways

Enrichment: Access to arts, sports, student government, and safe places to go before and after school

Facilities: Modern buildings with access to science labs, technology, libraries, gymnasiums, and performance, supportive and green spaces

Student & Family Supports: Resources for families so our students, families, and communities can thrive

COMMUNITY ENGAGEMENT & DECISION-MAKING SPECTRUM

INCREASING IMPACT ON THE DECISION 

	INFORM	CONSULT	INVOLVE	COLLABORATE	EMPOWER
PUBLIC PARTICIPATION GOAL	To provide the public with balanced and objective information to assist them in understanding the problem, alternatives, opportunities and/or solutions.	To obtain public feedback on analysis, alternatives and/or decisions.	To work directly with the public throughout the process to ensure that public concerns and aspirations are consistently understood and considered.	To partner with the public in each aspect of the decision including the development of alternatives and the identification of the preferred solution.	To place final decision making in the hands of the public.
PROMISE TO THE PUBLIC	We will keep you informed.	We will keep you informed, listen to and acknowledge concerns and aspirations, and provide feedback on how public input influenced the decision.	We will work with you to ensure that your concerns and aspirations are directly reflected in the alternatives developed and provide feedback on how public input influenced the decision.	We will look to you for advice and innovation in formulating solutions and incorporate your advice and recommendations into the decisions to the maximum extent possible.	We will implement what you decide.

PHILBRICK - SUMNER: **Where we've been**

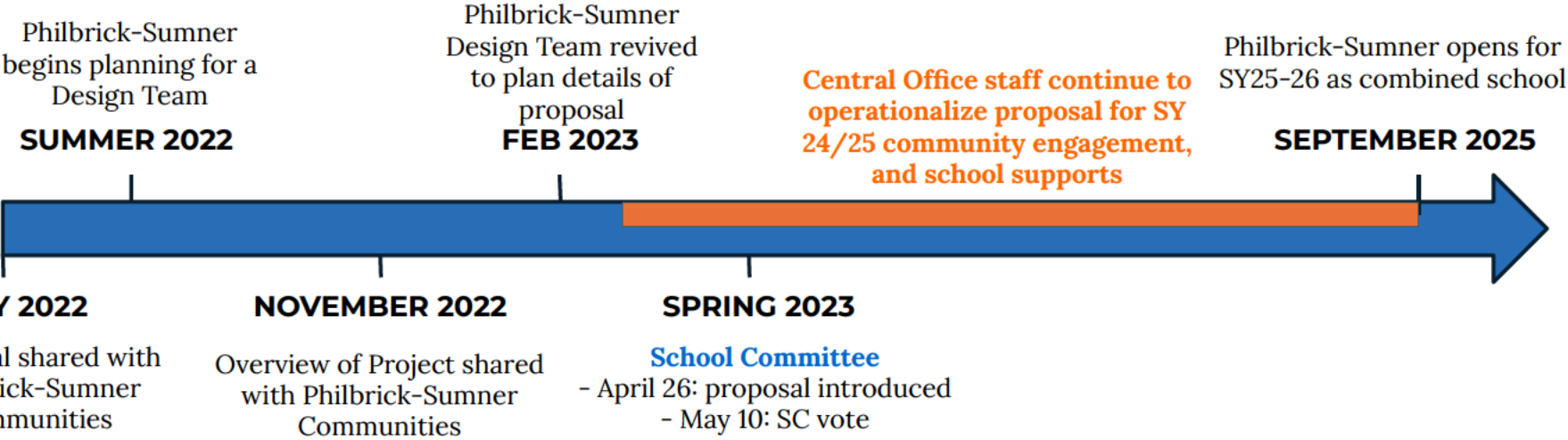

GROUNDING IN THE RACIAL EQUITY PLANNING TOOL

The **BPS Racial Equity Planning Tool (REPT)** lays out a clear six-step process to operationalize this commitment to ensure each decision we make is aimed at closing opportunity gaps and advancing racial equity.

BPS RACIAL EQUITY PLANNING TOOL COMPONENTS



PFD Journey

- Irving Middle School Feasibility Study - July 2022
- Irving Draft Schematic Design - October 2022
- Expected Construction Start - Summer of 2023
 - Including a temporary space construction on the first floor for SY23-24
- Projected Project Completion Date - Fall SY25-26

WHERE WE ARE NOW

UPDATED TIMELINE FROM PFD

IRVING SCHOOL RECONFIGURATION

Boston Public Facilities Department Project Team

Dion Irish, Chief of Operations

Kerrie Griffin, Director

Patrick Mulvey-Welsh, Assistant Director of Construction

Bill Evers, Project Manager

IRVING SCHOOL RECONFIGURATION

PHASE 1 – SWING SPACE PROJECT SCHEDULE

BIDDING AND CONTRACT

- Bids have been received
- Delay in awarding the project due to bid irregularity that required legal clarification
- Delay in executing the contract due to paperwork issues with contractor
- Contract executed

CONSTRUCTION

- Anticipated start of construction is mid-November
- Anticipated Substantial Completion – April 12, 2023
- Anticipated classroom relocation to Swing Space – April 15 through April 19, 2024

IRVING SCHOOL RECONFIGURATION

PHASE 2 – RENOVATION & ADDITION PROJECT SCHEDULE

BIDDING AND CONTRACT

- Contractor Prequalification Process complete
- Invitation to Bids issues first week of November
- Filed Sub Bids due 3rd week of November
- General Contractor Bids due 1st week of December
- Anticipated Contract Execution mid February

IRVING SCHOOL RECONFIGURATION

PHASE 2 – RENOVATION & ADDITION PROJECT SCHEDULE

CONSTRUCTION

- Estimated construction duration 16 months
- Contractor Pre Construction & Mobilization
 - Initial submittal packages including long lead items procurement February & March 2024
 - GC mobilize on site - April 2024
- Anticipated Substantial Completion of Addition and Upper Floors – February 14, 2025
- Anticipate relocation from Swing Space to Upper Floors during February Vacation 2025 – February 17 through February 21, 2025
- Anticipated start of renovations of Swing Space to final configuration - February 24, 2025
- Anticipated Substantial Completion – end of June 2025
- Anticipate start of BPS operations in completed Washington Irving School – July 2025
- Reconfigured Washington Irving School open to students – September 2025

Washington Irving Addition-Reno Visual Presentation

Mount Vernon Group Architects Project Team

Frank Tedesco, Principal

Dennis Daly, Design Principal

David Turcott, Associate

WASHINGTON IRVING

ADDITION-RENOVATION
PRESENTATION



New Addition Entry View - Main Project



New Entry Lobby View - Main Project



New North Addition View - Main Project



New Hawthorne St. Entry View - Main Project



New Entry Lobby – Interior View

Design Features:

- Art Wall
- Wood paneling at elevator shaft and at the coffered ceiling
- Grand light fixture with cove lighting



Flooring

1. New Terrazzo to match existing

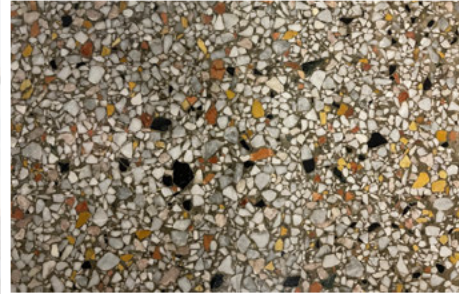

Typical Kindergarten Classroom, Lower Level – Interior Views



Typical Kindergarten Corridor, Lower Level – Interior View

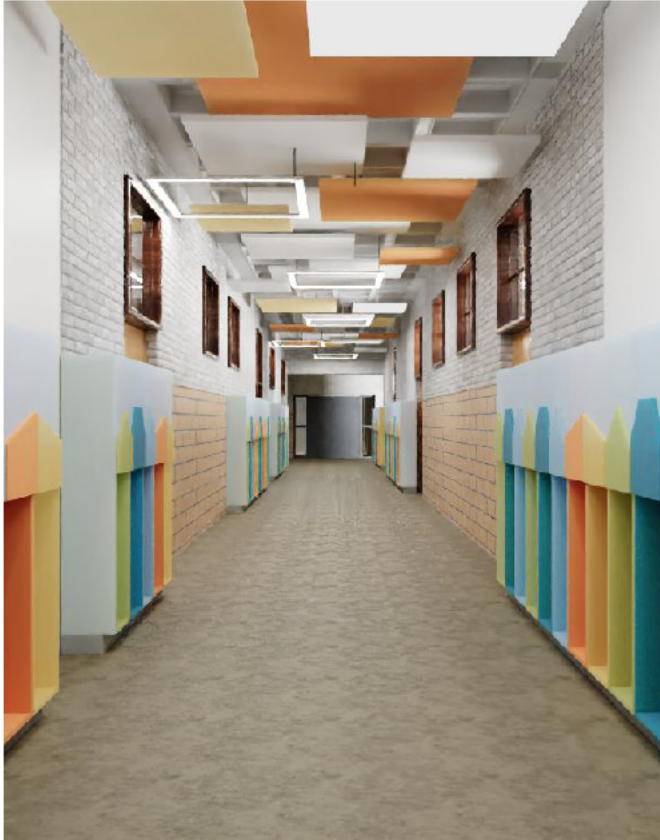

Flooring
Existing Terrazzo

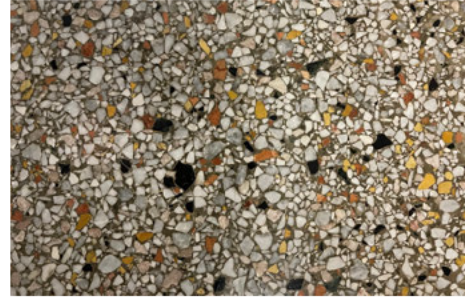

Design Features:

- Armstrong Tectum Acoustical Clouds
- Square halo lights, hollow and solid
- City skyline cubby concept

Typical Classroom, First Floor – Interior Views



Media Center, Second Floor – Interior Views



Administration, First Floor – Interior Views



Cafeteria, Lower Level - Interior Views



Next Steps

- **BPS Design Team Reconfiguration**

- Two Working Groups
 - Community Engagement
 - Academic and Programming Team

- **Launch Schedule for SY23-24**

- By End of November 2023
 - Working Group Meetings
 - Community Events

Community Engagement Focus

Bring Communities Together - Engagement Plan
Racial Equity Work
Renaming School

Academic and Programming Focus

Instruction and Inclusion
Budget and Staffing
Resource Allocation

Questions?

QUESTIONS?

Contact: capitalplanning@bostonpublicschools.org

THANK YOU!