

May 8, 2024

# WHITE STADIUM DESIGN COMMUNITY MEETING #2:

Revised Design Principles,  
Program, & Usage Needs

*Hosted by Public Facilities Department, Boston Public Schools, Boston  
Planning and Development Agency, and Boston Unity Soccer*

CITY of BOSTON

# Zoom Interpretation Services

## Spanish: Para traducción en Español,

1. Vaya a la parte baja de la pantalla, en la barra horizontal, y presione la tecla "Interpretation".
2. Luego seleccione el idioma que desea escuchar.
3. Después de seleccionar, usted entrará a la reunión en el idioma "Español".



## Haitian Creole: Pou entèpretasyon Kreyòl ayisyen,

1. Ale nan kontwòl ba nan pati anba ekran an epi Klike sou "Interpretation."
2. Apre sa, klike sou lang ke ou ta renmen tande a.
3. Kounye a ou gen aksè a reyinyon an Kreyòl ayisyen.



## Cabo Verdean Creole: Gossim bu ta entra na reuniao na kriolu,

1. Bai na barra de controlo horizontal na parte inferior di computador bu kalka na "Interpretation".
2. Depos kalka na idioma qui bu kre ovi.
3. Agora djabu sta ta entra na reuniaun em creole.



# COMMUNITY GUIDELINES

---



- For all participants:
  - **Maintain respect for others in this space.**
  - **Use “I” statements and share if you are representing a neighborhood association or group**
  - **Limit your comments to two minutes**
  - **Give and take air time.**
- For the project team:
  - We will collect and review your feedback from questions during discussion.
  - We will answer as many questions in the chat as we can.
  - If your comments are not addressed during the discussion, please reach us at [whitestadium@boston.gov](mailto:whitestadium@boston.gov)



# NEXT STEPS

---

## Upcoming Community Meetings

- **Advancing the Design:** A series of public meetings to advance a holistic stadium design responsive to past community feedback and Franklin Park Action Plan guidelines.
  - Design Meeting 1: April 25 ✓
  - Design Meeting 2: May 8 ✓
  - Design Meeting 3: May 22  **coming up!**
- **Article 80:** Review continues
  - IAG Meeting #2: May 15, focusing on transportation  **coming up!**
  - IAG Meeting #3: June 5, focusing on community benefits
- **Landmarks Commission Subcommittee:** Review continues, next meeting May 14
- **Boston Civic Design Commission (BCDC):** Review continues, next meeting May 21
- **Parks Commission:** Review continues





# AGENDA

---

## **Welcome & Introductions:**

**The City of Boston**  
Dion Irish, Chief of Operations

**Boston Unity Soccer Partners**, Jennifer Epstein, Controlling Manager

## **What we have heard:**

**The City of Boston Operations Cabinet**, Morgan McDaniel, Deputy Chief of Operations

## **White Stadium: Program & Scheduling**

**Boston Public Schools, Jones Architecture**  
Avery Esdaile, Senior Director of Athletics at the Boston Public Schools;  
Dan Ollila, Senior Associate at Jones Architecture

## **Guided Discussion**

**The Boston Planning and Development Agency (BPDA)**,  
Diana Fernandez, Deputy Chief of Urban Design for the BPDA

## **Design Considerations for White Stadium**

**Jones Architecture and Stantec Teams**  
Dan Ollila, Senior Associate at Jones Architecture  
Tamara Roy, Principal Architect at Stantec  
Christopher Bridle, Design Director of Landscape Architecture and Urban Design at Stantec  
JP Charboneau, Associate Principal at Crowley Cottrell Landscape Architecture

## **Question & Answer**

**Jones Architecture and Stantec Teams; and Diana Fernandez**

## **Next Steps**

**The City of Boston Operations Cabinet**, Morgan McDaniel, Deputy Chief of Operations



**B**

# WELCOME & INTRODUCTIONS





# WHITE STADIUM PROGRAM & SCHEDULING

# DESIGN WORKSHOP #1: WHAT WE HEARD

Range of feedback

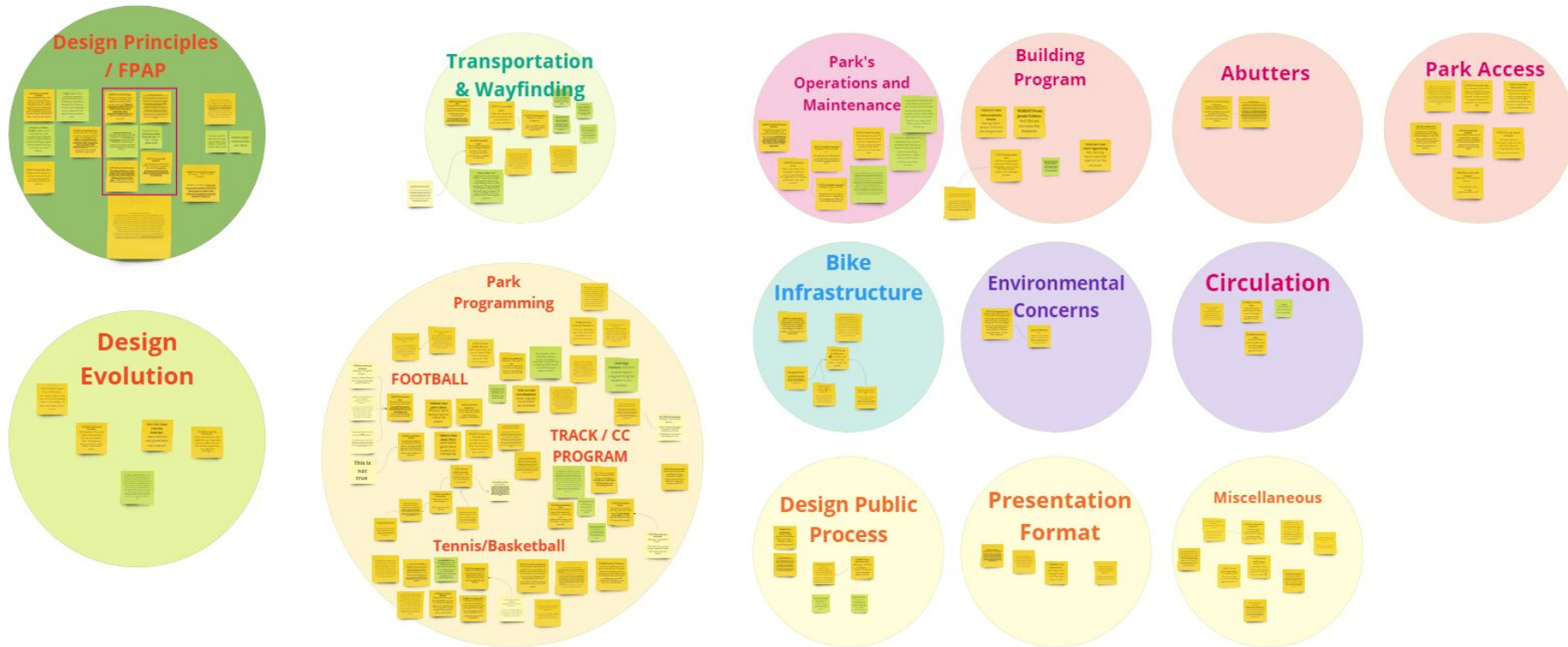



# FACILITIES CONDITIONS

What are the current East Grandstand conditions?

- Damaged by fire (date unknown)
- Used for minimal storage
- Little functional lighting
- Water damage
- Unsafe to occupy interior

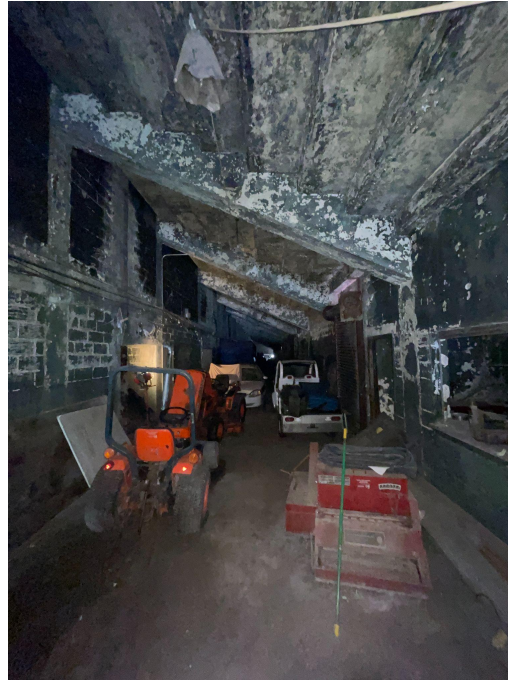

# FACILITIES CONDITIONS

## What are the current West Grandstand conditions?

### Locker Rooms (left)

- Not Accessible or up to code

### Athletic Equipment Storage (top center)

- On second level, difficult to move equipment

### Athletic Offices

- Poor heating & no AC / ventilation

### Concessions

- No working kitchen
- No food service or storage

### Grandstands (bottom right)

- Limited accessible seating
- Not up to current code
- Structural repairs needed from water damage (top right)
- Mechanical, electrical and plumbing code upgrades needed

**No Public Restrooms available on site**

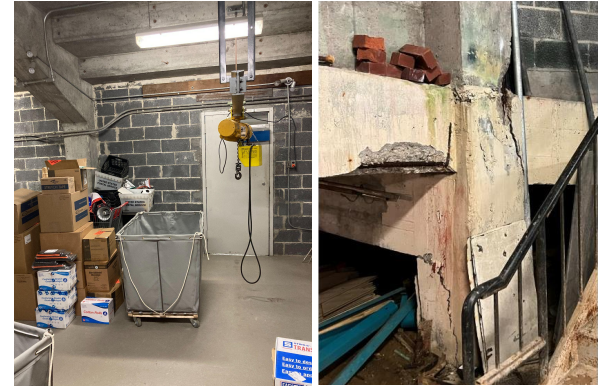



# FACILITIES CONDITIONS

What are the current external site conditions?



# BPS GOALS FOR WHITE STADIUM RENOVATION

Renovate & modernize the current athletics and administrative functions



Locker Rooms



Athletic  
Equipment  
Storage



BPS Athletic  
Offices



8-lane Track & Field



# BPS GOALS FOR WHITE STADIUM RENOVATION

Add program to serve the regional and community needs

- Participation in sports dropped from 44% in 2019 to 34% in 2021. Increasing sports participation is a major goal for BPS Athletics.
- How else could BPS Athletics program White Stadium to enhance district-wide programs?



Student Lounge / Resource



Strength & Conditioning Center



Sports Medicine Suite



Community Room



# PUBLIC-PRIVATE-COMMUNITY PARTNERSHIP

How does a partnership with Boston Unity Soccer help meet these community goals?

**A transformative opportunity for our community:**

- **Revitalize White Stadium** as a hub for sports and community events
- **Introduce Premium Natural Grass** for the best playing experience for student-athletes
- **Provide Dedicated, Professional Maintenance** to keep White Stadium and its surroundings safe and clean
- **Change the Narrative** by setting a new standard of sports facilities for student-athletes in the City of Boston, matching or exceeding amenities more often seen in suburban schools





# PUBLIC-PRIVATE-COMMUNITY PARTNERSHIP

How does a partnership with Boston Unity Soccer help meet these community goals?

- **Boost Community Pride** and unity through the shared joy of sports
- **Create New Professional Pathways** for young people through mentorships, internships, and scholarships
- **Provide Role Models for Girls in Sport;** athletic participation is linked to higher grades, more self confidence, and less rule-breaking behavior for young girls and women.
- **Accelerate Implementation of the Franklin Park Action Plan**
- **Add Amenities to Support Other Large Events at Franklin Park**



# FUTURE BPS PROGRAMMING - WHITE STADIUM AND PLAYSTEAD

## Program Usage by Season

### Spring



SOCCER



TRACK &  
FIELD



BASKETBALL



TENNIS



COMMUNITY  
EVENTS



STRENGTH &  
CONDITIONING

### Summer



SOCCER



TRACK &  
FIELD



BASKETBALL



TENNIS



COMMUNITY  
EVENTS



STRENGTH &  
CONDITIONING



FOOTBALL

### Fall



STRENGTH &  
CONDITIONING



SOCCER



CROSS  
COUNTRY



FOOTBALL



COMMUNITY  
EVENTS



CHEER

### Winter



TRACK &  
FIELD



COMMUNITY  
EVENTS



STRENGTH &  
CONDITIONING



CHEER





# FUTURE WHITE STADIUM PROGRAMMING

## Sample Future Schedule in August

<10% of all available field hours.

- Community Events
- BPS Athletics
- Boston Unity Soccer
- BPRD Summer Camp

SUNDAY	MONDAY	TUESDAY	WEDNESDAY	THURSDAY	FRIDAY	SATURDAY
28	29	30	31	1	2	3
Puerto Rican Festival	BPRD Summer Camp	BPRD Summer Camp	BPRD Summer Camp	BPRD Summer Camp	BPRD Summer Camp	Special Olympics
	Summer Conditioning	Summer Conditioning	Summer Conditioning	Summer Conditioning	Summer Conditioning	Boston Unity Game
	Track & Field	Track & Field	Track & Field	Track & Field	Boston Unity Practice	
4	5	6	7	8	9	10
	BPRD Summer Camp	BPRD Summer Camp	BPRD Summer Camp	BPRD Summer Camp	BPRD Summer Camp	
	Summer Conditioning	Summer Conditioning	Summer Conditioning	Summer Conditioning	Summer Conditioning	
	Track & Field	Track & Field	Track & Field	Track & Field	Track & Field	
11	12	13	14	15	16	17
	BPRD Summer Camp	BPRD Summer Camp	BPRD Summer Camp	BPRD Summer Camp	BPRD Summer Camp	NCAA X Country meet
	Summer Conditioning	Summer Conditioning	Summer Conditioning	Summer Conditioning	Summer Conditioning	Boston Unity Game
	Track & Field	Track & Field	Track & Field	Track & Field	Boston Unity Practice	
18	19	20	21	22	23	24
Caribbean Kiddie Festival	BPRD Summer Camp	BPRD Summer Camp	BPRD Summer Camp	BPRD Summer Camp	BPRD Summer Camp	
	Summer Conditioning	Summer Conditioning	Summer Conditioning	Summer Conditioning	Summer Conditioning	
	Track & Field	Track & Field	Track & Field	Track & Field	Track & Field	
25	26	27	28	29	30	31
	Cheerleading Practice	Cheerleading Practice	Cheerleading Practice	Cheerleading Practice	Cross Country Practice	Track & Field practice
	Cross Country Practice	Cross Country Practice	Cross Country Practice	Cross Country Practice	Soccer Practice	Boston Unity Game
	Soccer Game	Soccer Practice	Soccer Practice	Soccer Practice	Boston Unity Practice	

# WHITE STADIUM SAMPLE WEEKLY SCHEDULE - FALL

Expanded Access & Usage (NWSL game week)

Current Public Access:  
Weekdays 8 am - 4 pm

- BPS Sports
- Boston Unity Soccer
- Community Events

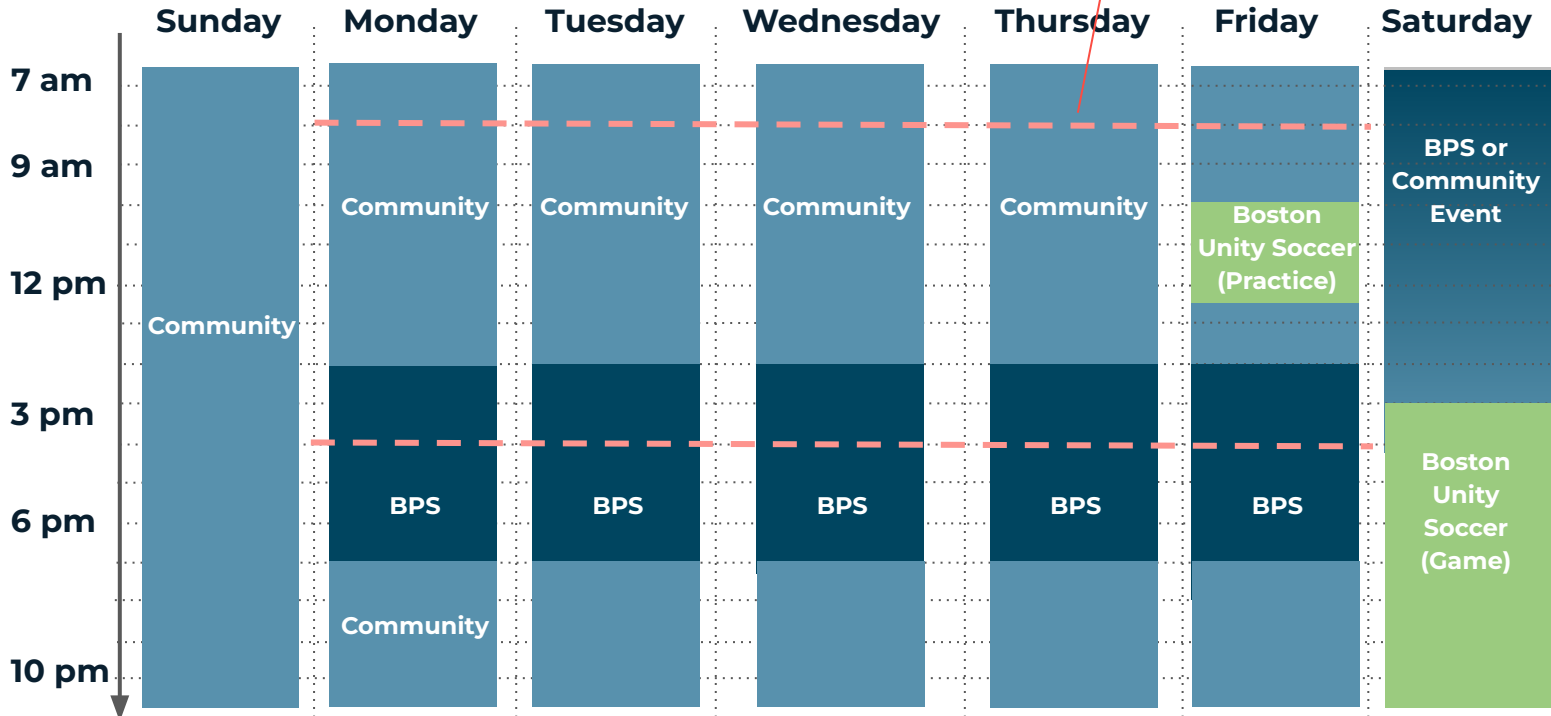

**90%**  
Community + BPS hours in an average week with a soccer game



# WHITE STADIUM SAMPLE WEEKLY SCHEDULE - SPRING

Expanded Access & Usage (Non-NWSL game week)

Current Public Access:  
Weekdays 8 am - 4 pm

- BPS Sports
- Boston Unity Soccer
- Community Events

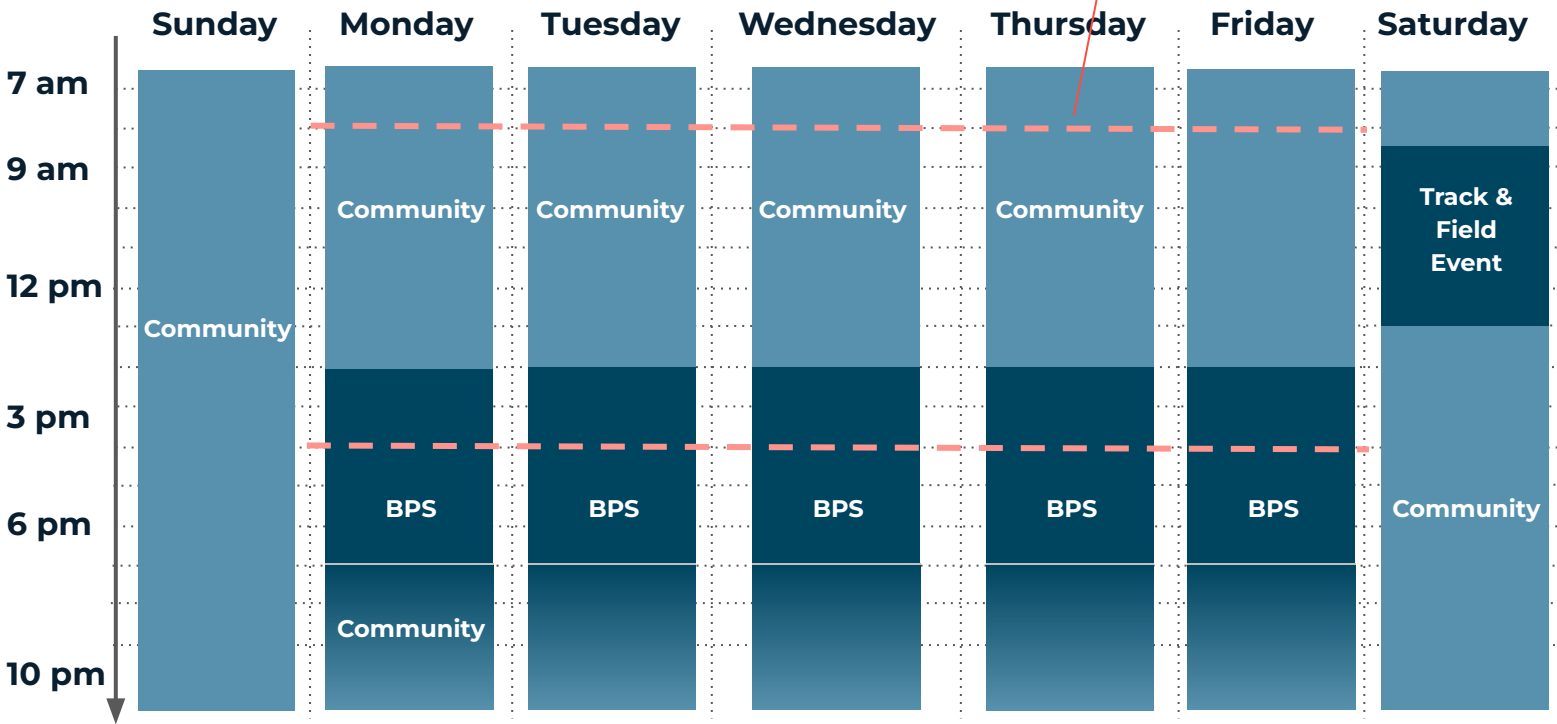

**100%**  
Community + BPS hours in an average week without a soccer game



**B**

# GUIDED DISCUSSION



slido



What feedback do you have for us as we develop the final seasonal, weekly, or hourly programming schedule for White Stadium?

① Click **Present with Slido** or install our [Chrome extension](#) to activate this poll while presenting.

slido



What types of events or programs do you believe would best serve the diverse needs and interests of our community at the newly renovated stadium and playstead area?

① Click **Present with Slido** or install our [Chrome extension](#) to activate this poll while presenting.

slido

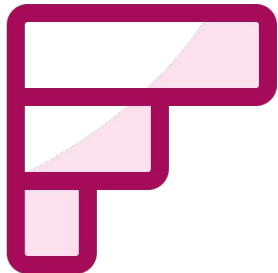

1. What are the top/ favorite activities you anticipate participating in within the newly renovated stadium and the expanded Playstead area? Please rank your top 3 activities:

① Click **Present with Slido** or install our [Chrome extension](#) to activate this poll while presenting.



# DESIGN CONSIDERATIONS

For White Stadium Program



# INCORPORATED COMMUNITY FEEDBACK INTO DESIGN

1. Reduced the width of the West Grandstand
2. Reduced the size of the field
3. Removed the bean building in The Grove
4. Protected the character defining elements
5. Reduced pavement in The Grove and aligned pathway system with FPAP recommendations
6. Removed vehicles from Playstead Road
7. Consolidated program into wings
8. Moved scoreboard away from The Playstead
9. Replaced permanent fencing around The Grove with temporary fencing infrastructure
10. Embraced holistic design to include cross functional use of East and West Grandstands
11. Maintained and introduced new 8 lane track and created new field sports opportunities



# WHITE STADIUM VIDEO

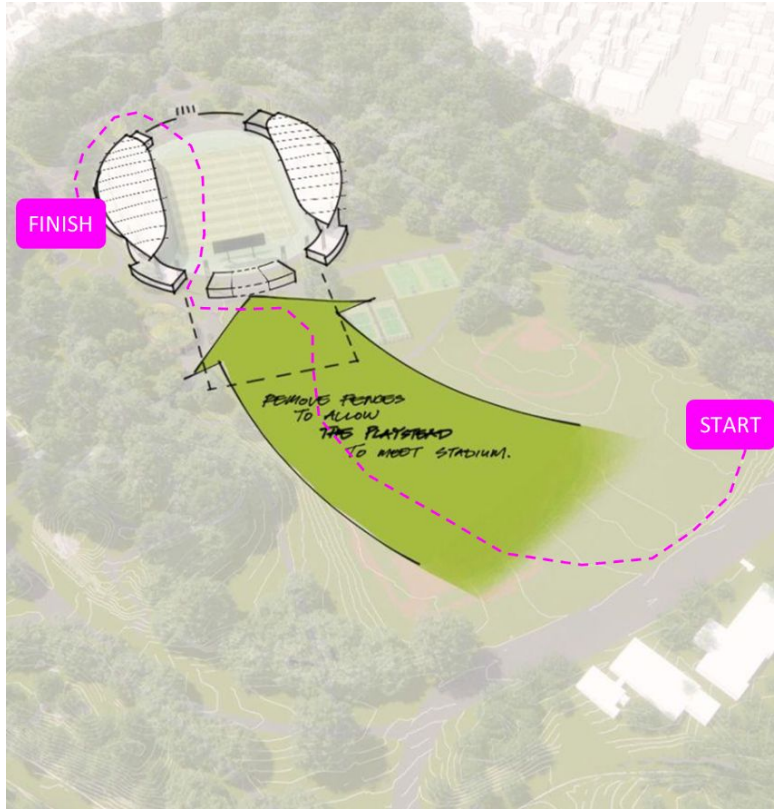



# DESIGN CONSIDERATION #1

How to make a coordinated, consolidated stadium

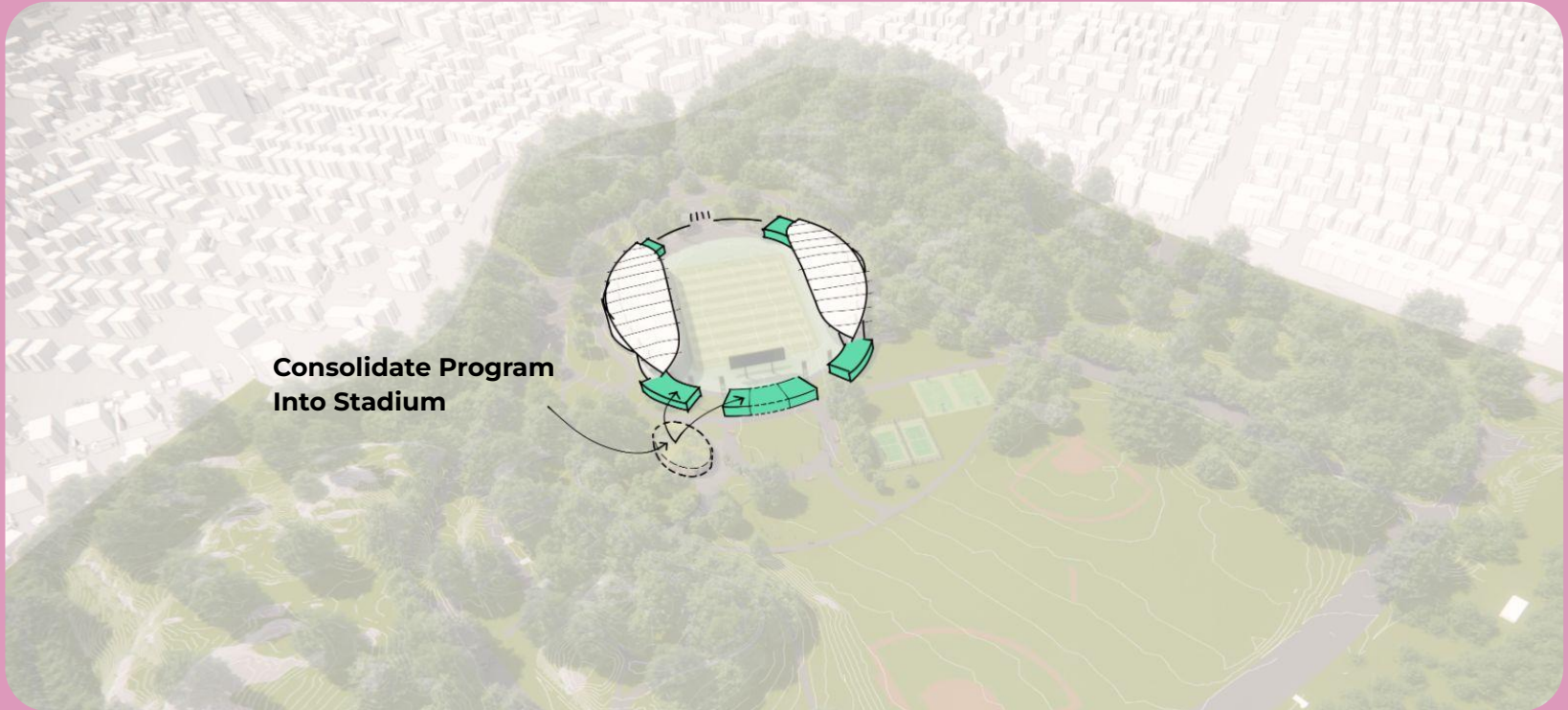

# DESIGN PROGRAM

## Stadium Architecture - Character Defining Elements



North Entry Pillars

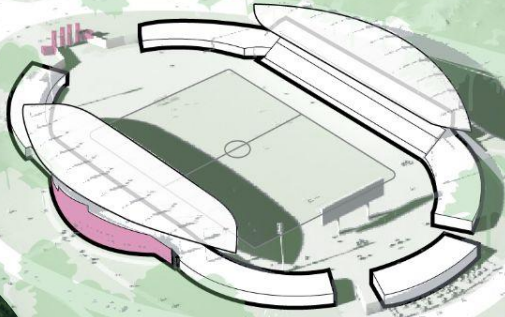

West Clamshell Wall





# DESIGN PROGRAM

## Stadium Architecture - Approach to Building Form

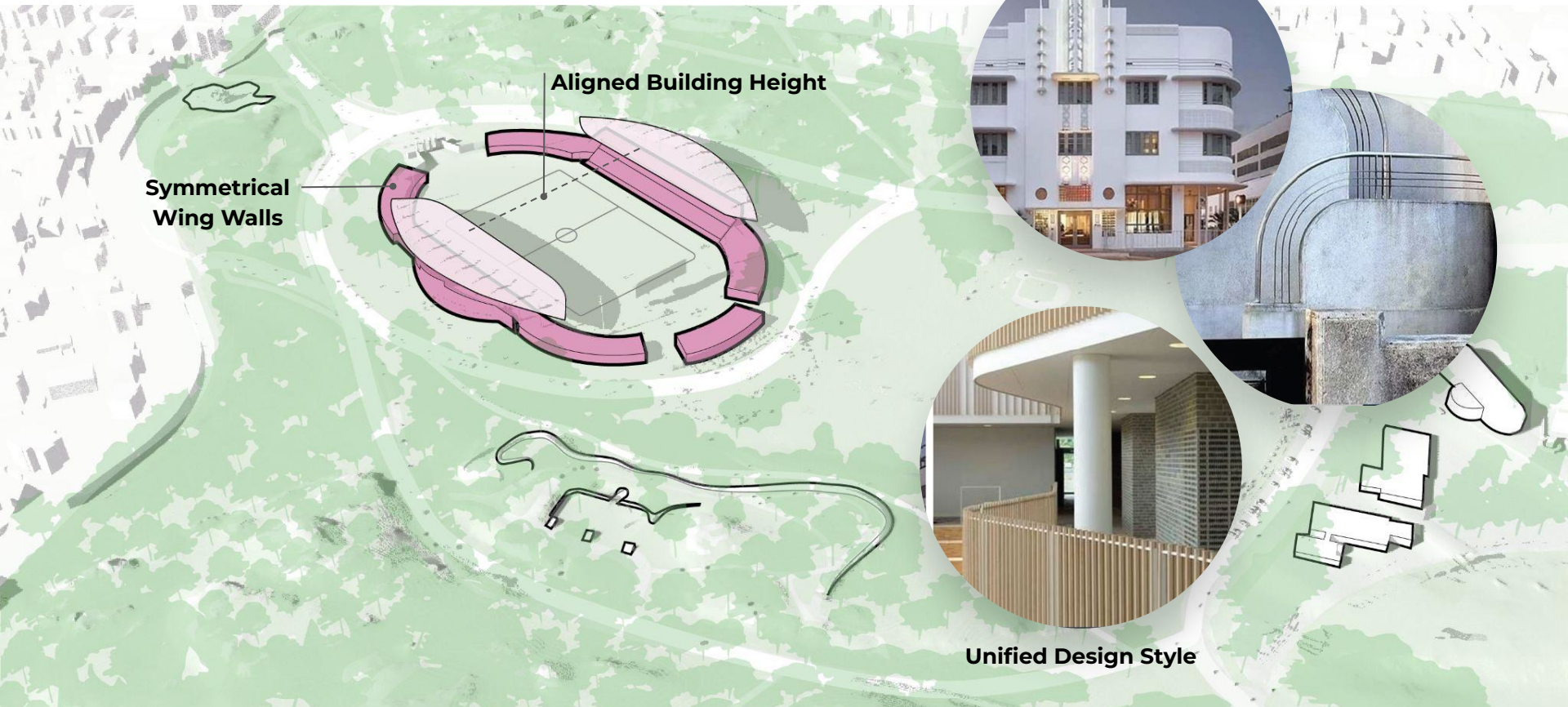

Symmetrical Wing Walls

Aligned Building Height

Unified Design Style

# DESIGN PROGRAM

## Stadium Architecture - BPS Building Program



**BPS Offices & Student Resource**  
8,000 sf

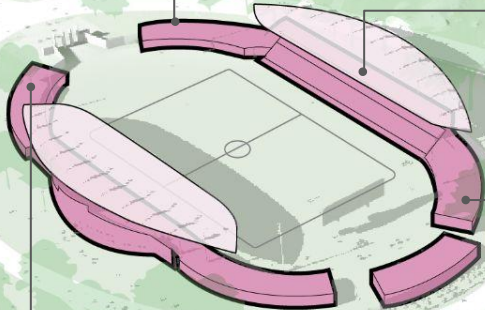

**Community Room Overlooking Field**  
1,500 sf



**Locker Rooms Under Grandstand**  
8,000 sf



**Athletic Equipment Storage & Distribution** 4,700 sf



**Strength & Conditioning and Sport Medicine Suite** 7,850 sf





# DESIGN PROGRAM

## Stadium Architecture - BUSP Building Program



**Locker Rooms**

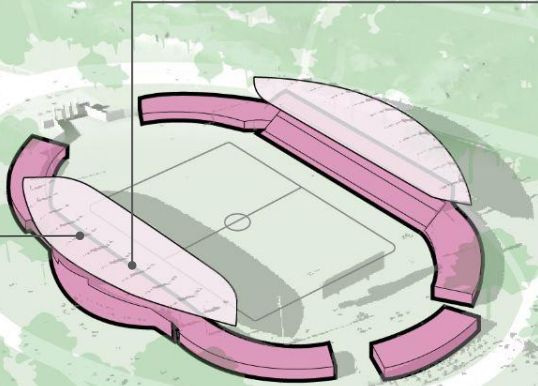

**Bucket Seats**



**Concessions & Restrooms**



**Press Box**



**Suites**

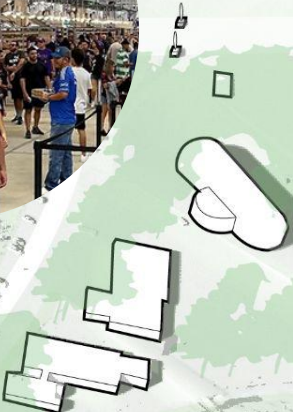

# DESIGN PROGRAM

Ground floor plan utilizes space below grandstands and positions BPS program with BUSP program where efficient.

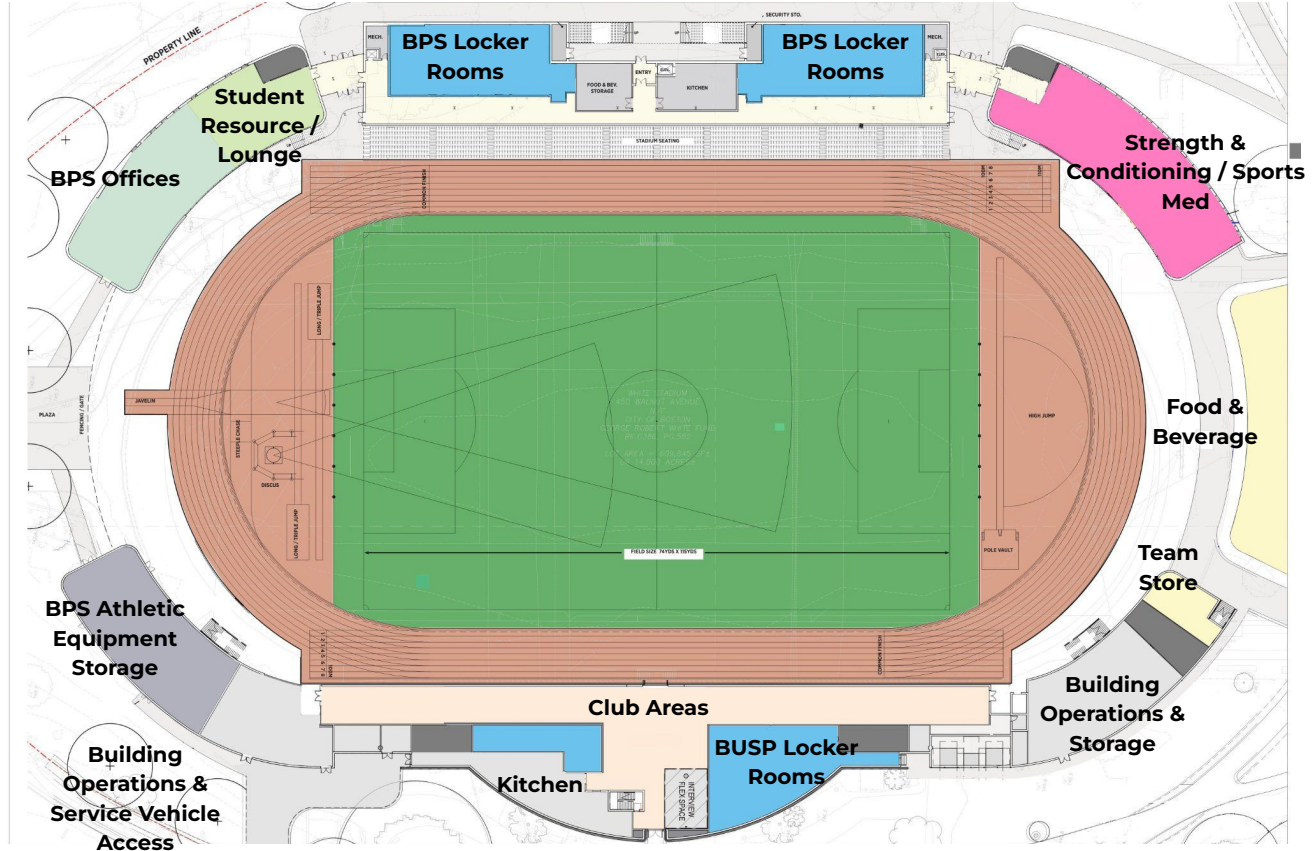



## DESIGN CONSIDERATION #2

Create a multifunctional sports facility

**Stadium / Publicly  
Accessible Sport**

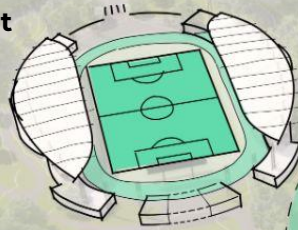

**BPS /Publicly  
Accessible  
Sport**

*The Playstead is..."designed to be used for the athletic recreation and education of the city's schoolboys, for occasional civic ceremonies and exhibitions, and for any purpose likely to draw spectators in crowds".*

**- Frederick Law Olmsted**

# SPORT PROGRAM

BPS Sports: Football, Soccer, Track & Field

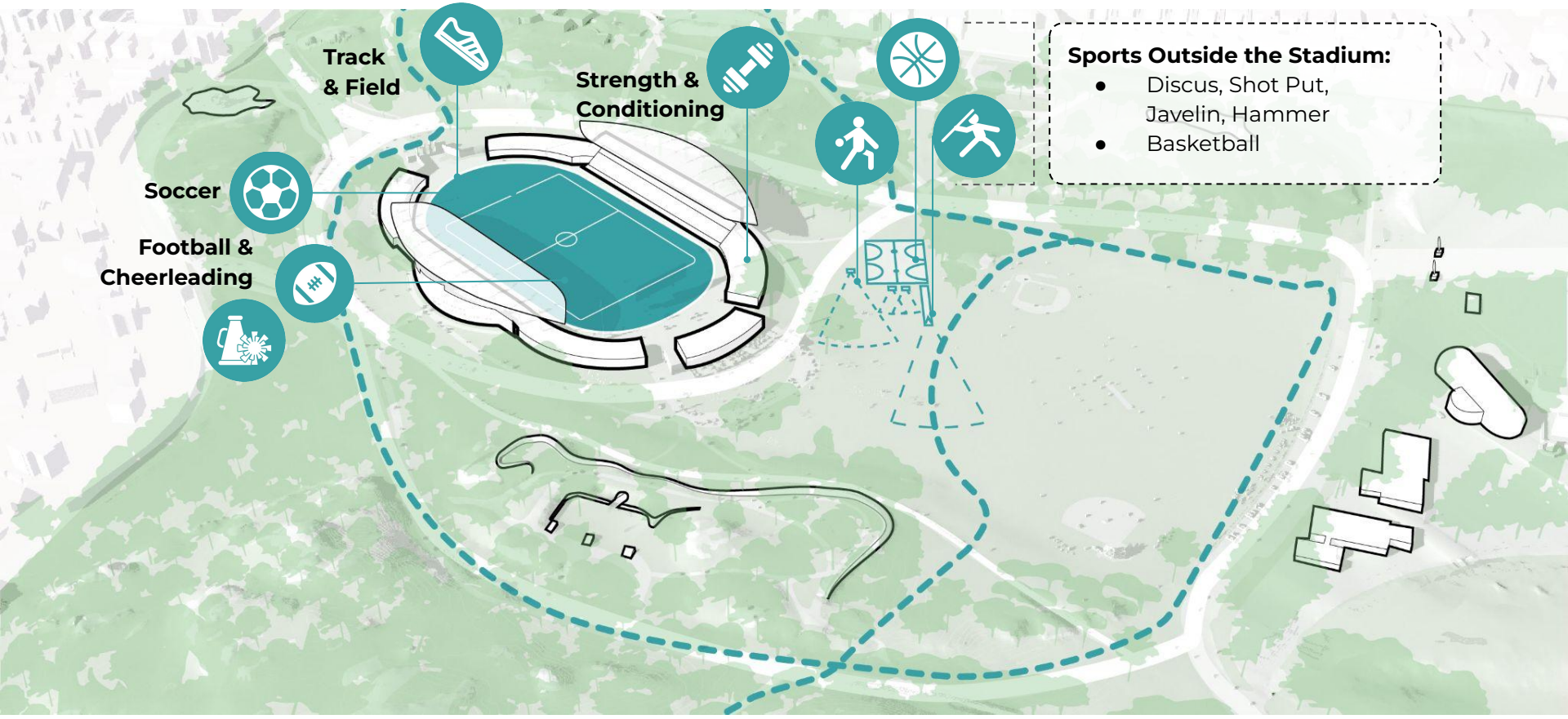



# SPORT PROGRAM

## Soccer Field



Soccer Field

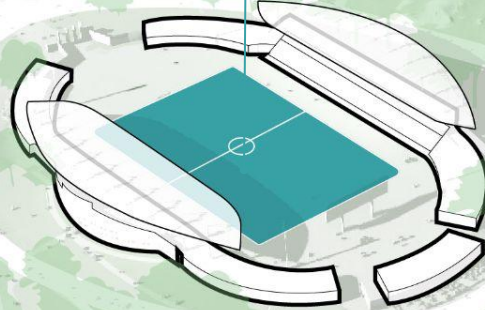

Provides enhanced playability on a professionally maintained regulation size grass field, setting a new standard for quality in the city.

# DESIGN CONSIDERATION

## Track & Field Size

Field of play 222' (74yds) x 345' (115yds) is regulation size

The new field will expand the width of the existing playing field by 10 yards (red dashed)

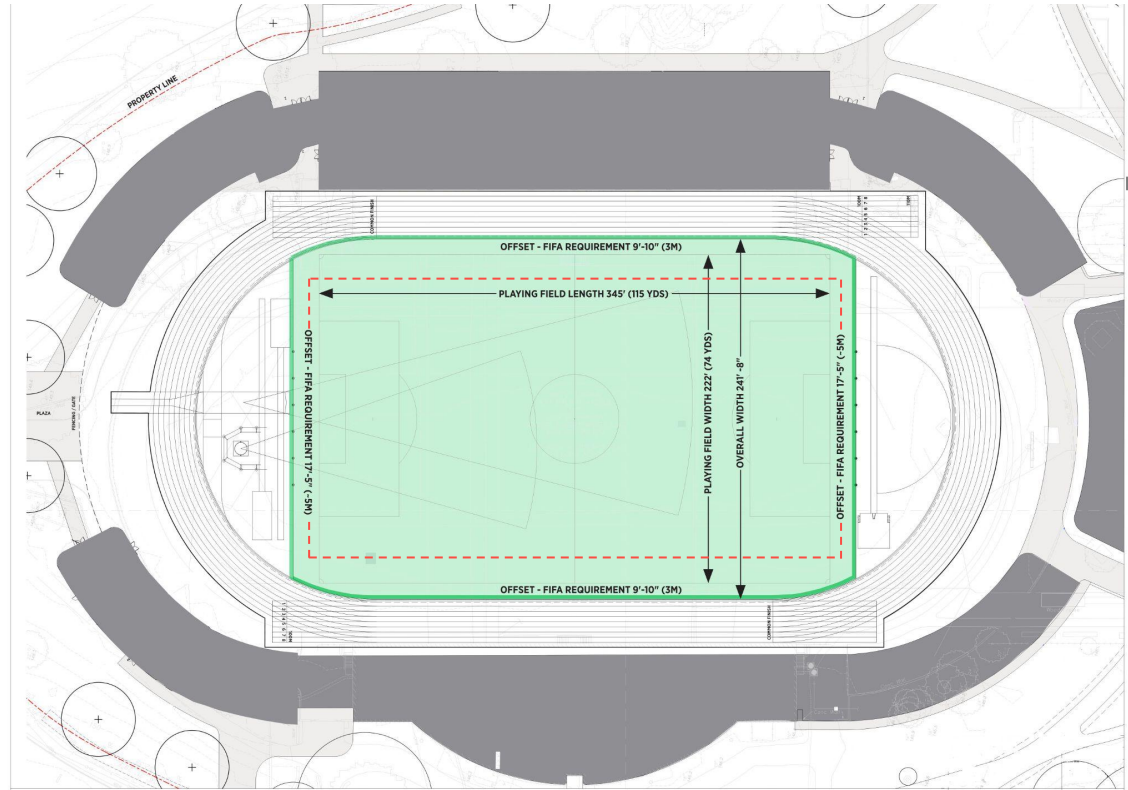



# DESIGN CONSIDERATION

## Track & Field Size

**8 Lane Track** around the field increases overall width to 308'  
The benefits of going to 8 lane w/ double straight lanes vs. 6 lane with single straight are:

- Can host **MIAA State Track Meets**
- More events can run simultaneously
- Shorter more efficient practices
- Potential to host **NCAA or US Track and Field events**

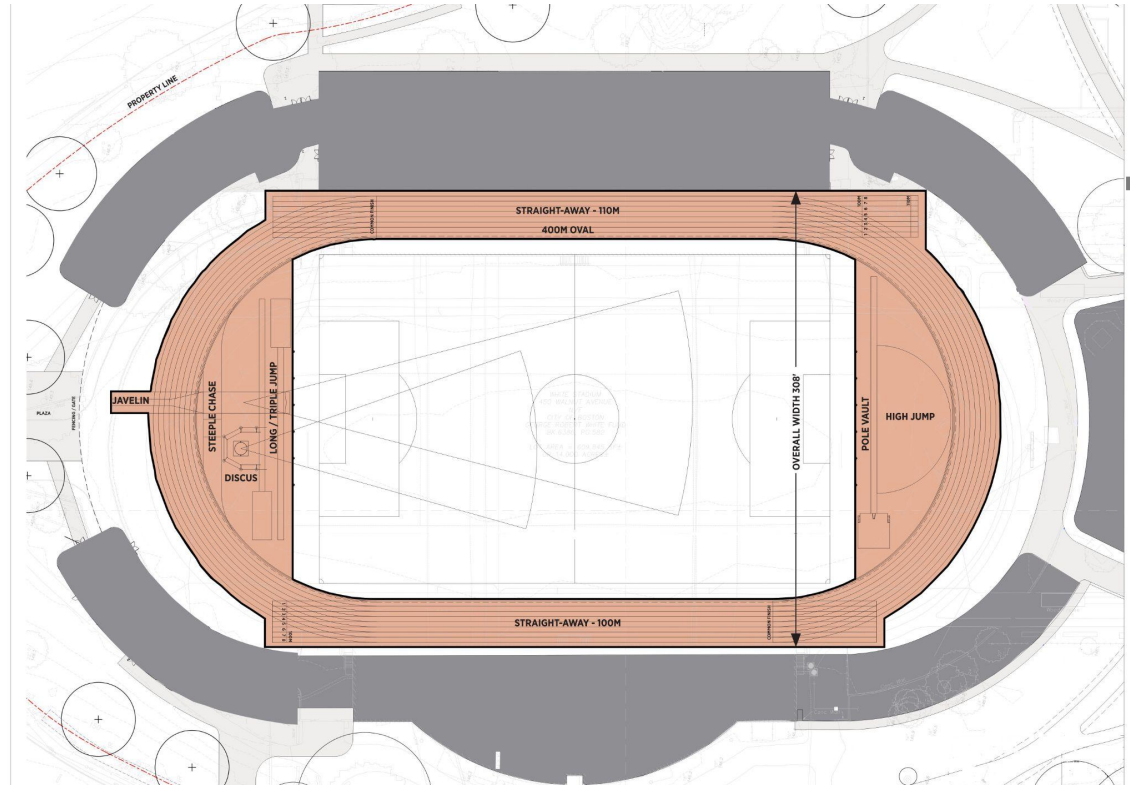

# SPORT PROGRAM

## Playstead sports

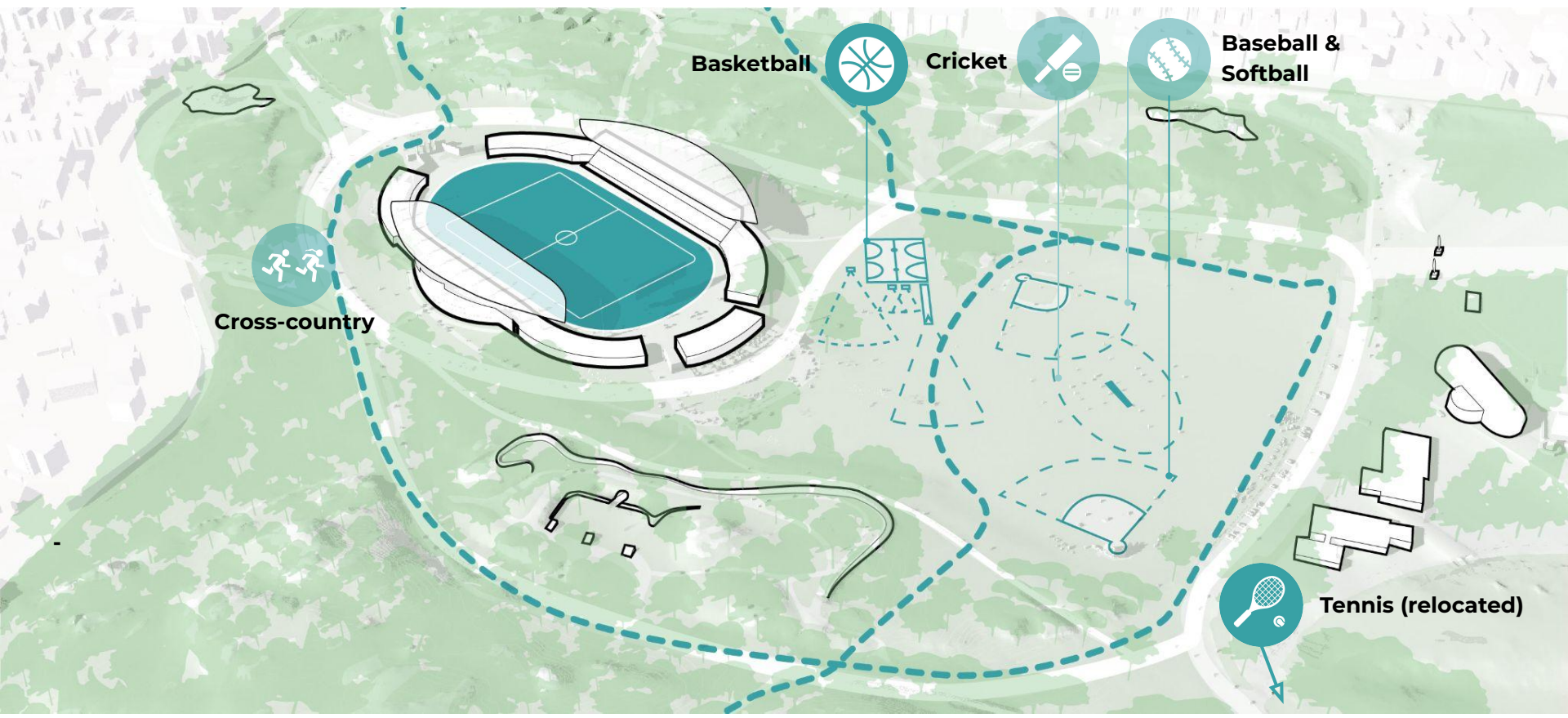

# SPORT PROGRAM

## Summary of Stadium and Playstead Competitive Sport Programming

### Sports Inside the Stadium:

- Track and Field
- Football
- Soccer

### Sports Outside the Stadium:

- Discus / Javelin / Hammer
- Basketball

### Playstead sports to remain:

- Cricket
- Softball
- Baseball
- Cross-country



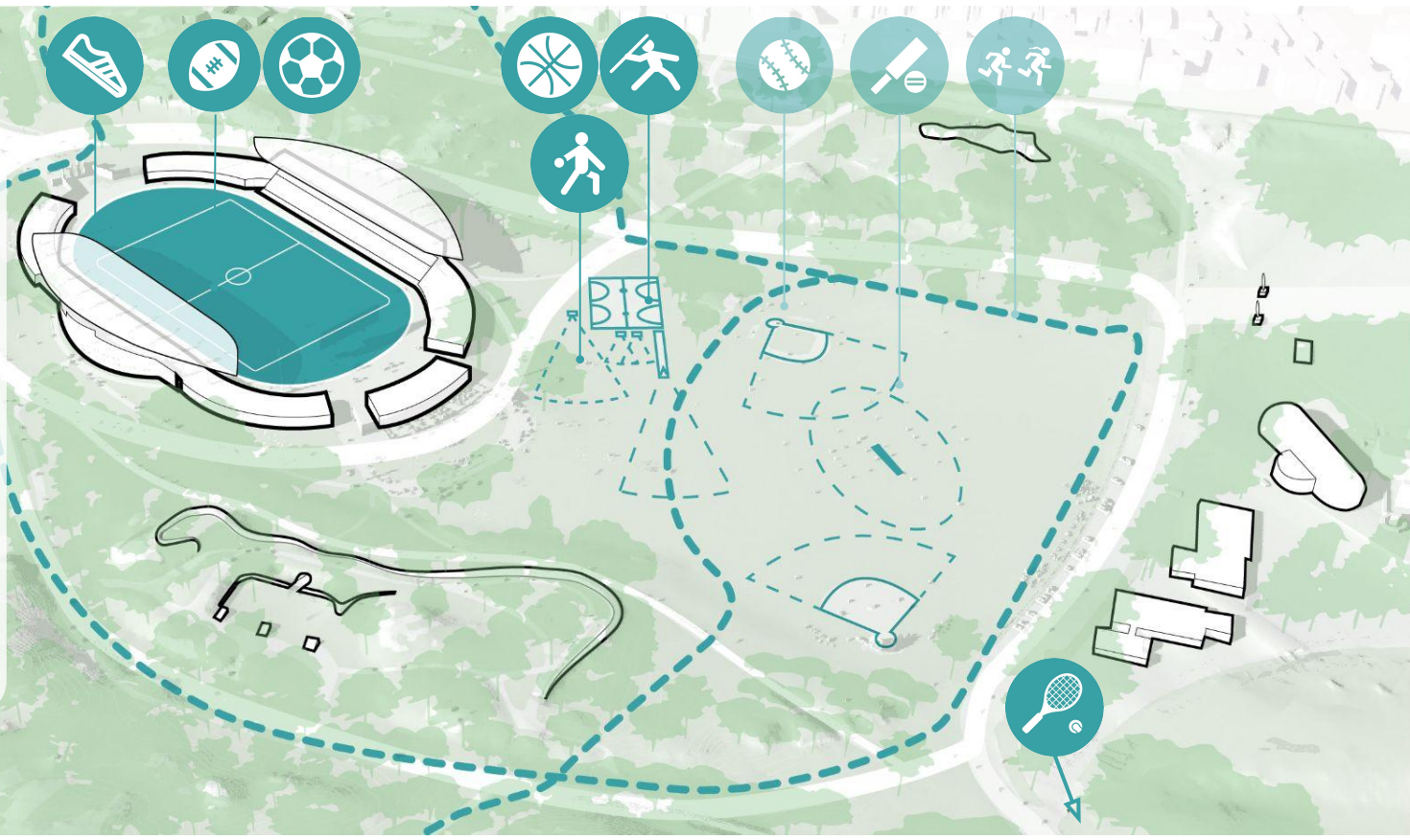

### Playstead sports relocated:

- Tennis





# ATHLETIC FACILITIES IN FRANKLIN PARKS

Program	Current	Proposed	Change
<b>TOTAL PROGRAMS</b>	<b>28</b>	<b>34</b>	 <b>+6</b>
<b>Baseball / Softball fields</b>	3	3	–
<b>Basketball courts</b>	2	2	–
<b>Multi-Purpose Field (Playstead)</b>	1	1	–
<b>Tennis courts</b>	4*	4	–
<b>Soccer fields</b>	1	1	–
<b>Football</b>	1	1*	–
<b>Strength and Conditioning</b>	0	1	 +1
<b>Track:</b> Straights	1	2	 +1
Quantity of Lanes	6	8	 +2
Distance - 400M Track	1	1	–
<b>Field:</b> Discus	1	1	–
Hammer	0	1	 +1
High Jump	1	1	–
Javelin	1	1	–
Long Jump / Triple Jump	2	2	–
Shot Put	2	2	–
Steeplechase	0	1	 +1
Pole Vault	1	1	–

B  
P  
S

\* See following slides



# FOOTBALL

- **BPS commits to giving every football team a home field.**
- Currently, BPS has 7 football teams:
  - 5 teams have home fields.
  - 2 teams (Boston Latin School and Boston Latin Academy) don't have home fields, & play 5 home games at White Stadium.
- After the renovation, all teams will:
  - have their own home fields
  - Have access to offseason training in the new strength and conditioning suite
  - have the opportunity to play at White Stadium end of season

# TENNIS

- Expansion from 2 → 4 **Tennis courts** at the Shattuck picnic grove as recommended in the Franklin Park Action Plan.
- Having 4 consolidated courts will improve efficiency and meet programming requests from the Franklin Park Tennis Association.
- Design work will begin this summer.



# DESIGN CONSIDERATION

Restore Visual & Physical Continuity

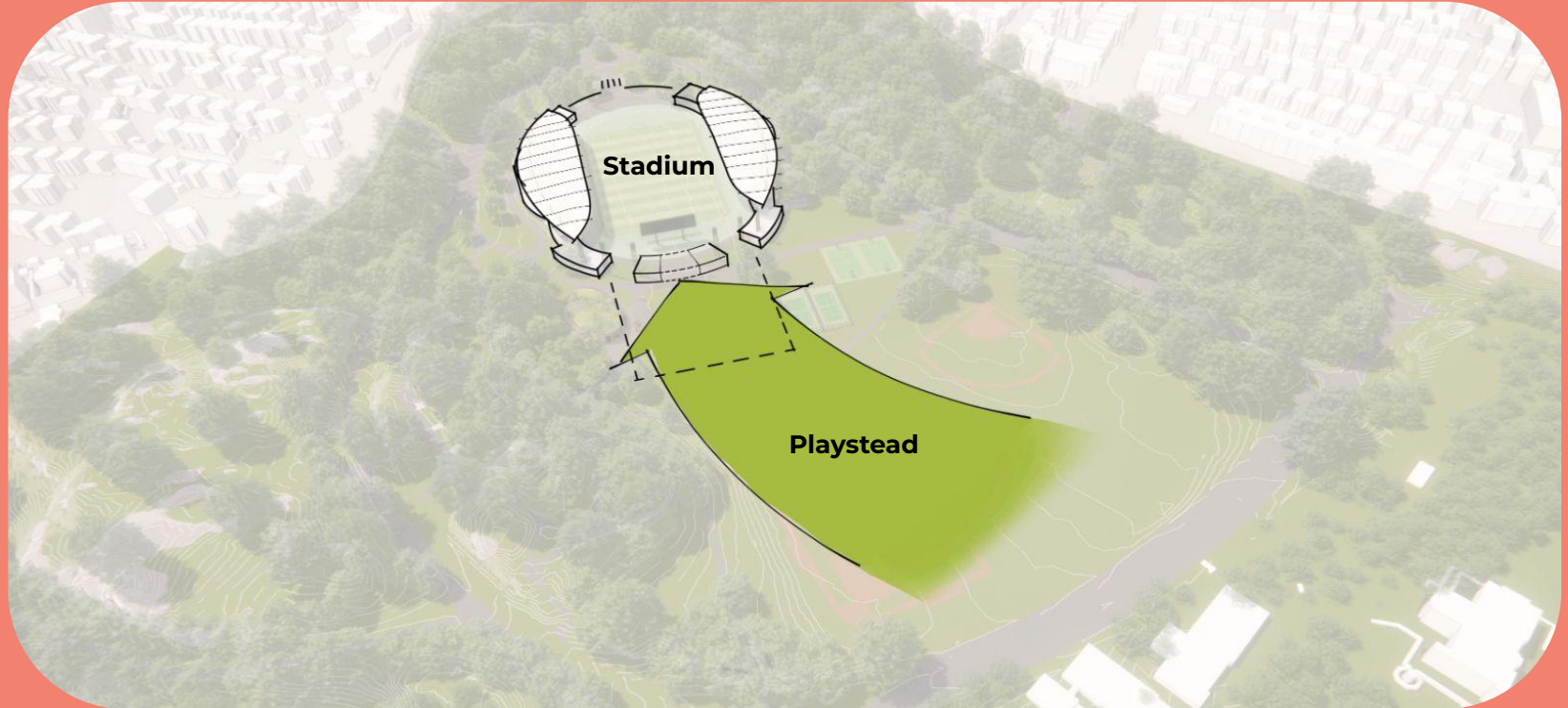

# DESIGN PROGRAM

## Character Defining Elements



**Puddingstone  
Outcroppings**



**Mature  
Tree Canopy**



**The Overlook**



**Critical  
Viewsheds**

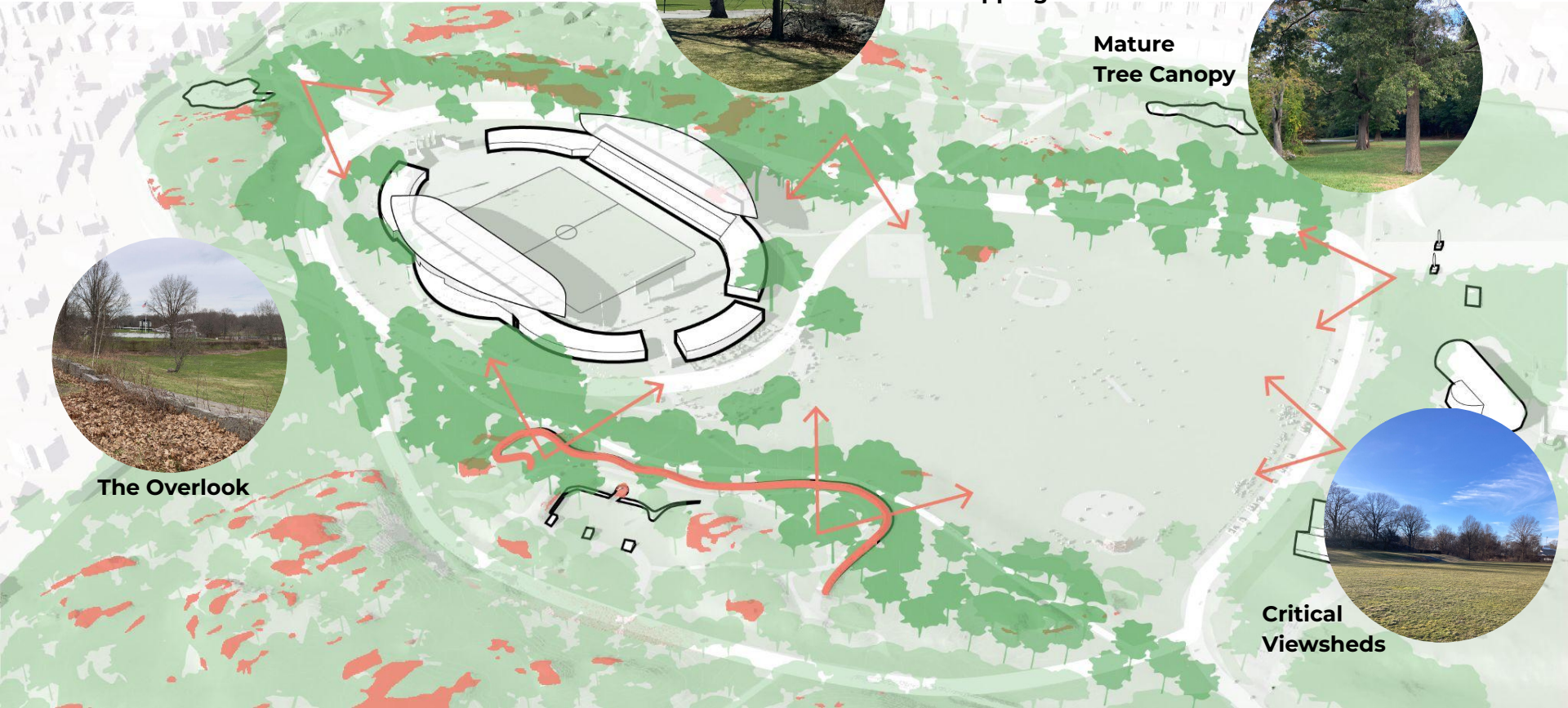



# DESIGN PROGRAM

## Balancing Stadium Program and Character Defining Features

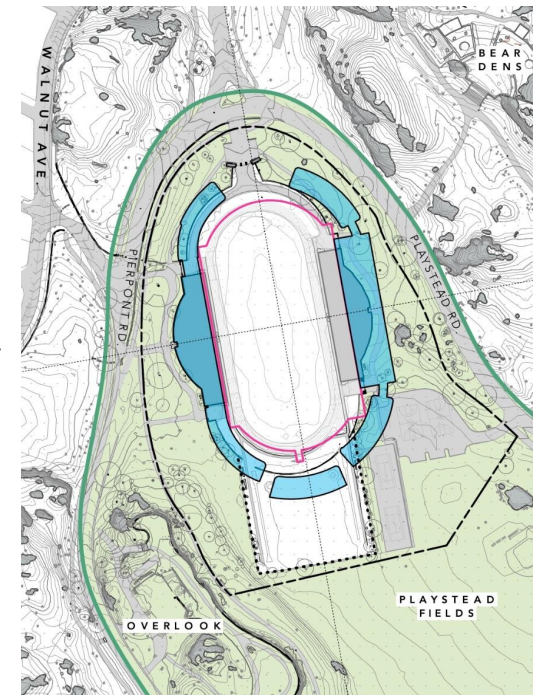
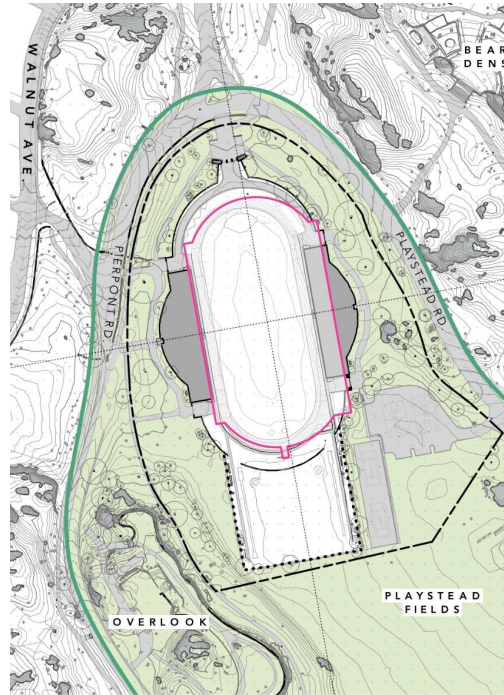
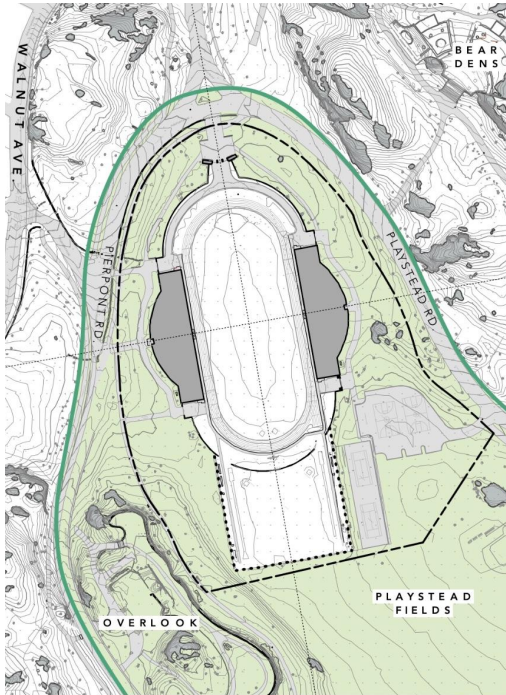

Starting with the existing stadium ...

Adding width to accommodate the track and field program ...

And siting the building to preserve key landscape features



Public Facilities



boston planning & development agency



CITY of BOSTON

Mayor Michelle Wu

# DESIGN PROGRAM

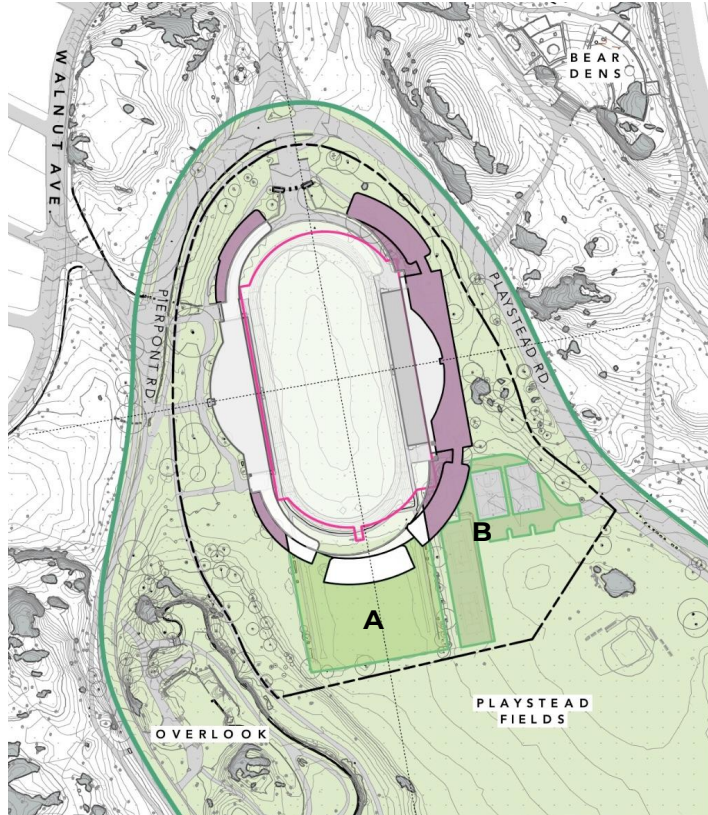
The design is a net gain to the Playstead experience



LEGEND		
	<b>STADIUM EXPANSION</b> (OUTSIDE GRANDSTANDS, NORTH AND SOUTH WALLS, BUT NOT FENCED, PRACTICE AREA)	<b>46,533 SQ. FT.</b>
	<b>PLAYSTEAD ADDITION A</b> (LEASED AREA & THE GROVE)	<b>49,181 SQ. FT.</b>
	<b>PLAYSTEAD ADDITION B</b> (CONVERTING PARKING AREA AND TENNIS COURTS INTO LAWN AND PARK PATHS, NOT INCLUDING AREA FOR BASKETBALL)	<b>29,695 SQ. FT.</b>





# DESIGN PROGRAM

## The Grove and Playstead | Design Constraints

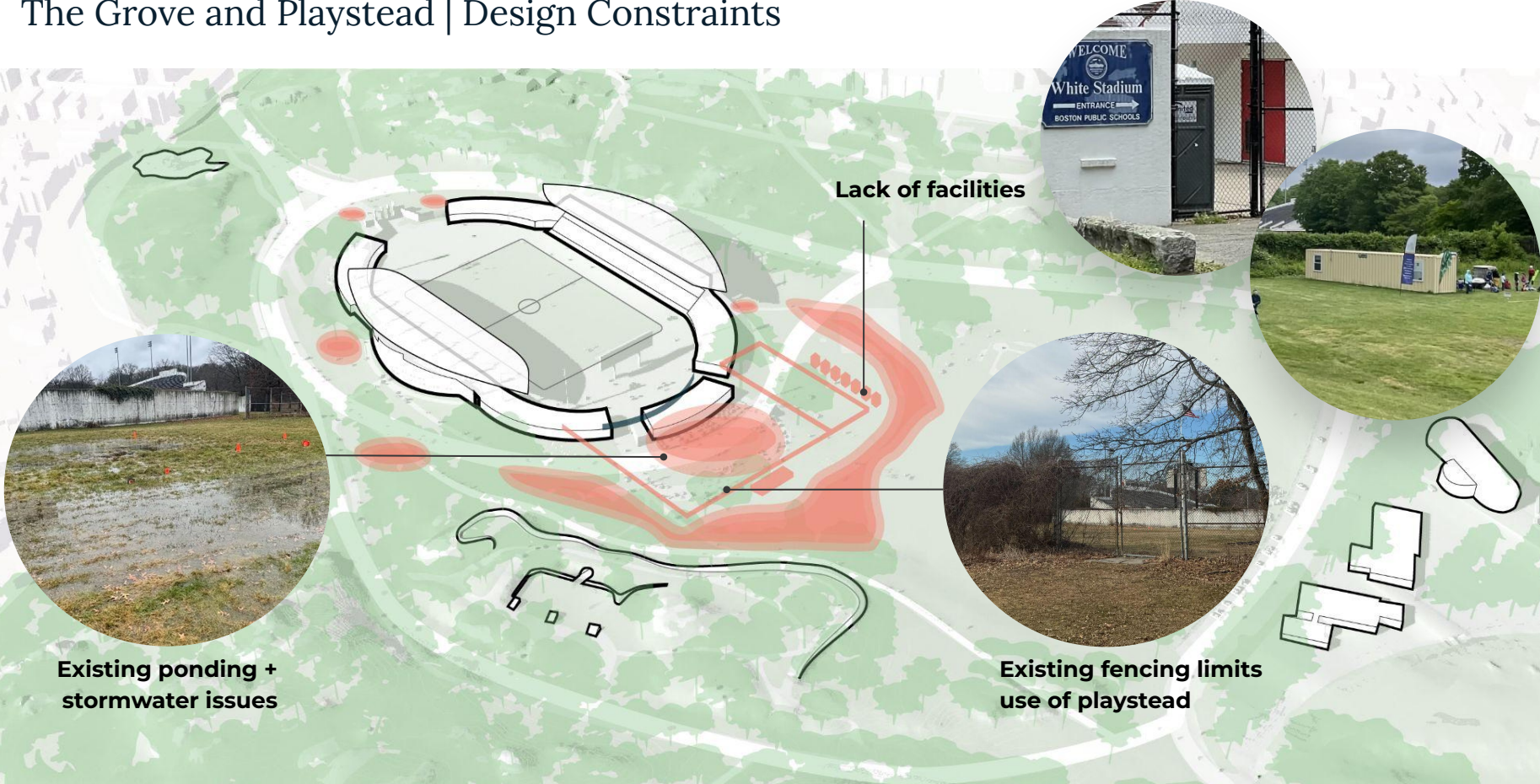



# DESIGN PROGRAM

## The Grove and Playstead | Grove Program



# DESIGN PROGRAM

The Grove and Playstead | Ticketed Events/Boston Unity Soccer Games





# DESIGN PROGRAM

The Grove and Playstead | Everyday Park Use

**365**  
DAYS / YEAR

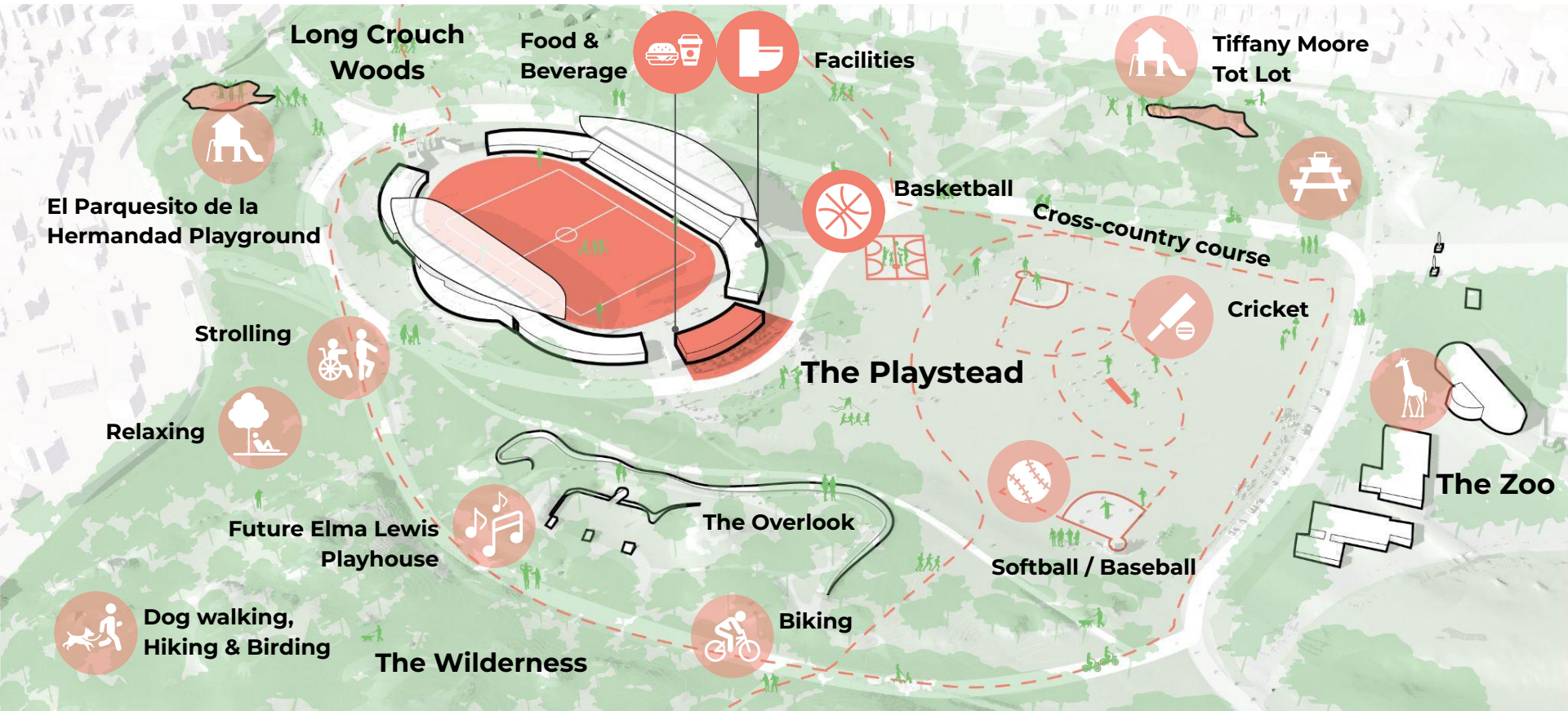



# DESIGN SUMMARY

1. Reduced the width of the West Grandstand
2. Reduced the size of the field
3. Removed the bean building in The Grove
4. Protected the character defining elements
5. Reduced pavement in The Grove and aligned pathway system with FPAP recommendations
6. Removed vehicles from Playstead Road
7. Consolidated program into wings
8. Moved scoreboard away from The Playstead
9. Replaced permanent fencing around The Grove with temporary fencing infrastructure
10. Embraced holistic design to include cross functional use of East and West Grandstands
11. Maintained and introduced new 8 lane track and created new field sports opportunities





# FEEDBACK & CLOSING DISCUSSION



# DISCUSSION & FEEDBACK

---

## Miro Notes

### Guiding question & Open Conversation

1. For the Grove, which programs would you and your family use most often?
2. Open questions around initial stadium design and programming







**B**





**NEXT STEPS**

# NEXT STEPS

---

## Upcoming Community Meetings

- **Advancing the Design:** A series of public meetings to advance a holistic stadium design responsive to past community feedback and Franklin Park Action Plan guidelines.
  - Design Meeting 1: April 25 ✓
  - Design Meeting 2: May 8 ✓
  - Design Meeting 3: May 22  **coming up!**
- **Article 80:** Review continues
  - IAG Meeting #2: May 15, focusing on transportation  **coming up!**
  - IAG Meeting #3: June 5, focusing on community benefits
- **Landmarks Commission Subcommittee:** Review continues, next meeting May 14
- **Boston Civic Design Commission (BCDC):** Review continues, next meeting May 21
- **Parks Commission:** Review continues





**B**

# APPENDIX



# DESIGN WORKSHOP #1: WHAT WE HEARD

## Feedback on Guiding Design Principles for The Playstead

### Protect The Historic Arrangement of The Playstead

#### 1 **Preserve, protect, and reinforce the continuity of the topographic conditions**

that structured Olmsted's spatial configuration of The Playstead

2 All new work associated with the stadium project should **avoid, minimize, and mitigate any adverse effects of the overarching visual and spatial relationships within the park** and with surrounding communities.

*For me, one of the **character defining features of the playstead is the "openness" of the playstead**... It helps one to feel relaxed and to decompress...  
**I have concerns around the horizontal and vertical space with the evolving stadium.***

- Comment from Community Member,  
Workshop #1, (LH)

*The feeling of being in **a large natural space is an important, positive part of the experience** of being in this part of the park - to walk, jog etc. I've also attended many events.*

Chat from Community Member,  
Workshop #1, (SF)

# COMMUNITY FEEDBACK FROM WORKSHOP #1

## Franklin Park Action Plan - Guiding Design Principles

### Respects Existing Views & Destinations

**3 Maintain the spatial relationship between the key promontories** (The Overlook, zoo, tailgate edge, and views from Long Crouch Woods) **arranged around an open center, each demanding its own space while being responsive to the others.** New destinations should be set within the perimeter of The Playstead, each with their own “address” along the edge un-encroached by and respecting the others from 360° (i.e. multi sided-ness).

*I use the park every morning to run with my dog. I appreciate the **quiet surroundings** and the ability to escape the hustle and bustle while enjoying the bear cage loop or the wilderness grove. **How are you going to maintain that feel especially on game days?***

Chat Note from Community Member,  
Workshop #1, (MP)

# COMMUNITY FEEDBACK FROM WORKSHOP #1

## Franklin Park Action Plan - Guiding Design Principles

### Minimizes Impacts of the Stadium Building Volume

4 Approach the **design of the stadium as one structure** whose scale, architectural character, and coherence will have significant impact on the larger Playstead, and avoid introducing elements that may constrain the reuse and reinstatement of the Overlook Terrace as the central built feature.

Chat Note from Community Member,  
Workshop #1, (\_\_\_)

5 Acknowledge that **The Overlook Shelter** was the only building that Olmsted introduced into The Playstead. **All future architectural interventions must be deferential to the larger landscape and responsive to its visual and spatial constructs.**

*I hope the plan can **preserve the quality of respite** this provides so many residents access to green space which preserves physical and emotional health of community*

Chat Note from Community Member,  
Workshop #1, (PA)



# COMMUNITY FEEDBACK FROM WORKSHOP #1

## Franklin Park Action Plan - Guiding Design Principles

### Restores Visual & Physical Continuity

6 **Remove visual and physical barriers to establish shared public access to the stadium** (in coordination with Boston Public Schools and Boston Unity Soccer) and reinstate the important **visual and spatial continuity and connectivity** with the larger park landscape and across the fields.

*Please create accessible connections to the playstead.*

Verbal Note from Community Member, Workshop #1, (\_\_\_)

**ADD CITATION**

Chat Note from Community Member, Workshop #1, (\_\_\_)



# COMMUNITY FEEDBACK FROM WORKSHOP #1

## Subtitle

### Prioritize Pedestrian Safety & Comfort

7 Promote freedom of pedestrian movement by **supporting and clarifying the continuity of the park circulation system**, whose alignment and width harmonizes with the topography and accommodates different uses (pedestrian and bikes), and is supported by canopy for human comfort.

*I would appreciate a little deeper dive into the intended walk/bike/other circulation and how that contrasts with it currently.*

Chat Note from Community Member,  
Workshop #1, (MC)

*I want to understand how bikes and pedestrians can safely move between Park Lane, Parquecito, and zoo entrance, to Tiffany Moore Playground. Safety for toddlers, 3-4 people at a time on balance bikes.*

Chat Note from Community Member,  
Workshop #1, (MG)

# COMMUNITY FEEDBACK FROM WORKSHOP #1

Subtitle

## Enhance Existing Canopy & Start the Next Generation

8 Protect existing heritage and legacy trees, **remove invasives, and plant new trees as the next generation of canopy;** use informal groves of canopy trees to reinforce primary circulation while maintaining continuity of the larger open center of The Playstead.

*I have been coming to the playstead my whole life, and currently visit at least once a day with my dog. I would love for there to be less trash and discarded food for my dog to eat. **There is also a TON of poison ivy.***

Chat Note from Community Member,  
Workshop #1, (CW)

Chat Note from Community Member,  
Workshop #1, (\_\_\_)





# WHITE STADIUM SEASONAL PROGRAMMING

## Program Usage by Season

### Spring



SOCCER



TRACK  
& FIELD



BASKETBALL



TENNIS



COMMUNITY  
EVENTS

### Summer



SOCCER



TRACK  
& FIELD



BASKETBALL



TENNIS



COMMUNITY  
EVENTS

### Fall



SOCCER



CROSS  
COUNTRY



FOOTBALL



COMMUNITY  
EVENTS

### Winter



TRACK  
& FIELD



COMMUNITY  
EVENTS

Add  
and



Public Facilities



boston planning &  
development agency

CITY of **BOSTON**

Mayor Michelle Wu

# DESIGN PROGRAM

## Planting Strategies & Ecology

DRAFT

Replant informal historic groupings with a diverse canopy

Preserve existing tree canopy

Plant diverse canopy + native understory

Remove Invasive species

open critical views



# Next steps....

## Site Access and Circulation AND Transportation

**DRAFT**

PPL + SHUTTLE



PPL + SHUTTLE



+FIRE + AMB.

+SERVICE VEHICLES



Prioritize Ped + Bike

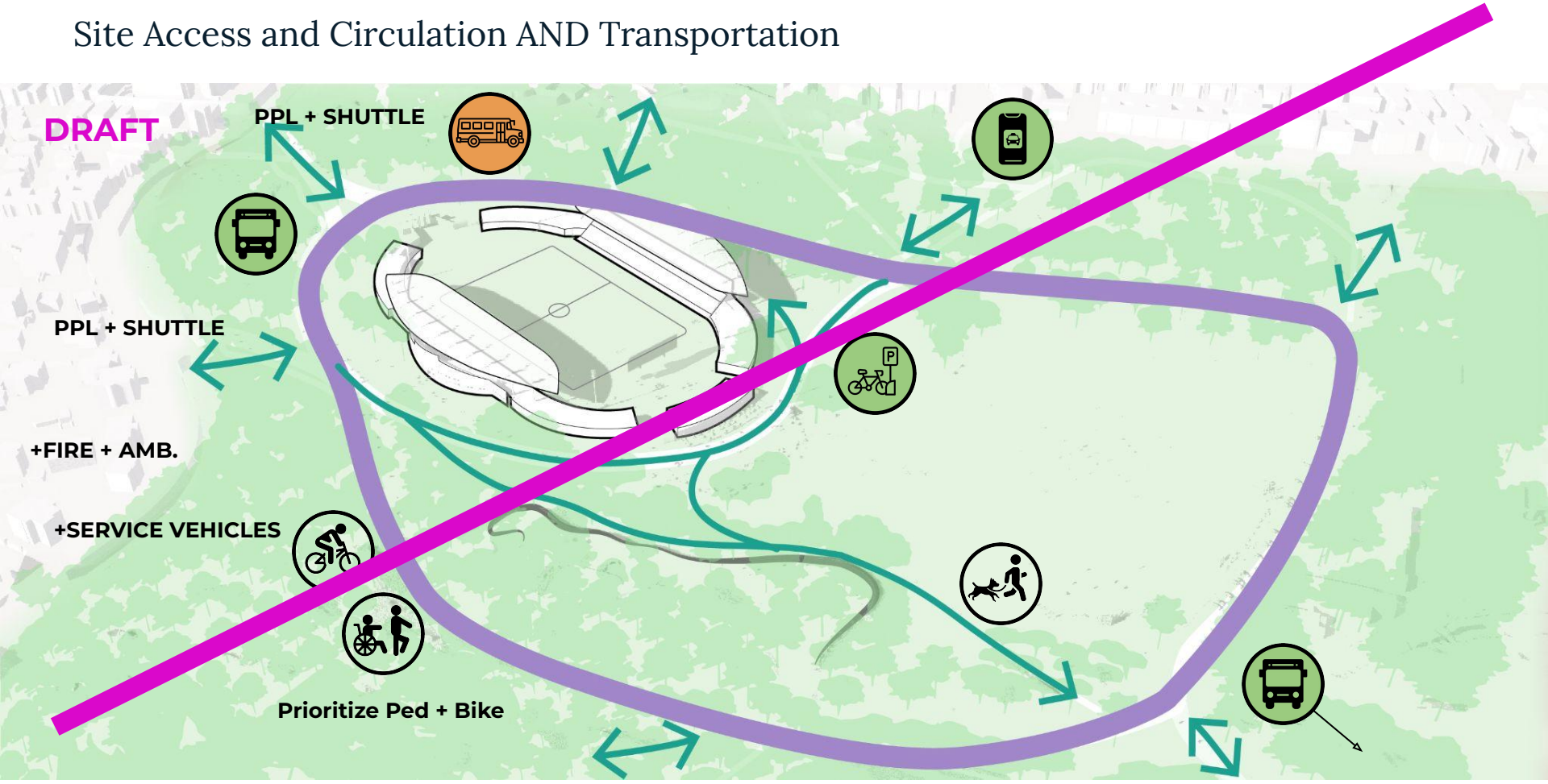



# CURRENT VS. FUTURE ATHLETIC FACILITIES

Program	Current	Proposed	at Stadium	in Franklin Park	across City
<b>Baseball / Softball fields</b>	3	3	-	-	
<b>Basketball courts</b>	2	2	-	-	
<b>Multi-Purpose Field (Playstead)</b>	1	1	-	-	
<b>Tennis courts</b>	2	0	▼ -2	▲ +2	
<b>Soccer fields</b>	1	1	▲ +1	▲ +1	
<b>Football</b>	1	0	▼ -1	▼ -1	▲ +1
<b>Strength and Conditioning</b>	0	1	▲ +1	▲ +1	▲ +1
<b>Track:</b> Straights	1	2	▲ +1	▲ +1	▲ +1
Quantity of Lanes	6	8	▲ +2	▲ +2	▲ +2
Distance - 400M Track	1	1	-	-	-
<b>Field:</b> Discus	1	1	-	-	-
Hammer		1	▲ +1	▲ +1	▲ +1
High Jump	1	1	-	-	-
Javelin	1	1	-	-	-
Long Jump / Triple Jump	2	2	-	-	-
Shot Put	2	2	-	-	-
Steeplechase	0	1	▲ +1	▲ +1	▲ +1
Pole Vault	1	1	--	--	--
<b>BPS Athletics Offices</b>	6	12	▲ +6	▲ +6	▲ +6

B  
P  
S

# PROGRAM FACILITIES

What facilities are currently available for sports programs at White Stadium?

Program / Sport	Existing
Baseball / Softball	3
Basketball	2
Multi-Purpose Fields (Playstead)	1
Soccer	1
Tennis	2
Football	1
<b>Track:</b> Straights	1
Quantity of Lanes	6
Distance - 400M Track	1
<b>Field:</b> Discus	1
Hammer	0
High Jump	1
Javelin	1
Long Jump / Triple Jump	2
Shot Put	2
Steeplechase	0
Pole Vault	1
<b>Athletics Offices</b>	6
<b>Strength and Conditioning</b>	0



# WHITE STADIUM 2023 FEASIBILITY STUDY

---

## Program Enhancement

### **In addition to facility repairs, we asked how else BPS Athletics could program White Stadium to enhance district-wide programs?**

- Increasing sports participation to support student development is a major goal for BPS Athletics, given participation dropped from **44% in 2019 to 34% in 2021**.
- BPS Athletics suggested additional ways to leverage White Stadium to revitalize interest in sports programs:
  - Address need for **strength training and conditioning facilities**, including offseason programs.
  - Increase **athletic training staff** to educate students on injury prevention and provide treatment.
  - Offer **versatile event spaces** for award ceremonies, team dinners, large team meetings.
  - Provide **venues capable of hosting significant sporting events**, such as playoffs, with ample seating for large crowds.
  - Establish dedicated **study spaces for students** to utilize between practices and games.





# BPS GOALS FOR WHITE STADIUM RENOVATION

Opportunity of a Generation to deliver:

- A regional **BPS Athletic Hub** to serve students city-wide
- Expanded **indoor and outdoor athletic programming** year-round
- Much greater **public access to & community use** of stadium resources
- **Sustainable maintenance partner** to preserve investments
- Yearly **community benefits** and hundreds of **new jobs**



# BPS GOALS FOR WHITE STADIUM RENOVATION

Benefits of a Public-Private Community Partnership for Franklin Park as a whole.

- Deliver **higher quality amenities and programs** than the City could on its own
  - Sustainable maintenance partner to preserve investments
  - Outdoor and indoor amenities: high quality field, 400M track, athletic hub with public amenities
- Create new **pathways to prosperity**
  - New jobs at all construction stages
  - MWBEs and local business opportunities
  - Community Benefits Fund
- Accelerate implementation of the **Franklin Park Action plan**
- Provide **support for other large events** at the park



# CURRENT VS. FUTURE ATHLETIC FACILITIES

Program	Current	Proposed	at Stadium	in Franklin Park
<b>SUMMARY</b>	<b>26</b>	<b>30</b>	<b>+5</b>	<b>+9</b>
<b>Baseball / Softball fields</b>	3	3	-	-
<b>Basketball courts</b>	2	2	-	-
<b>Multi-Purpose Field (Playstead)</b>	1	1	-	-
<b>Tennis courts</b>	2	0	-2	+2
<b>Soccer fields</b>	1	1	+1	+1
<b>Football</b>	1	1*	-	-
<b>Strength and Conditioning</b>	0	1	+1	+1
<b>Track:</b> Straights	1	2	+1	+1
Quantity of Lanes	6	8	+2	+2
Distance - 400M Track	1	1	-	-
<b>Field:</b> Discus	1	1	-	-
Hammer	0	1	+1	+1
High Jump	1	1	-	-
Javelin	1	1	-	-
Long Jump / Triple Jump	2	2	-	-
Shot Put	2	2	-	-
Steeplechase	0	1	+1	+1
Pole Vault	1	1	--	--

B  
P  
S



# DESIGN CONSIDERATION

## Multi-Sport field

Field of play allows for other sports besides professional soccer, subject to the maintenance schedule:

- Men's Lacrosse (180' x 330')
- Women's Lacrosse (222' x 360')
- Field Hockey (180' x 300')
- Football (165' x 360')
- Flag Football - 3 fields (90'x210')

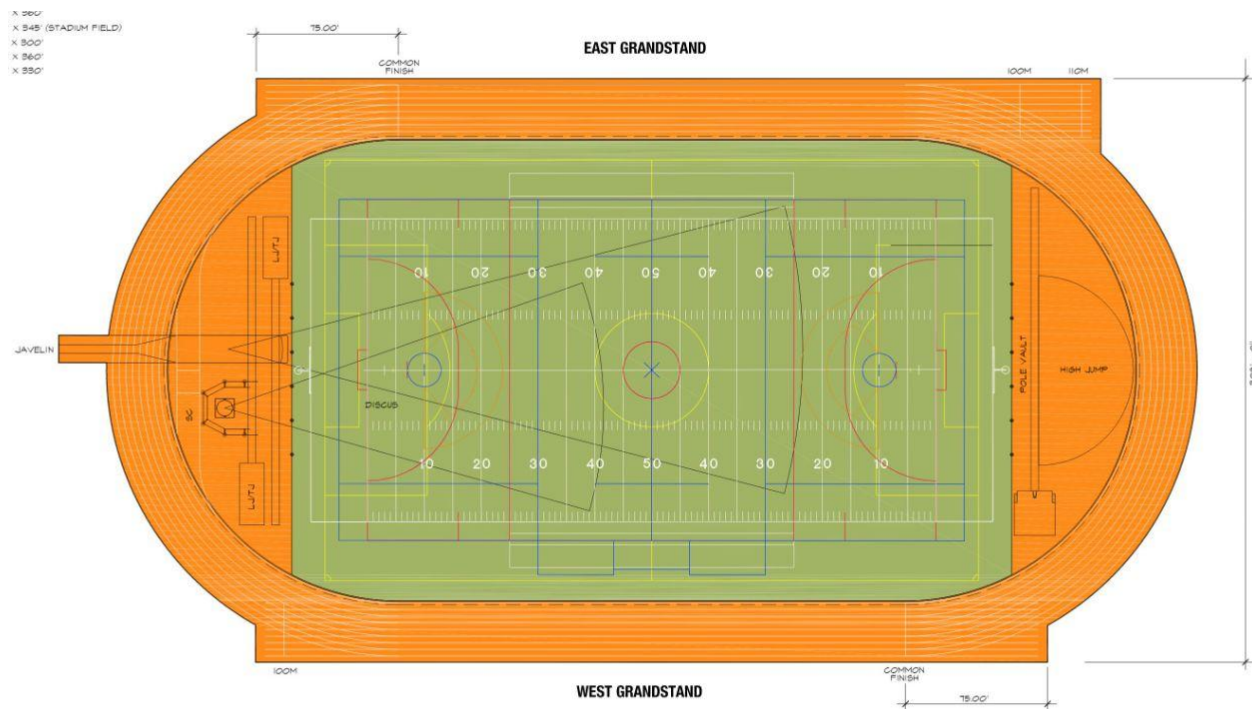

# DESIGN CONSIDERATION

More to come in meeting #3...

## Enhance Existing Canopy & Start the Next Generation



Existing View  
from Overlook with  
Overgrown Vegetation

IMPROVE CONNECTIONS  
+ OPEN VIEWS FROM  
OVERLOOK / ELMA  
LEWIS PLATHOUSE.

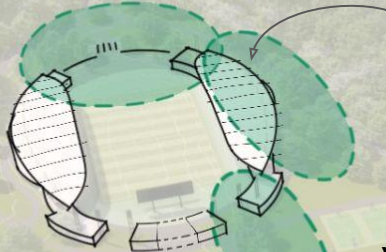

Volunteer  
Trees at Future Grove



Original Park  
Tree Canopy, Figure  
Extract from FPAP



Volunteer  
Trees at Stadium Wall



# DESIGN CONSIDERATION

More to come in Transportation Meetings...

Prioritize Pedestrian Safety & Comfort



Example of  
Confusing Existing  
Circulation

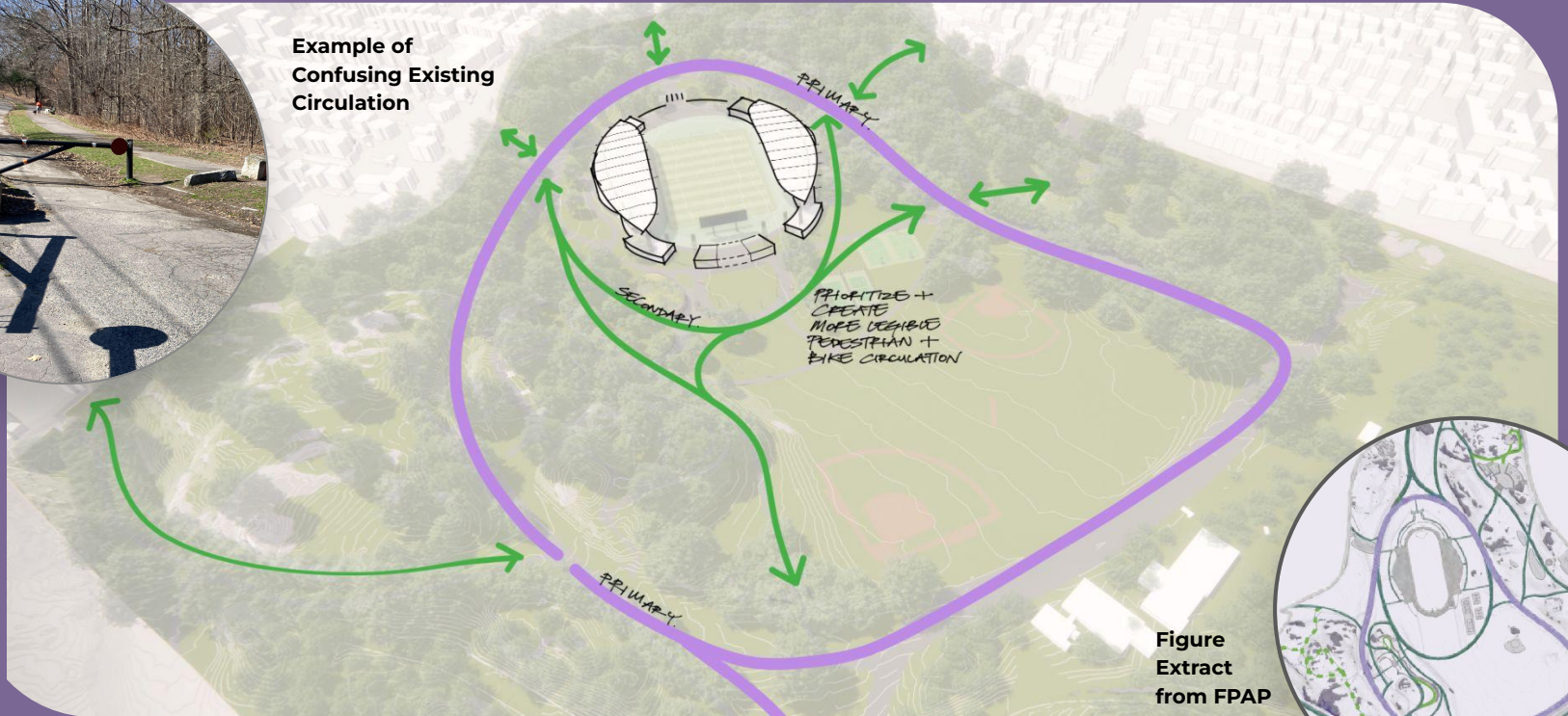
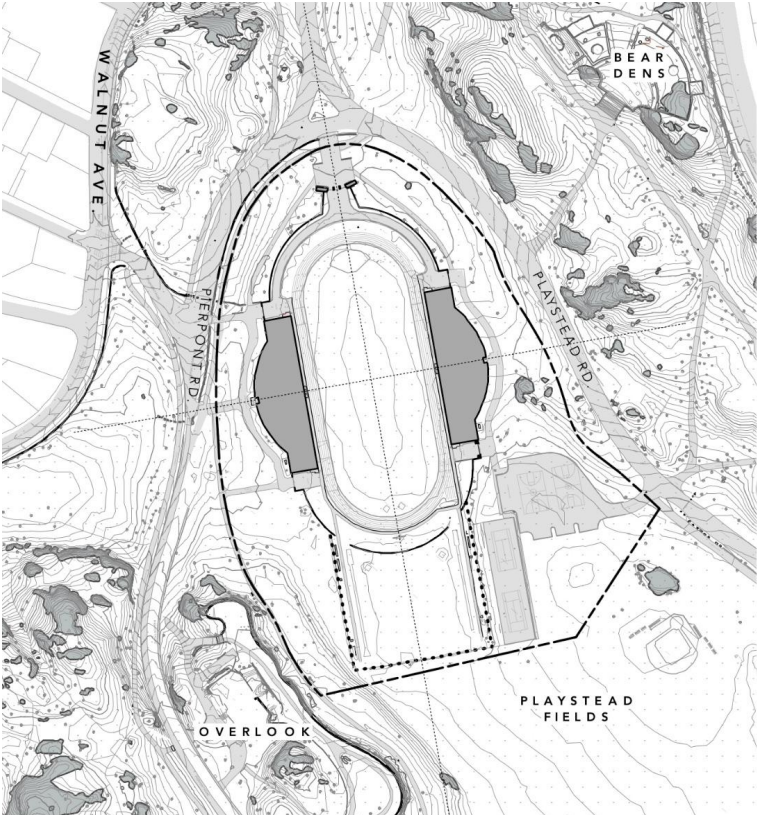

Figure  
Extract  
from FPAP



# DESIGN PROGRAM

## Existing Stadium & Field



Public Facilities



boston planning & development agency

CITY of **BOSTON**

Mayor Michelle Wu

# DESIGN PROGRAM

## Expanding the Field

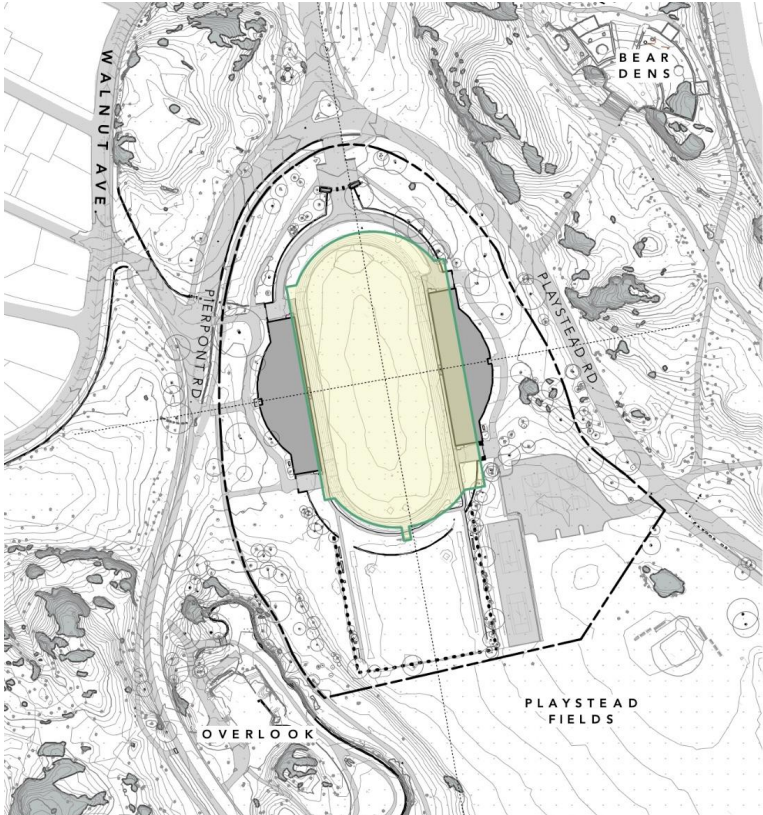

# DESIGN PROGRAM

## Expanding the Stadium

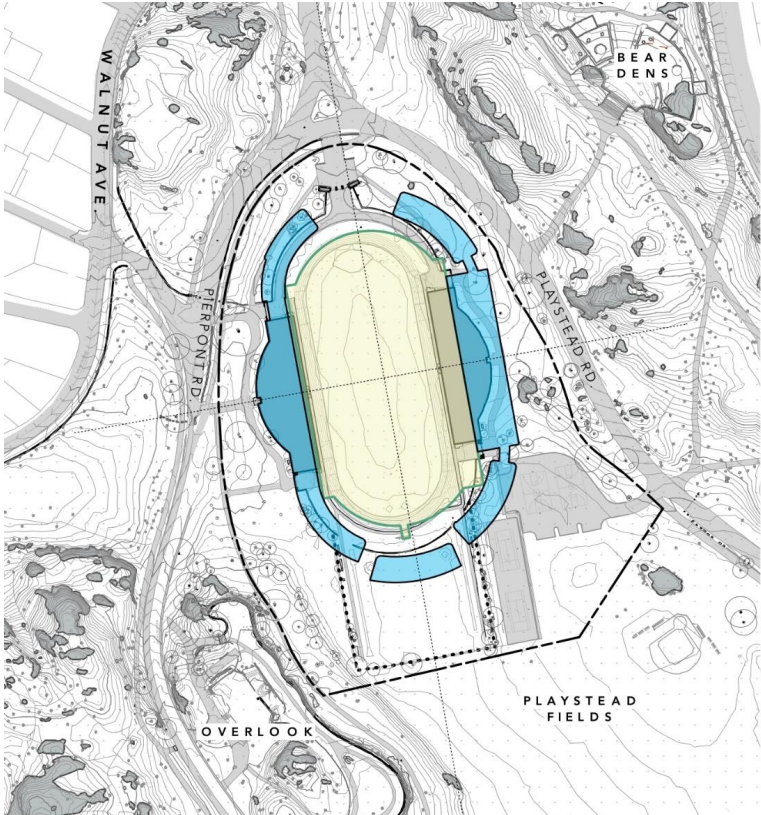





**B**

# WHAT WE HEARD

# DESIGN WORKSHOP #1

## Franklin Park Action Plan → Guiding White Stadium Design Principles

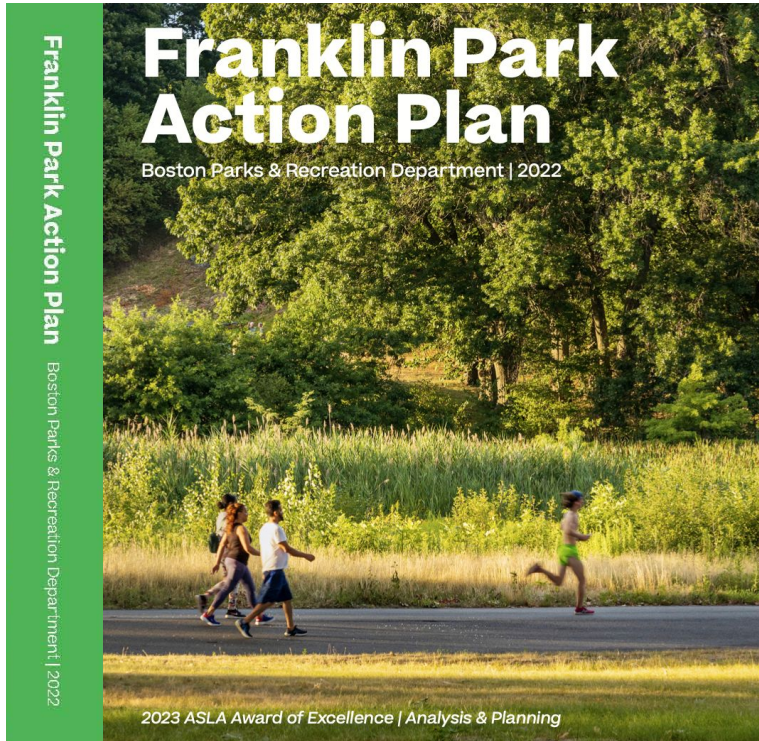

### The Plan for the Future of Franklin Park

The Franklin Park Action Plan (2023) was developed over **3 years** with extensive engagement from 2019-2022, reaching over **25,000 community members** and **hundreds of organizations**.

The FPAP is a **living document** intended to guide park improvement projects, with recommendations designed to be adaptable to and provide guidance on future opportunities, like White Stadium.

The **8 Design Principles** reviewed in Workshop #1 establish that all future improvements to the White Stadium design:

1. Protect the Historic Arrangement of The Playstead
2. Minimize adverse impacts on spatial relationships
3. Respect Existing Views & Destinations
4. Approach the Stadium design as one structure
5. Minimize Impacts of the Stadium Building Volume
6. Restore Visual & Physical Continuity
7. Prioritize Pedestrian Safety & Comfort
8. Enhance Existing Canopy & Start the Next Generation



# WHAT ELEMENTS CAN WE ACCOMMODATE?

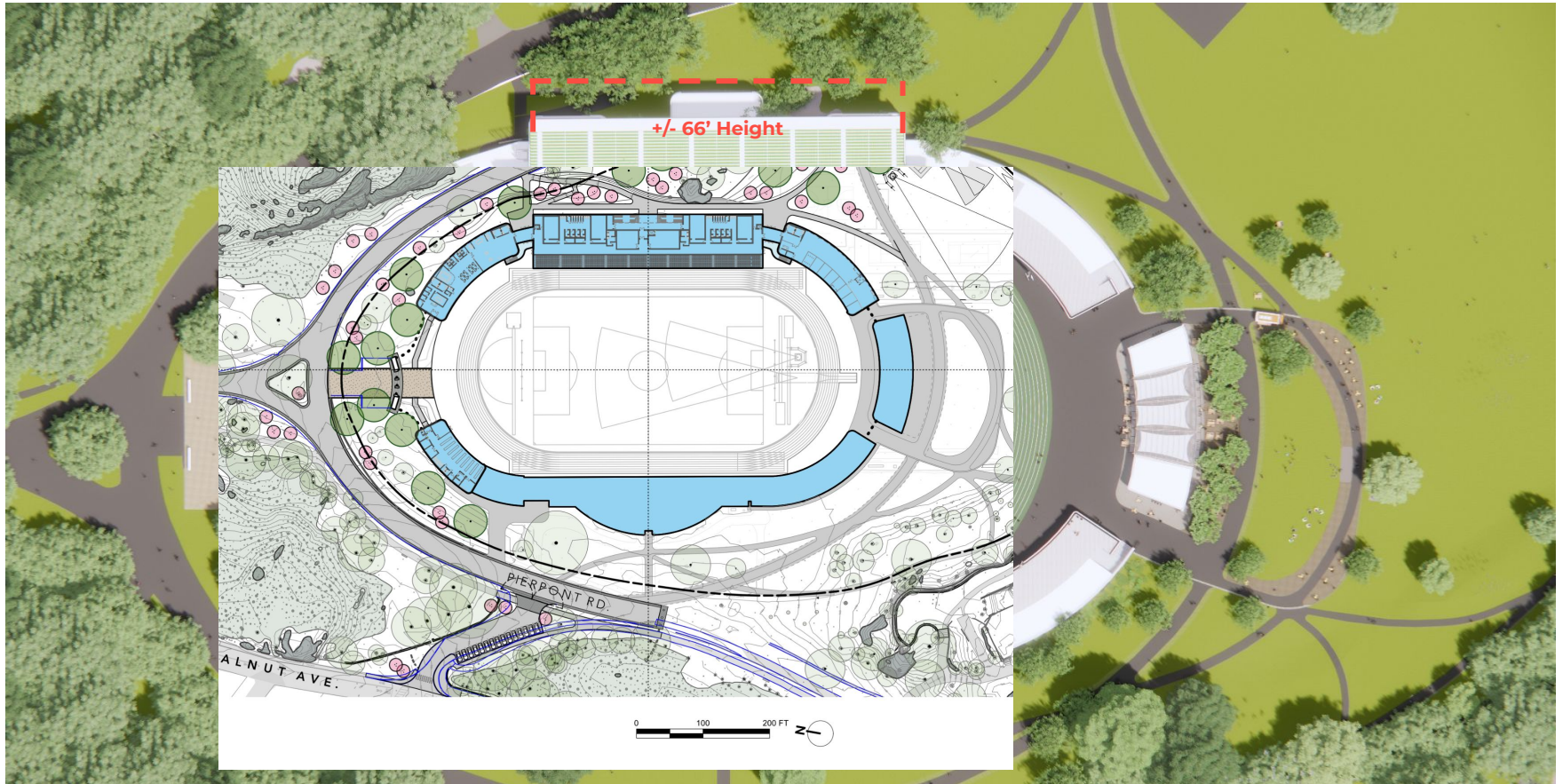



# DESIGN PROGRAM

## Balancing Stadium Program and Character Defining Features

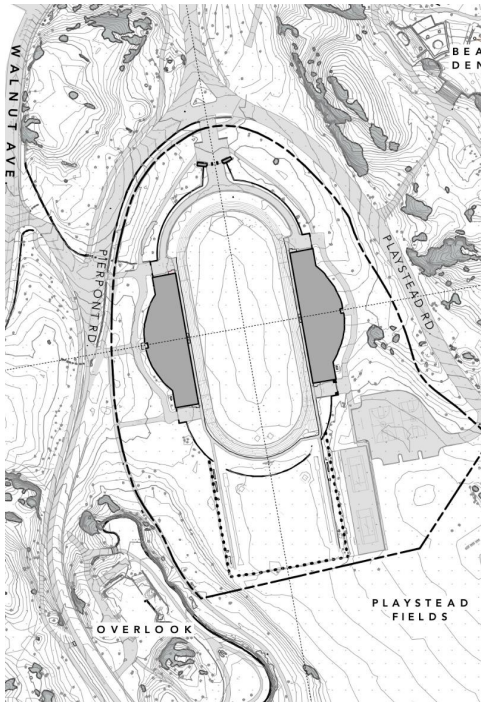

Starting with the existing stadium ...



Adding width to accommodate the track and field program ...

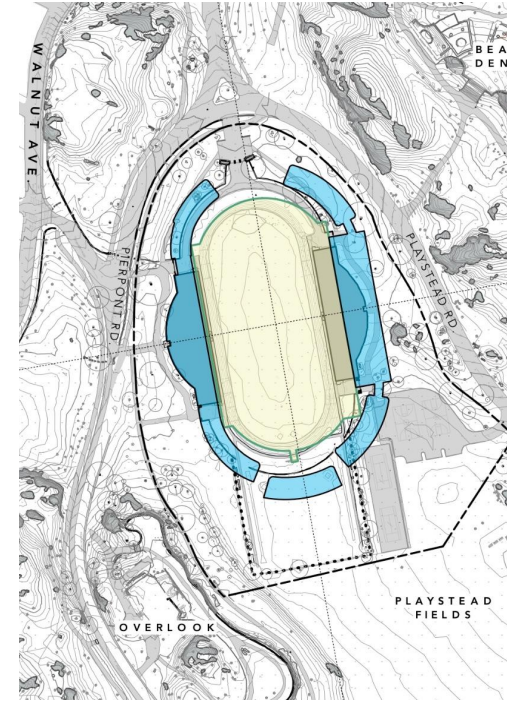





And siting the building to preserve key landscape features

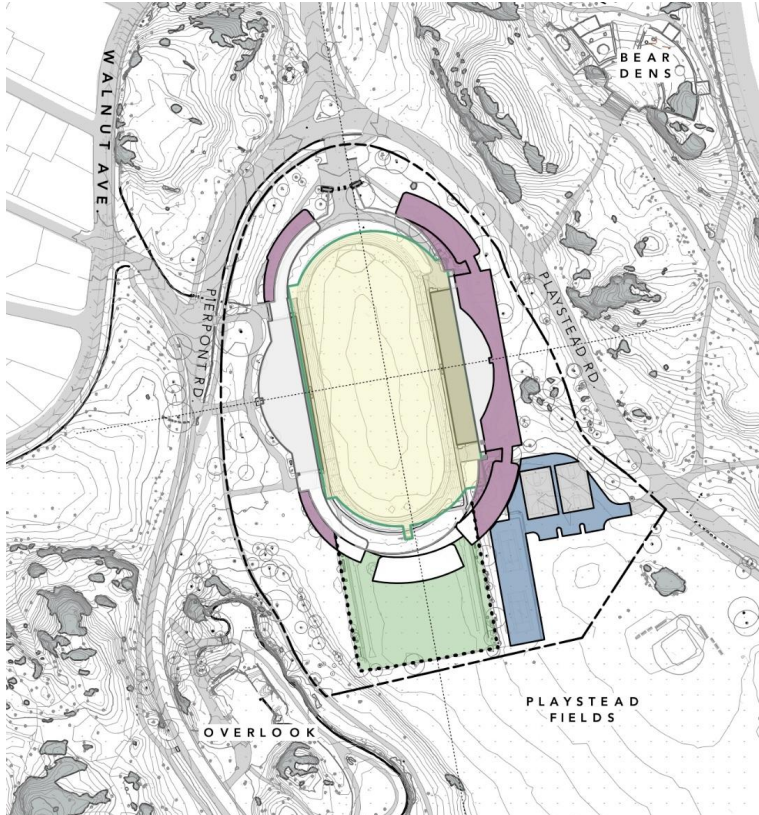

# DESIGN PROGRAM

The design is a net gain to the Playstead experience



LEGEND		
	<b>STADIUM EXPANSION</b> (OUTSIDE GRANDSTANDS, NORTH AND SOUTH WALLS, BUT NOT FENCED, PRACTICE AREA)	<b>46,533 SQ. FT.</b>
	<b>PLAYSTEAD ADDITION A</b> (LEASED AREA & THE GROVE)	<b>49,181 SQ. FT.</b>
	<b>PLAYSTEAD ADDITION B</b> (CONVERTING PARKING AREA AND TENNIS COURTS INTO LAWN AND PARK PATHS, NOT INCLUDING AREA FOR BASKETBALL)	<b>29,695 SQ. FT.</b>

