



Improvements to the Hamilton, Glover, and Sarmiento statue nodes

Landmarks Commission Hearing | 3.23.2021

AGENDA

1

PROJECT TEAM INTRODUCTION

2

PROJECT SCHEDULE

3

HAMILTON STATUE NODE

4

GLOVER STATUE NODE

5

SARMIENTO STATUE NODE

PROJECT TEAM

Friends of the Public Garden

Bob Mulcahy

Director of Parks Care & Capital Projects

bob@friendsofthepublicgarden.org

617-723-8144 x206

Margaret Pokorny

Friends Member & Project Champion

Available Light

Steven Rosen, President & Creative Director

Hess Smith, Associate IALD

Lentine Electric Service

John Lentine, President

Boston Parks & Recreation

Liza Meyer, Chief Landscape Architect

Rob Rottenbacher, Chief Engineer

Weston & Sampson

Gene Bolinger, RLA, Principal

Cassie Bethoney, RLA, Project Manager

Lanie Cohen, Site Designer

Dan Marchand, Electrical Engineer

Fleming Brothers (site contractor)

John Fleming, Owner



PROJECT SCHEDULE

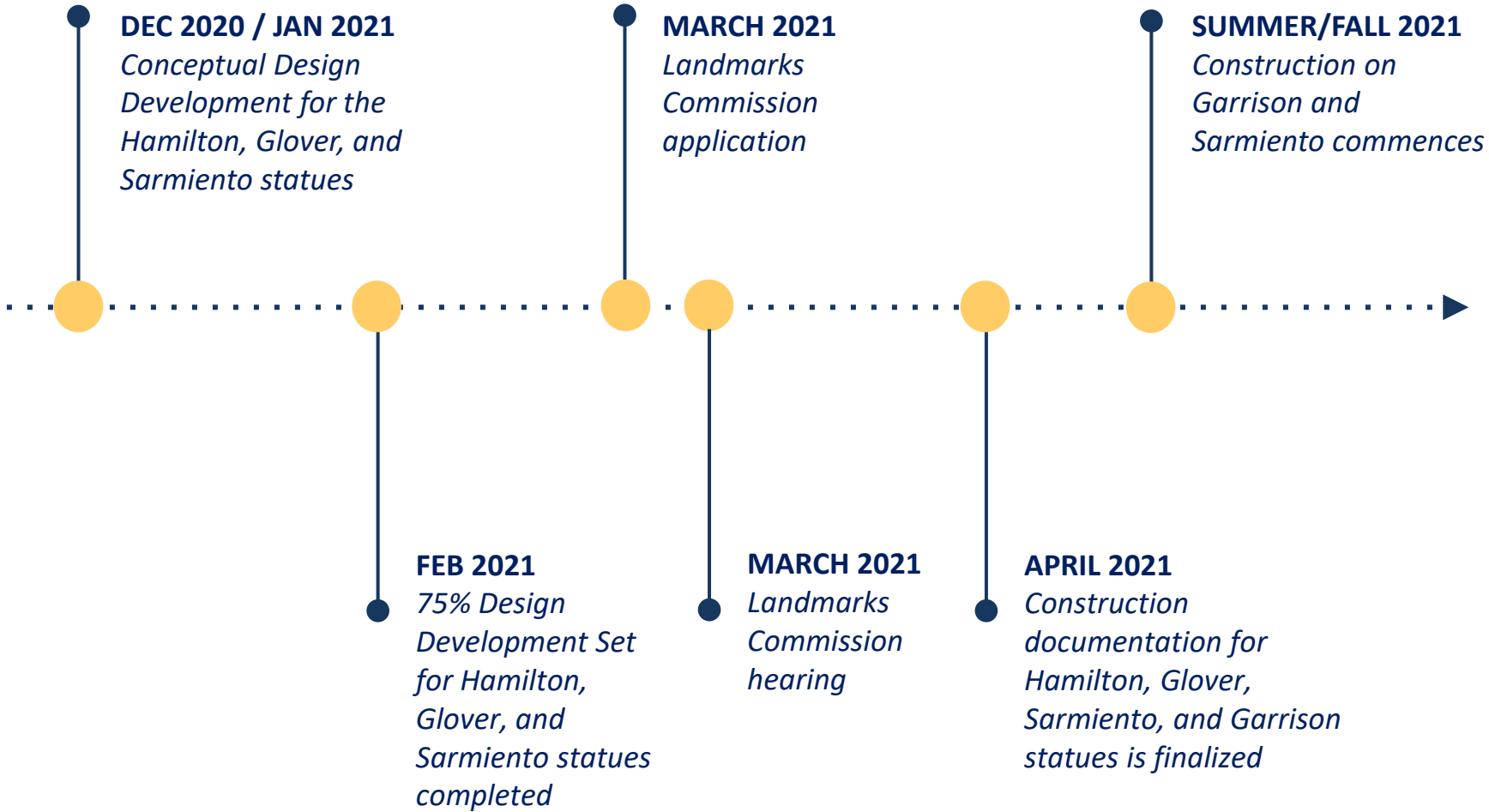

LOCUS PLAN

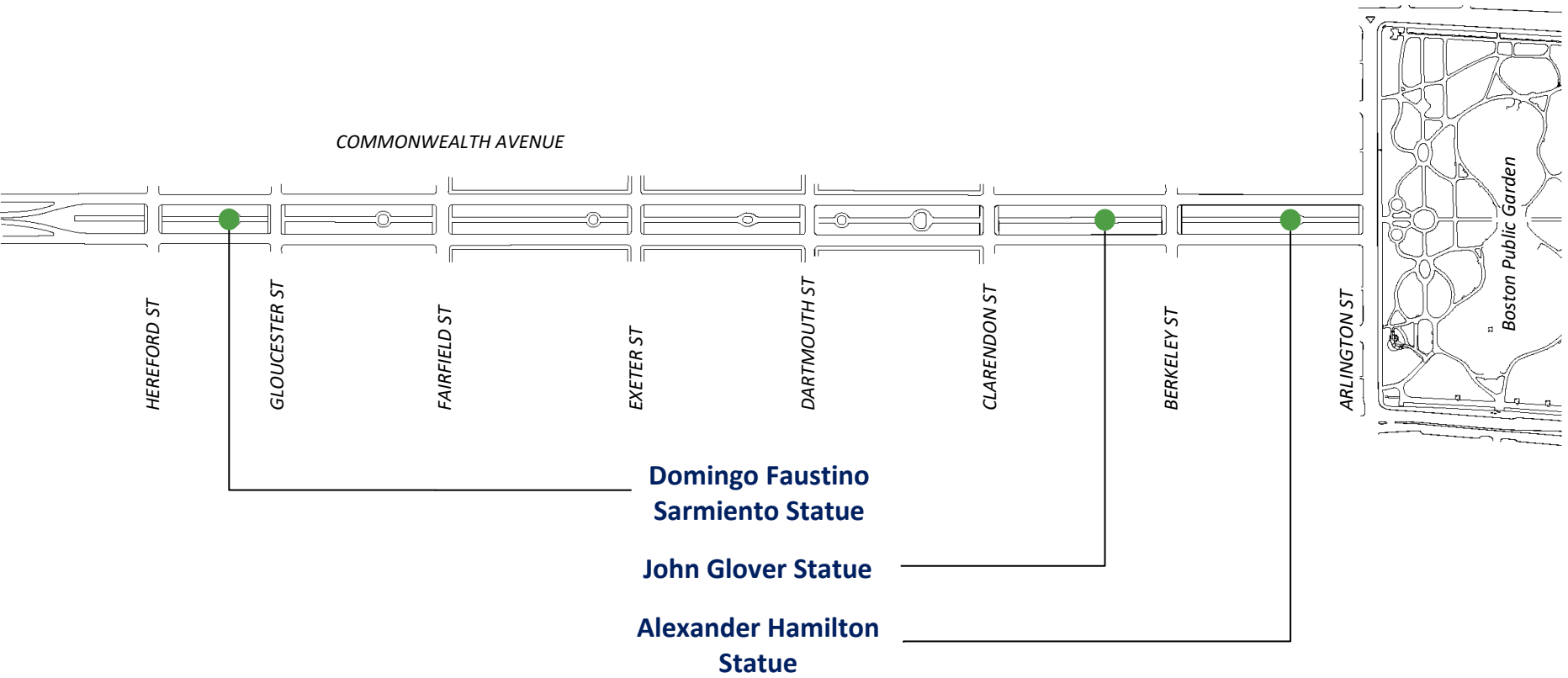

EXISTING SITE CONDITIONS: HAMILTON

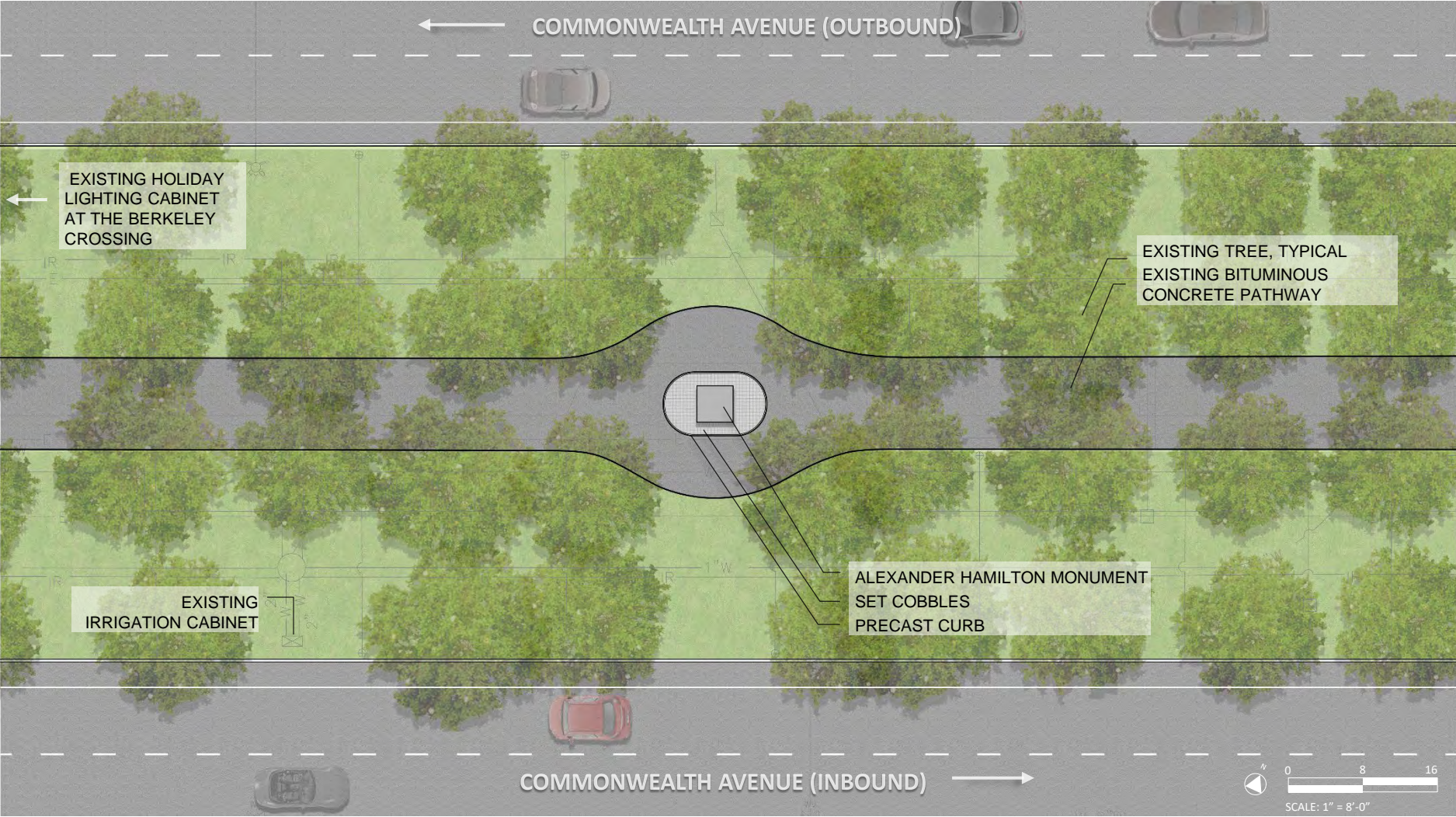







BASIC IMPROVEMENT PROGRAM: HAMILTON



- Statue uplighting and incidental electrical work
- Walkway repaving
- Redesign of curbing
- Site restoration
- Protection of existing trees

PROPOSED IMPROVEMENTS: HAMILTON

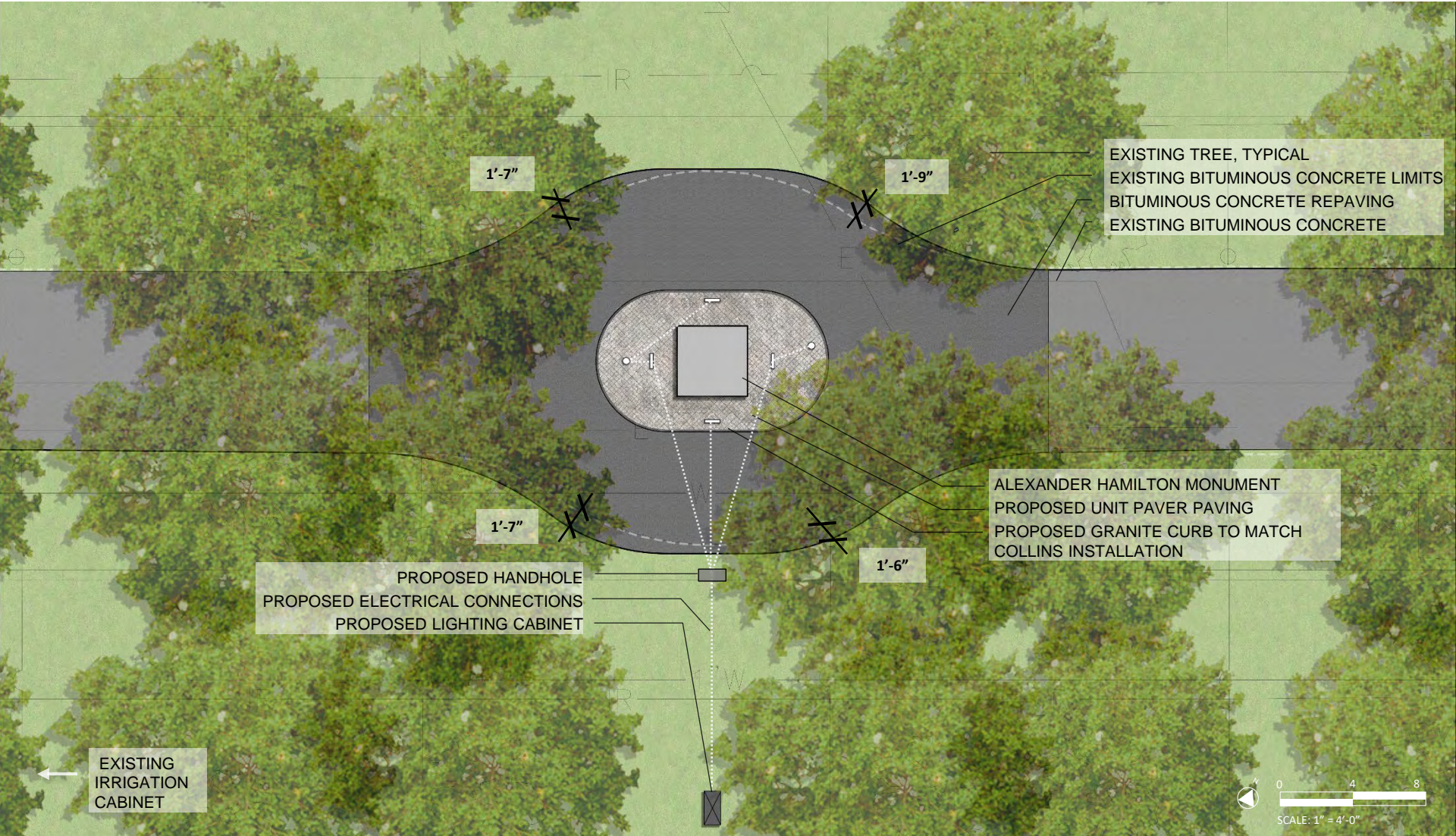

PROPOSED PAVING DETAIL: HAMILTON

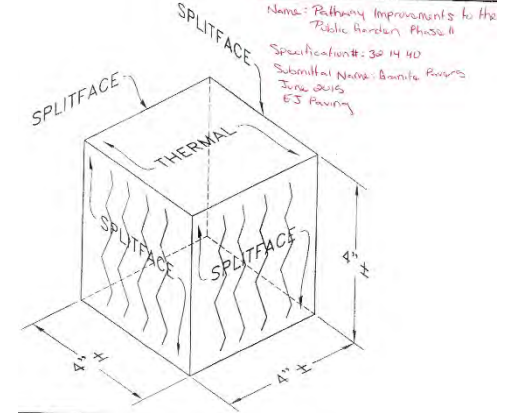
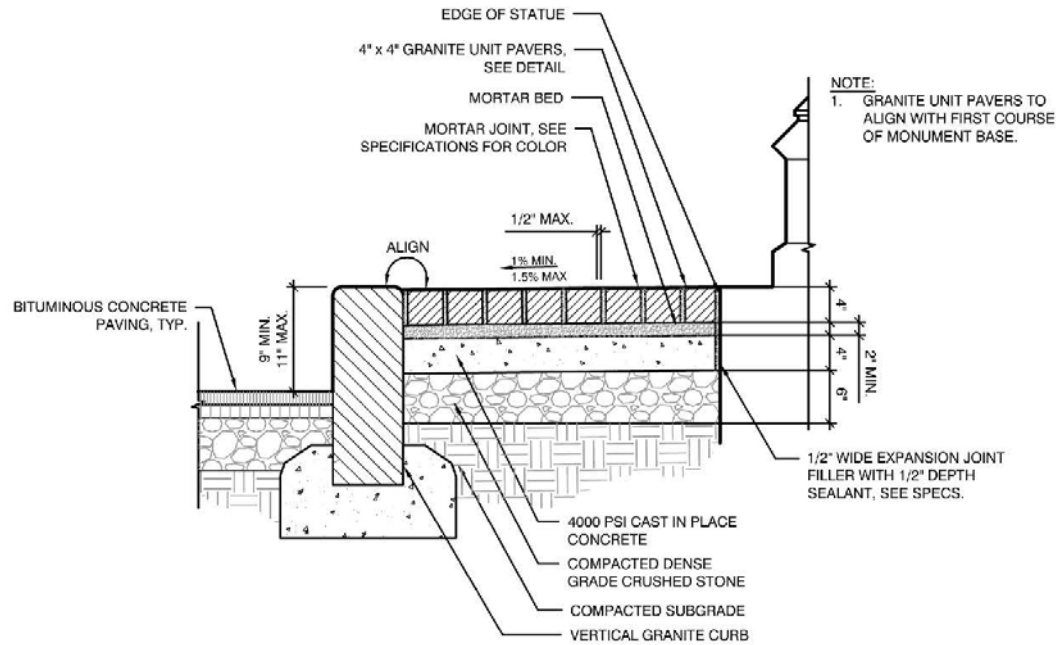

5 GRANITE UNIT PAVERS
SCALE: N.T.S.



Curbs to match look of the new beveled curb at Collins statue

LIGHTING FIXTURE PLAN: HAMILTON

Reference Notes (Specific to this Page only)

- A** Sculpture is not perfectly centered within curbs. Type SG fixtures are equidistant from the statue but appear to not be centered.
- B** 2-1/2" Square by 5" long tree-mounted adjustable accent fixture. Fixture height to be approximately 13'-7" above the ground with a long snoot on the bottom of fixture. (Type SE)
- C** 7-1/2" Diameter semi-recessed ingrade adjustable fixture capable of a 45° tilt. Fixture extends 2-1/4" above concrete pad. (Type SF) Typical.
- D** 3-1/2" Wide by 5" tall by 18" long in-ground cut-off wall wash fixture. (Type SG) Typical.

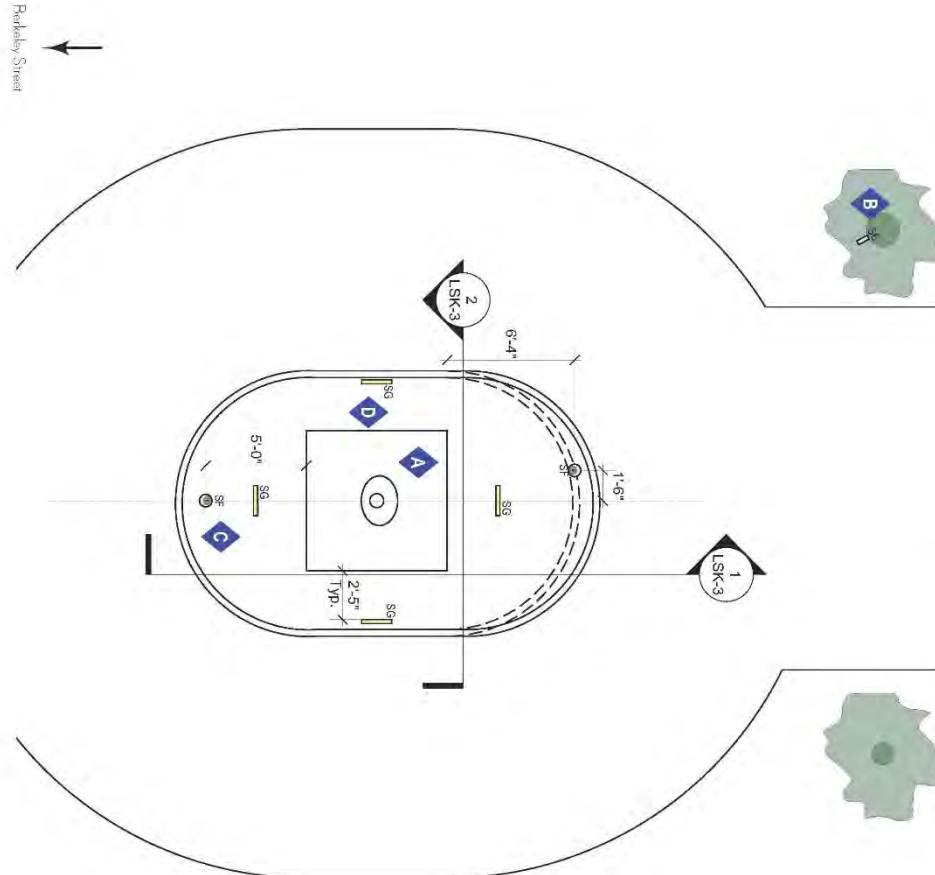

Type SE Fixture Image



Type SF Fixture Image



Type SG Fixture Image

1 Lighting Plan
Scale: 3/16" = 1'-0"

This Drawing Shows Design Intent Only And Is
Not To Be Used As A Construction Document.

LIGHTING FIXTURE PLAN: HAMILTON



LIGHTING FIXTURE PLAN: HAMILTON

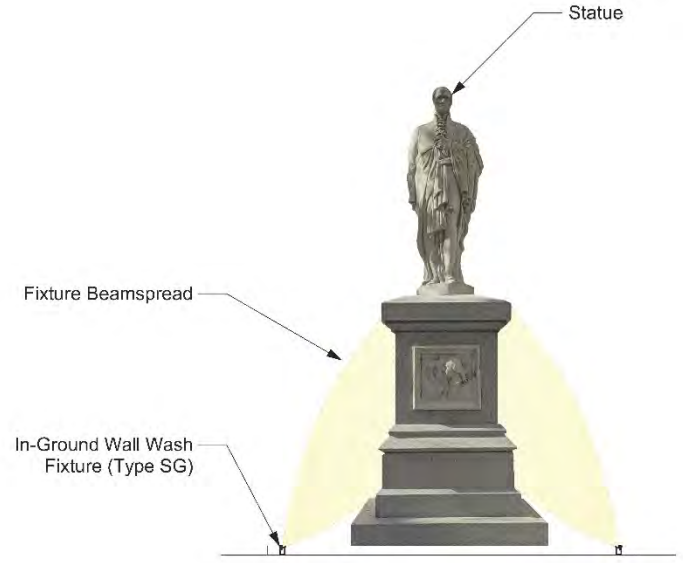
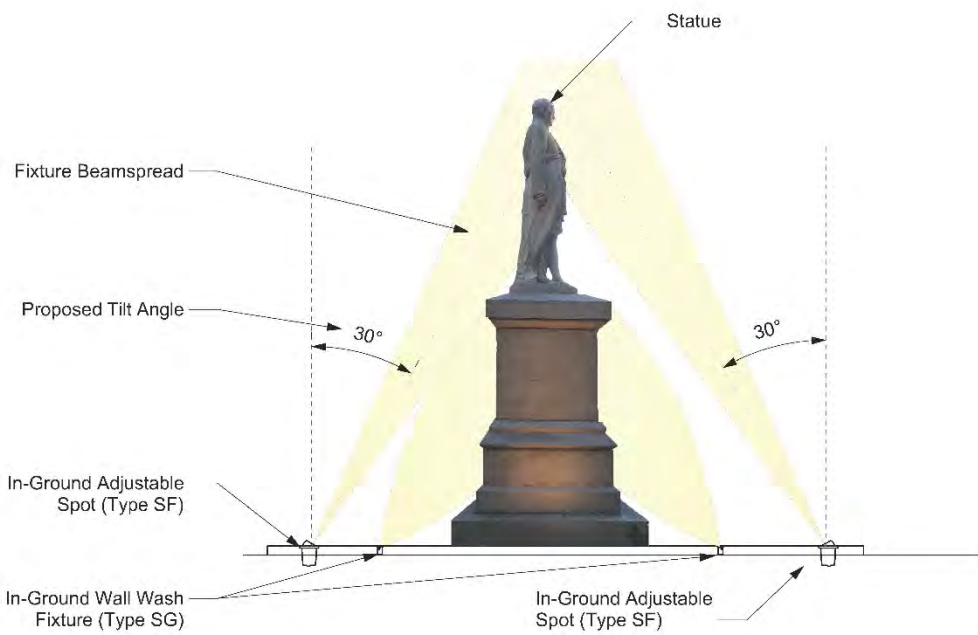

1 Section Looking South East
Scale: 1/4" = 1'-0"

2 Section Looking North East
Scale: 1/4" = 1'-0"

This Drawing Shows Design Intent Only And Is
Not To Be Used As A Construction Document

EXISTING SITE CONDITIONS: GLOVER

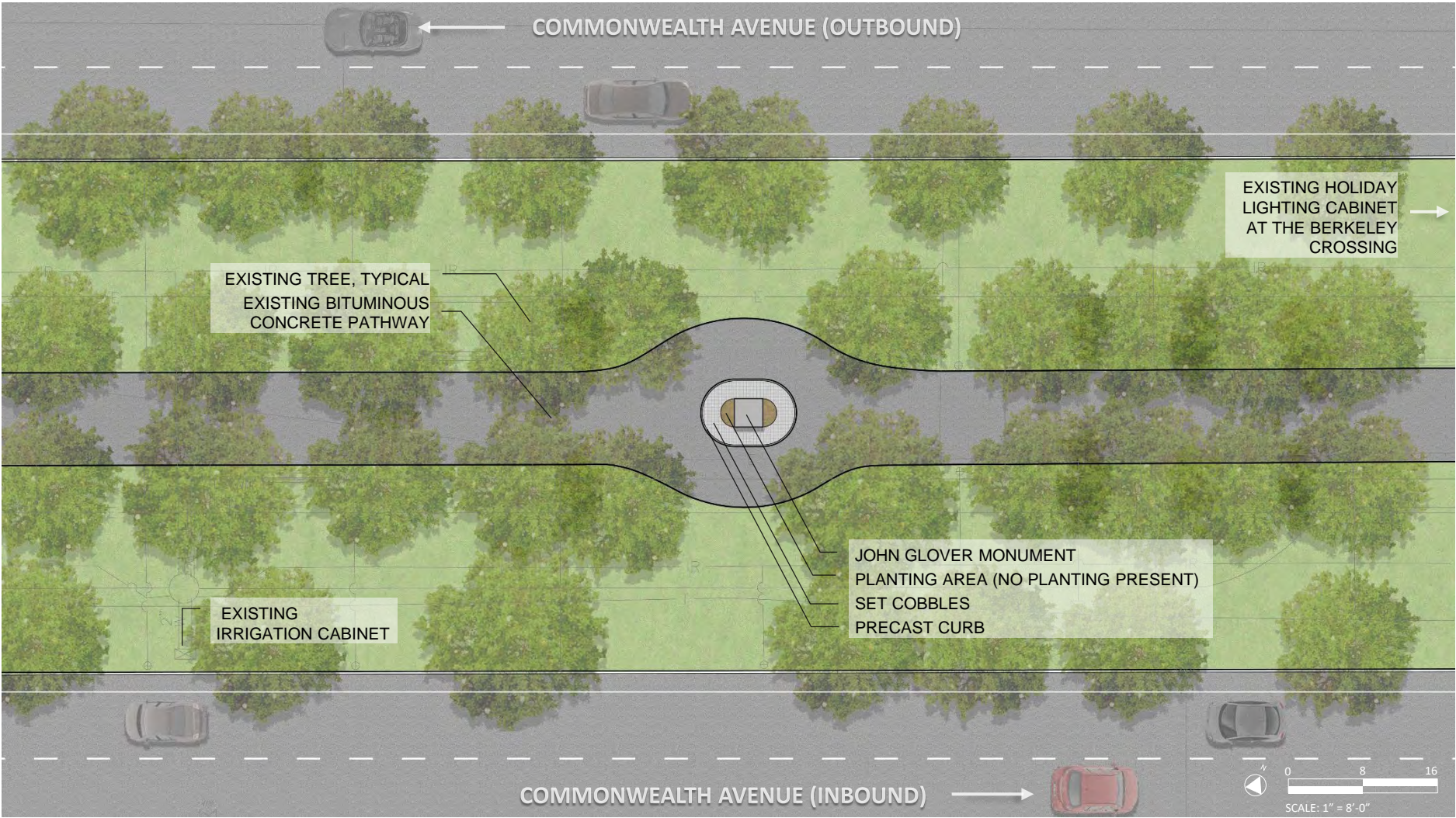







BASIC IMPROVEMENT PROGRAM: GLOVER



- Statue uplighting and incidental electrical work
- Treatment of set cobbles
- Curb replacement
- Walkway repaving
- Site restoration
- Protection of existing trees

PROPOSED SITE IMPROVEMENTS: GLOVER

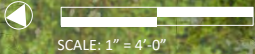
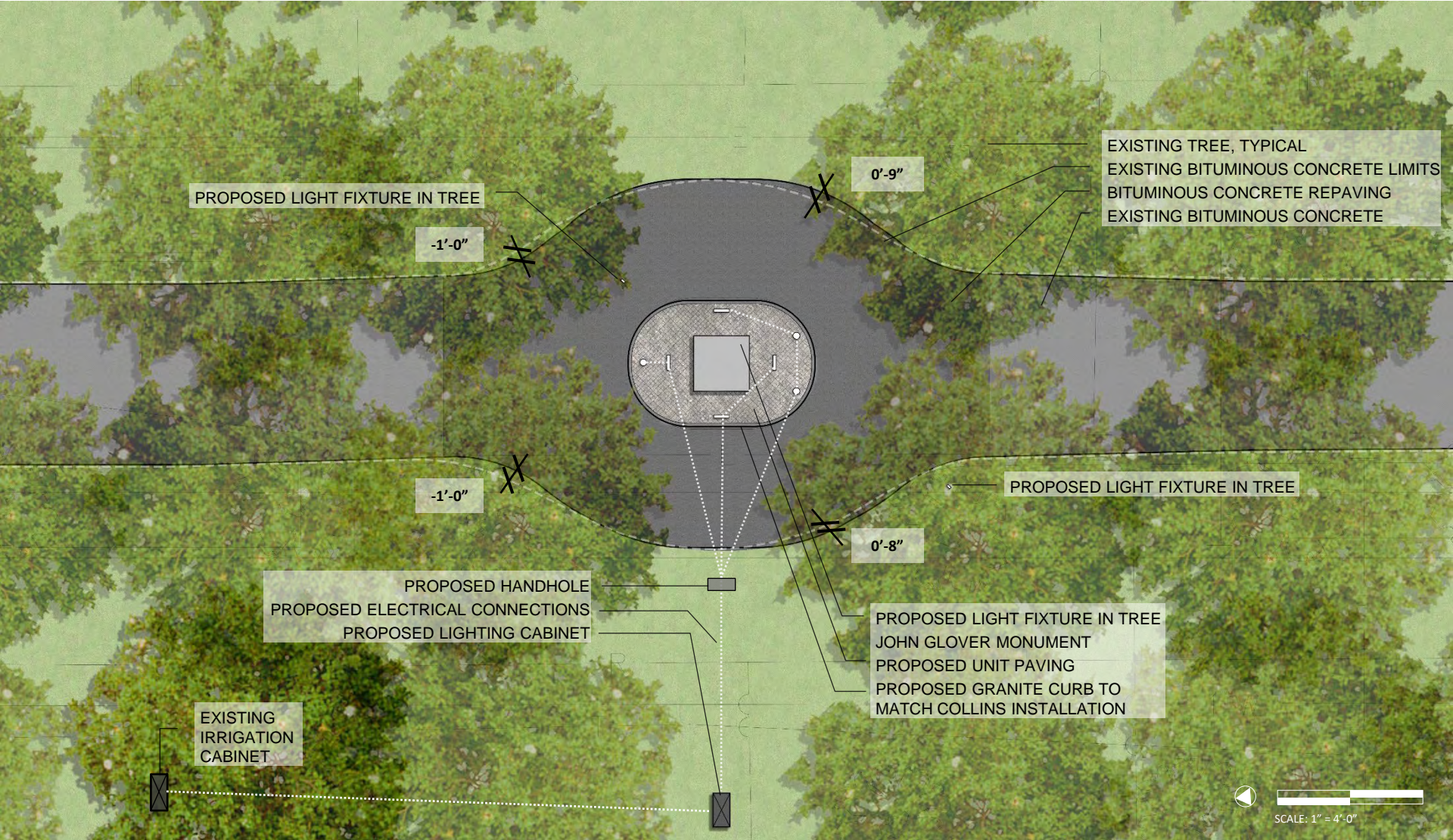

SCALE: 1" = 4'-0"



FRIENDS
OF THE
PUBLIC GARDEN

LIGHTING FIXTURE PLAN: GLOVER

Reference Notes (Specific to this Page only)

- A** 8" Diameter in-ground adjustable fixture. (Type SC) Typical.
- B** 2-1/2" Square by 5" long tree-mounted adjustable accent fixture. Fixture height TBD with a long half snoot on the bottom of fixture. (Type SE-2)
- C** 3-1/2" Wide by 5" tall by 18" long in-ground cut-off wall wash fixture. (Type SG) Typical.
- D** 2-1/2" Square by 5" long tree-mounted adjustable accent fixture. Fixture mounted in tree over statue with a long half snoot on the North East approach side. Exact location TBD. (Type SE-2)

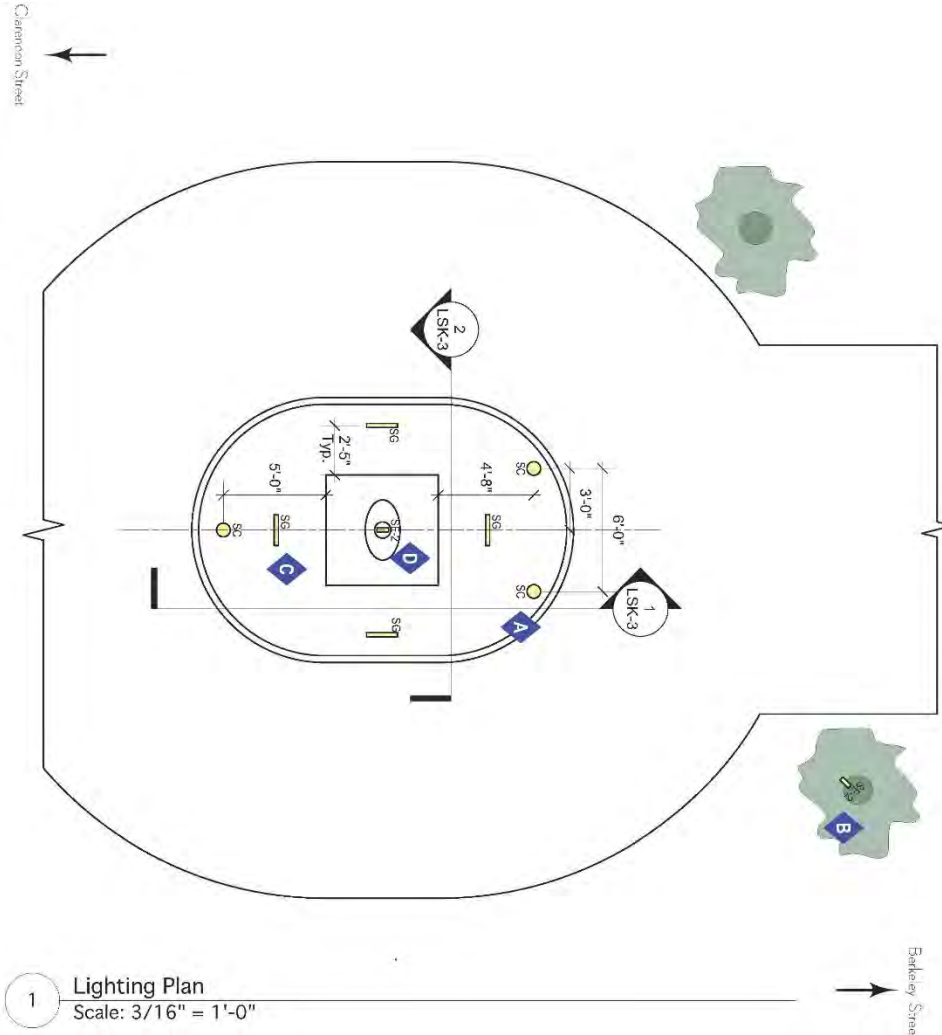

Type SC Fixture Image



Type SE-2 Fixture Image



Type SG Fixture Image

This Drawing Shows Design Intent Only And Is
Not To Be Used As A Construction Document

LIGHTING FIXTURE PLAN: GLOVER



LIGHTING FIXTURE PLAN: GLOVER



LIGHTING FIXTURE PLAN: GLOVER

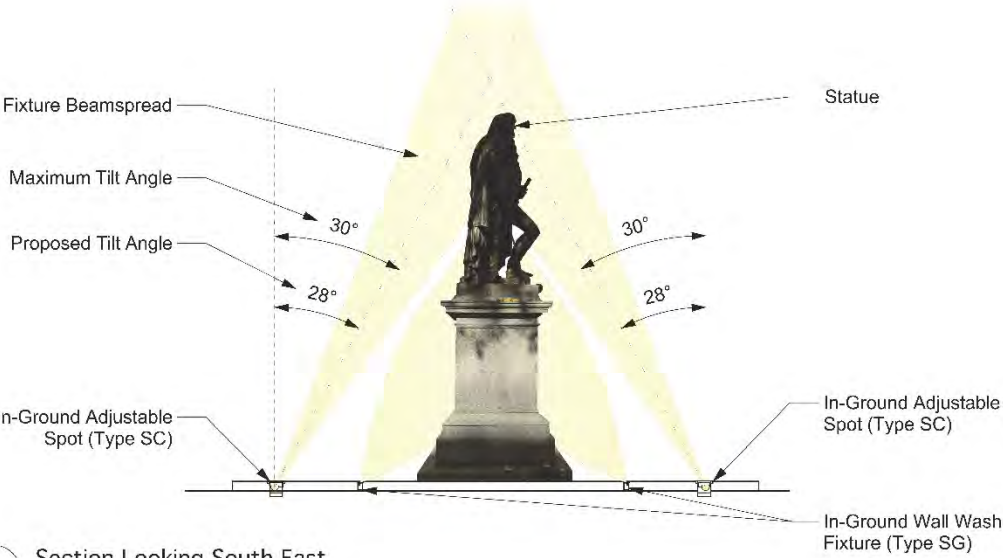

1 Section Looking South East
Scale: 1/4" = 1'-0"

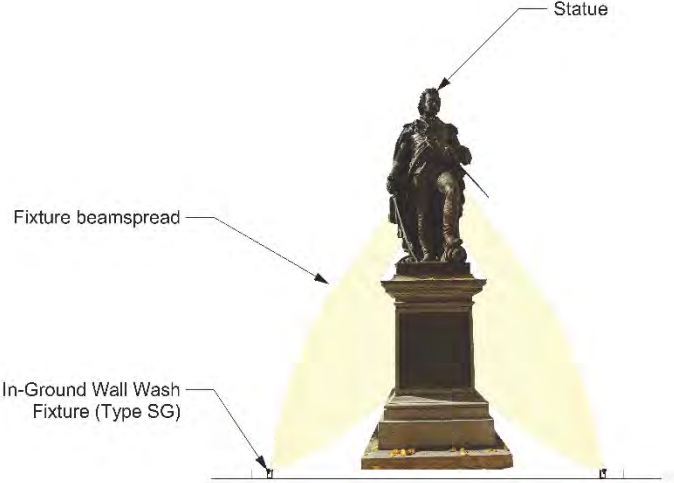

2 Section Looking North East
Scale: 1/4" = 1'-0"

This Drawing Shows Design Intent Only And Is
Not To Be Used As A Construction Document



EXISTING SITE CONDITIONS: GARRISON

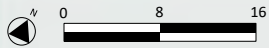
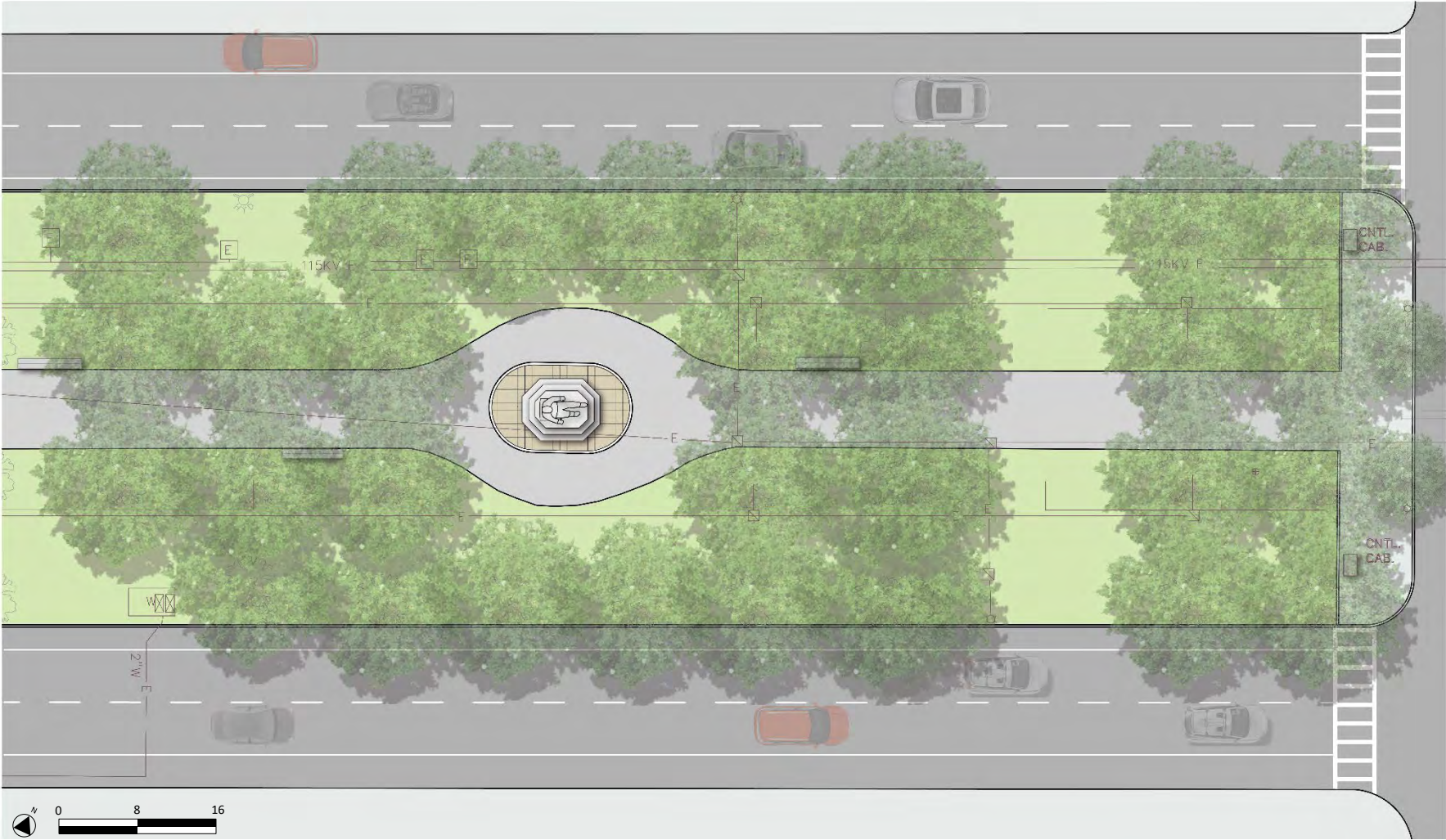

SCALE: 1" = 8'-0"



PROPOSED SITE IMPROVEMENTS: GARRISON

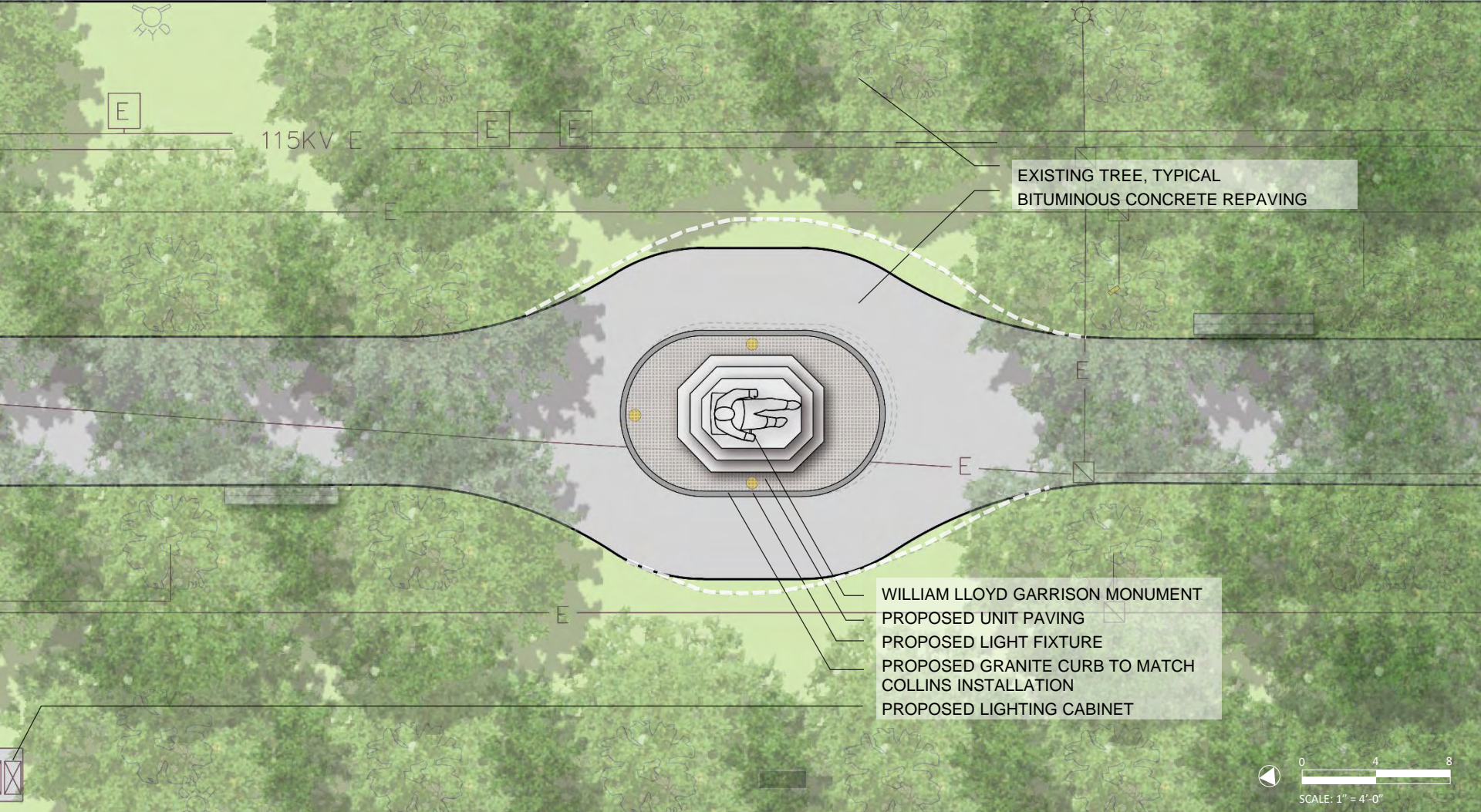

EXISTING TREE, TYPICAL
BITUMINOUS CONCRETE REPAVING

WILLIAM LLOYD GARRISON MONUMENT
PROPOSED UNIT PAVING
PROPOSED LIGHT FIXTURE
PROPOSED GRANITE CURB TO MATCH
COLLINS INSTALLATION
PROPOSED LIGHTING CABINET

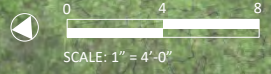

EXISTING SITE CONDITIONS: SARMIENTO

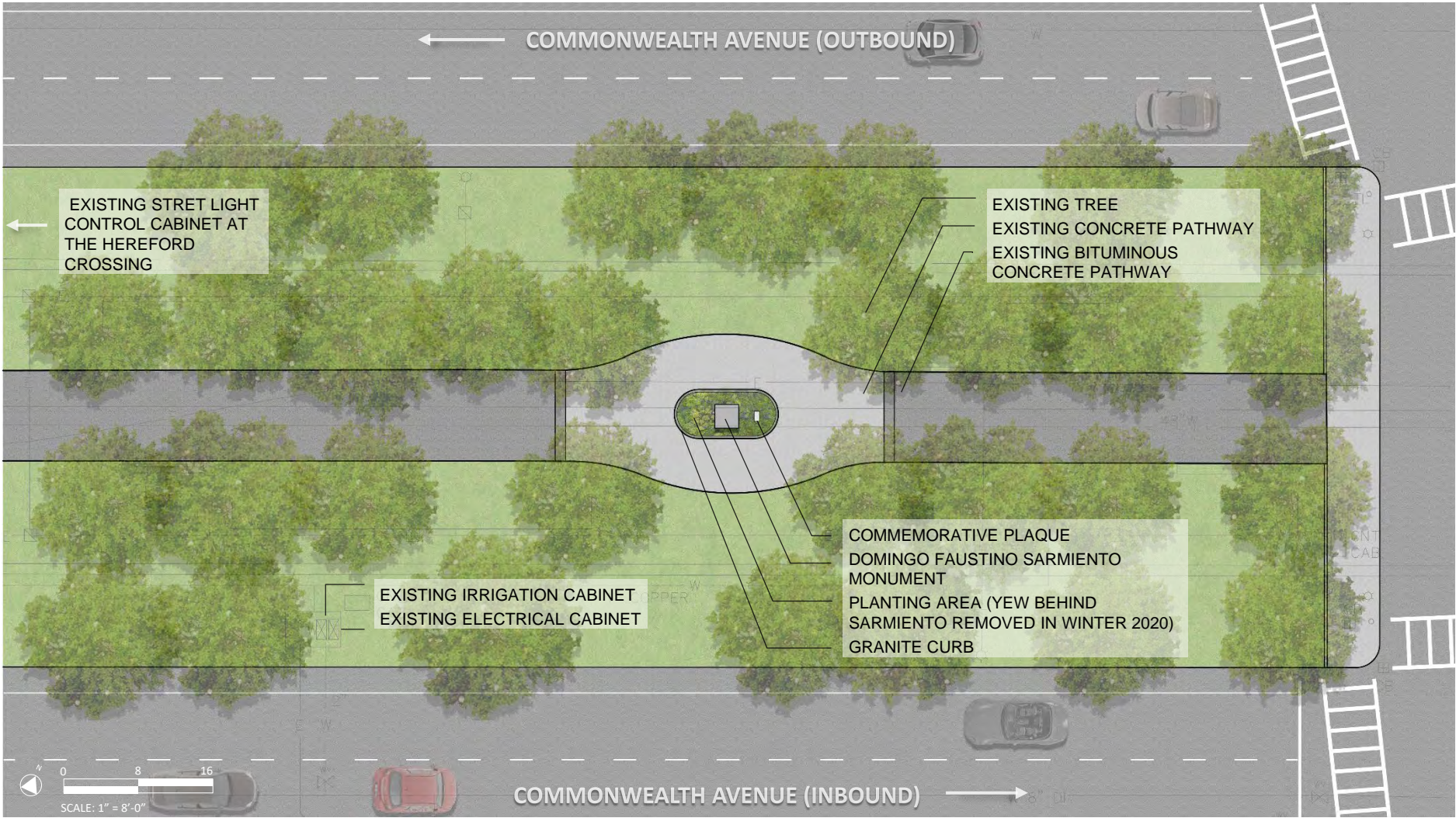

YEW REMOVED
WINTER 2020





YEW REMOVED
WINTER 2020





BASIC IMPROVEMENT PROGRAM: SARMIENTO



- Statue uplighting and incidental electrical work
- Planting improvements
- Additional curbing to accommodate uplighting placement
- Site restoration
- Protection of existing trees

PROPOSED SITE IMPROVEMENTS: SARMIENTO

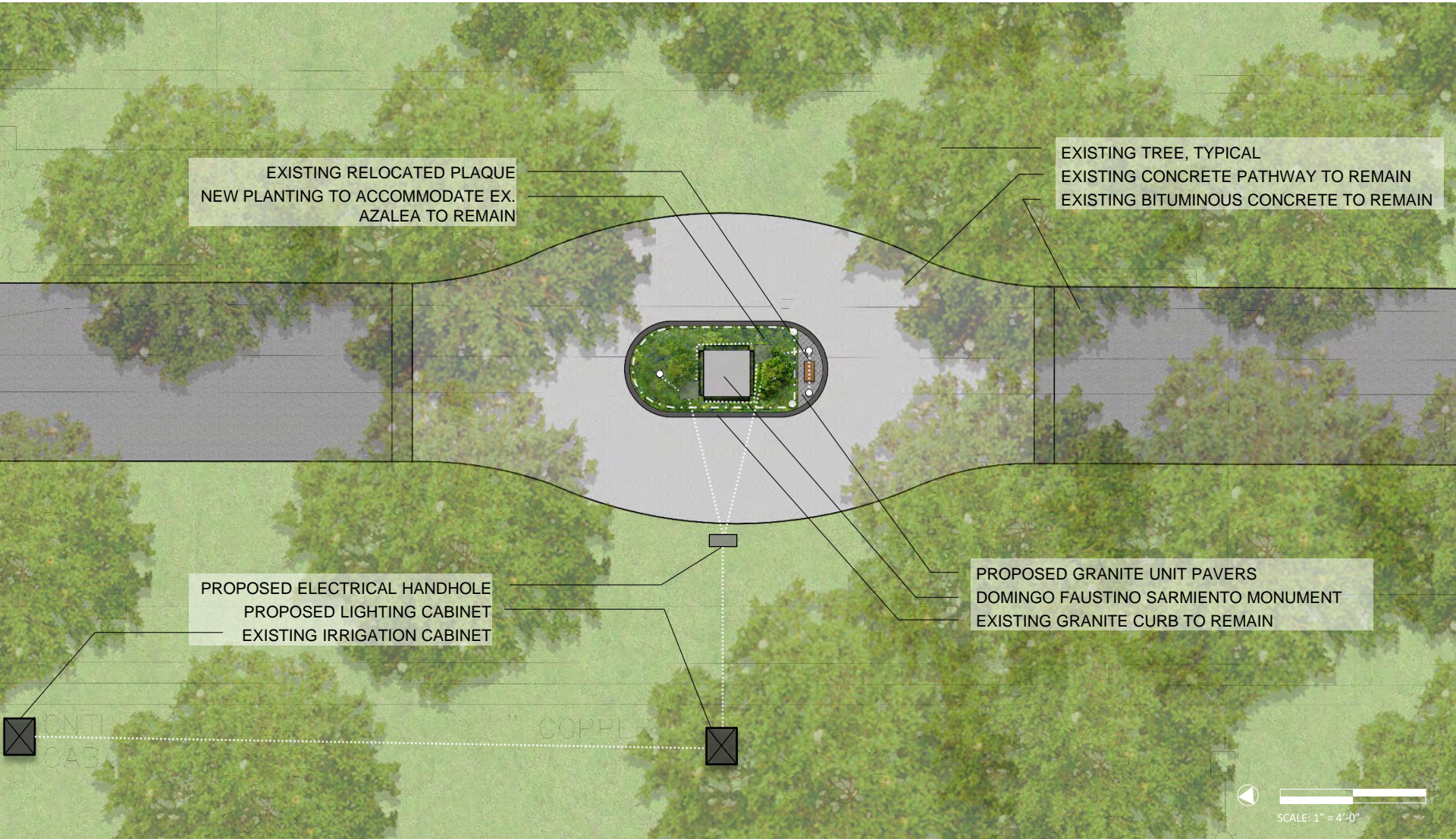

PROPOSED SECTIONS: SARMIENTO

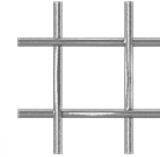

PROPOSED MESH (METAL TO MATCH VALENCE SECTION)

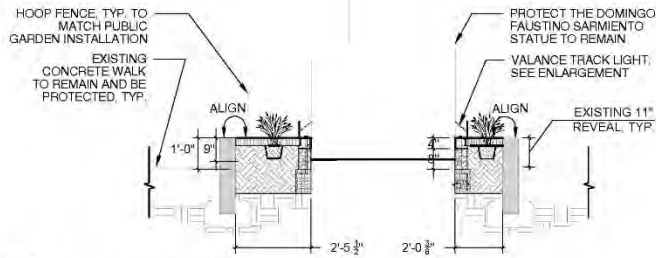

A SARMIENTO STATUE- NORTH / SOUTH SECTION
SCALE: 1" = 3'-0"

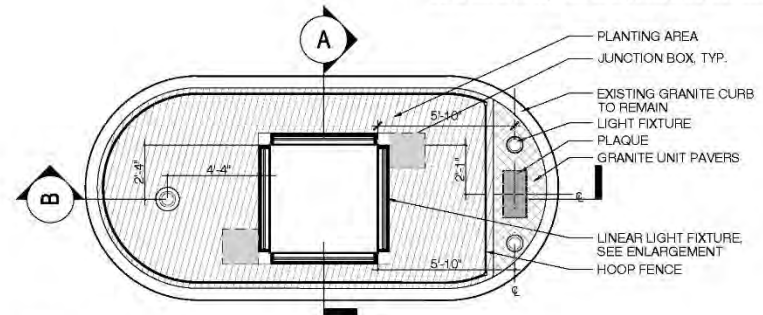

1 PLAN
NTS

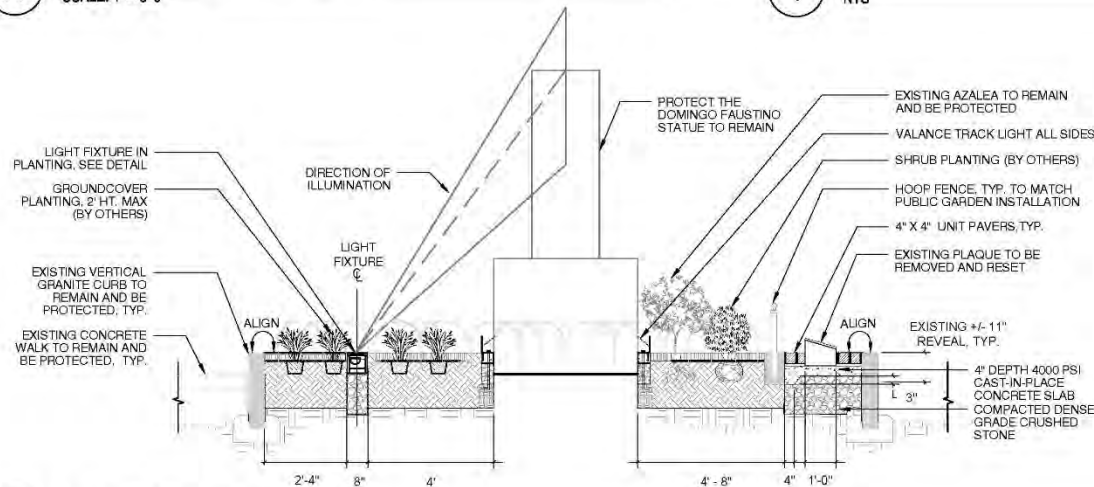

B SARMIENTO STATUE- WEST / EAST SECTION
SCALE: 1" = 3'-0"

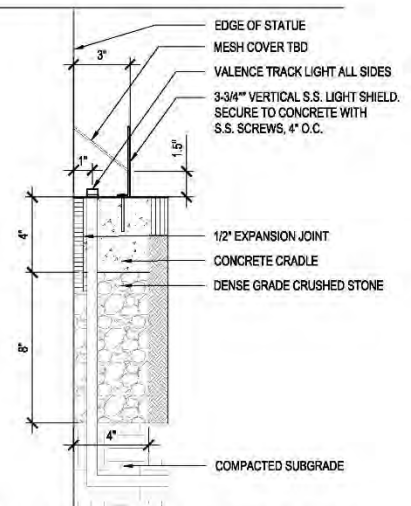

2 VALENCE TRACK LIGHT ENLARGEMENT - SECTION
SCALE: 1" = 5'-0"



LIGHTING FIXTURE PLAN: SARMIENTO

Reference Notes (Specific to this Page only)

- A** 2-1/2" Square by 5" long tree-mounted adjustable accent fixture. Fixture height to be determined. (Type SE-2)
- B** 8" Diameter in-ground adjustable fixture installed in concrete pad. (Type SC) Typical.
- C** 3/4" Wide x 3/4" Tall x 4' long Surface-Mounted Linear Graze Fixture attached to stone base just above finished grade.

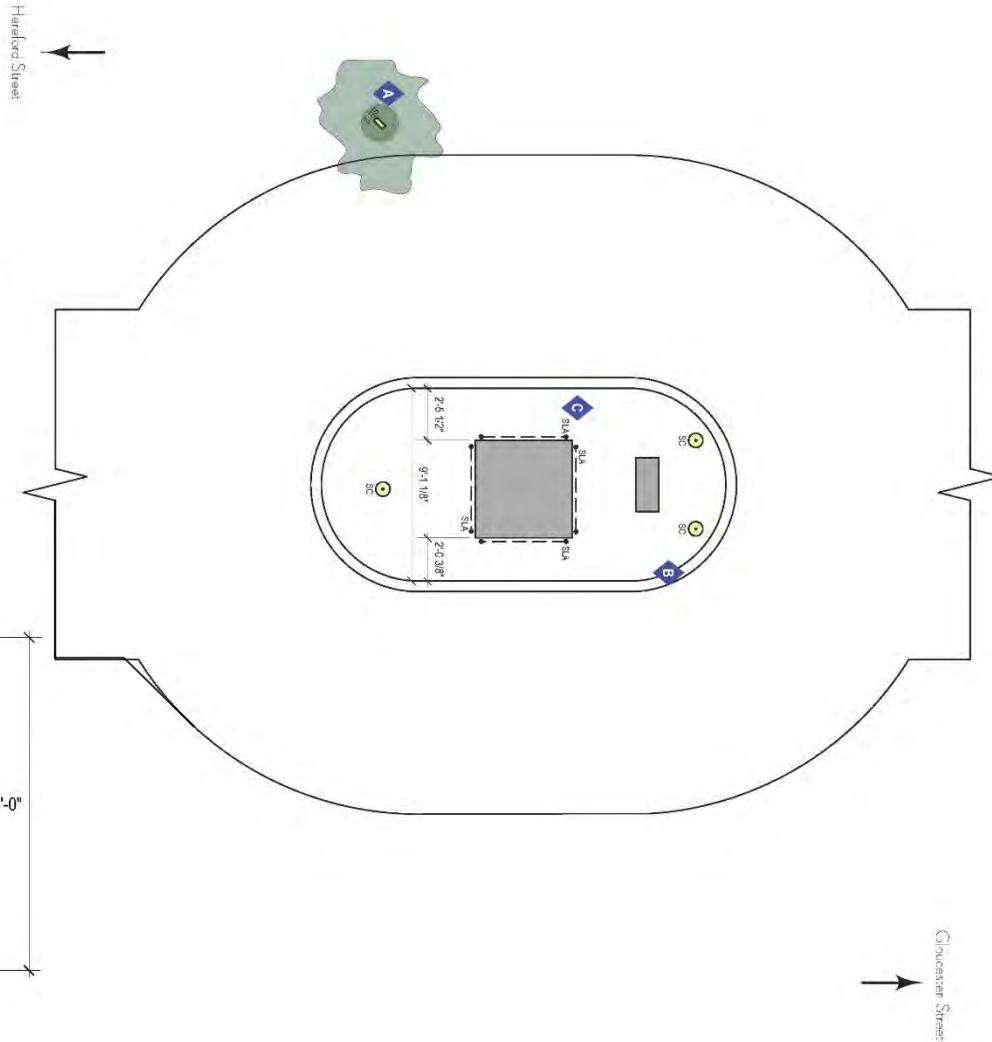

Type SE-2 Fixture Image



Type SC Fixture Image



Type SLA Fixture Image

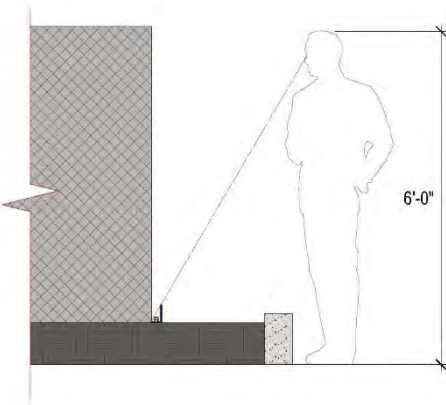

1 Sarmiento Sightline Study
Scale: 1/2" = 1'-0"

This Drawing Shows Design Intent Only And Is
Not To Be Used As A Construction Document



LIGHTING FIXTURE PLAN: SARMIENTO



PROPOSED LIGHTING CABINET AT ALL STATUES



To Match Look of the New Cabinet at previous lighting improvement projects

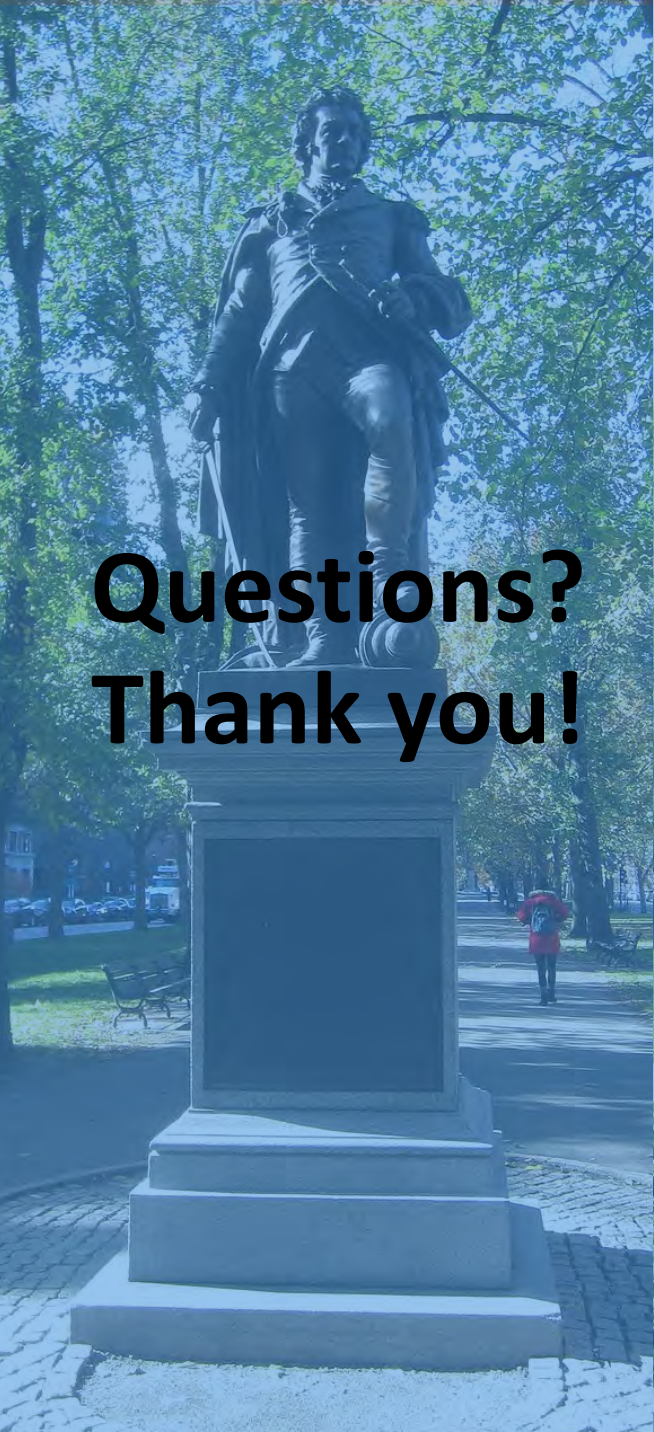

Questions?
Thank you!



FRIENDS
OF THE
PUBLIC GARDEN