

407 Beacon Street Boston, MA

Site Location

Locus Plan

April 18, 2017
REV. May 16, 2017

sitecreative
landscape architecture





Stair paint to be custom matched with existing moulding

Evergreen tree to be relocated to left of stair

Deciduous tree to remain

Remove remaining shrubs and gravel and replace with new per planting plan

Existing View from Beacon Street

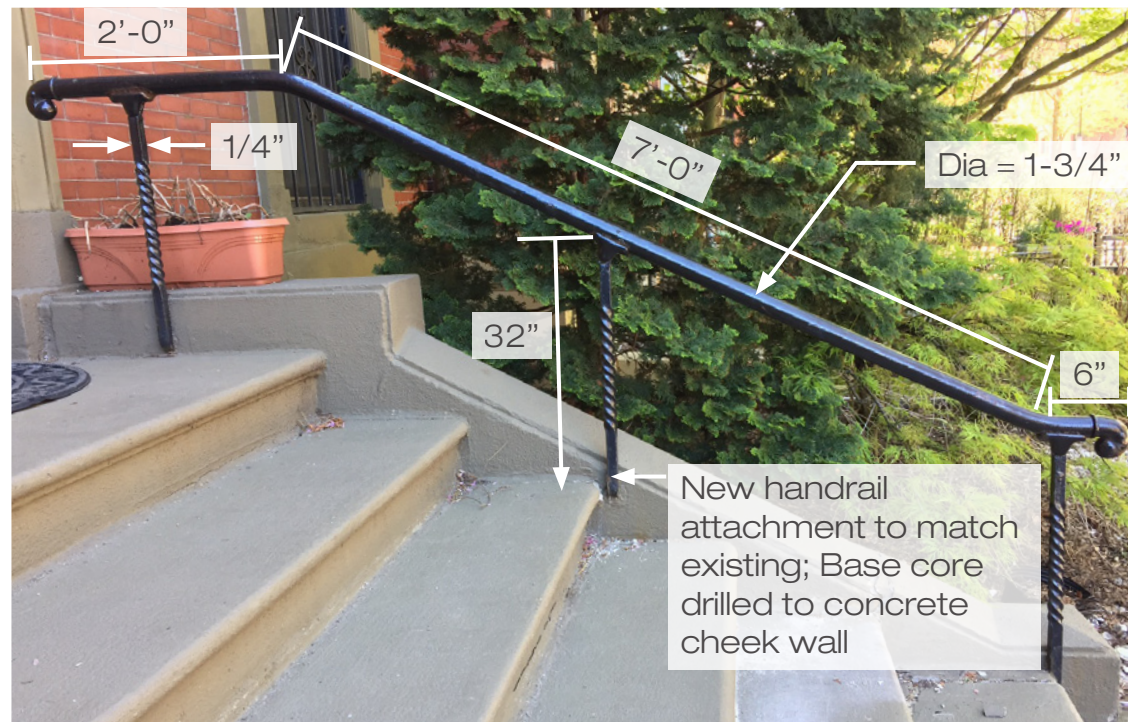

Existing Handrail - New handrail on opposite side to match



View from Walkway

Blue Spruce to be removed



Stair Paint Color:
Benjamin Moore
'Hancock Gray'
HC-97

(to match existing trim color)

Planting Palette

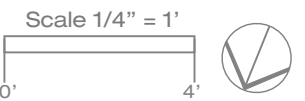
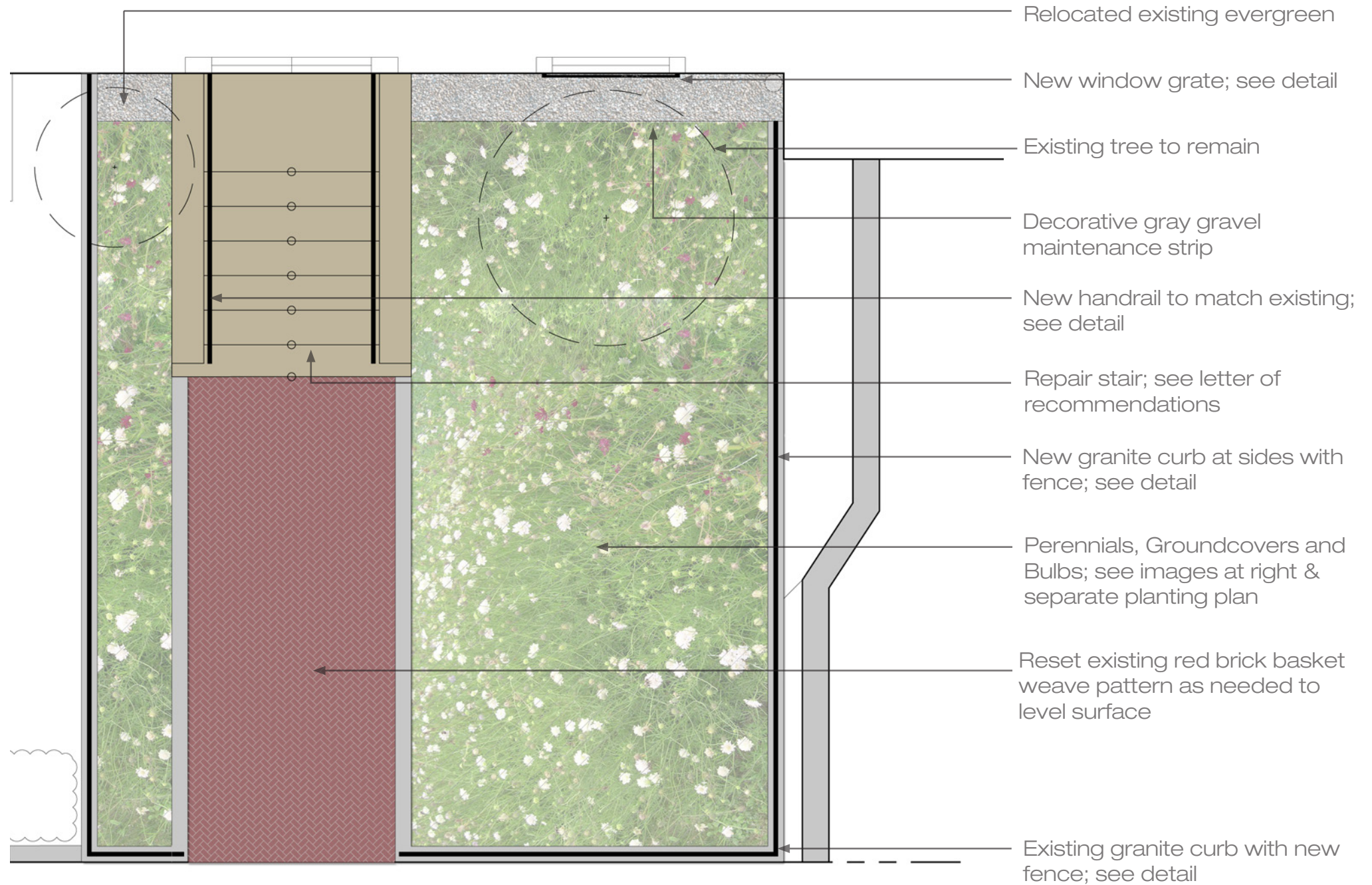
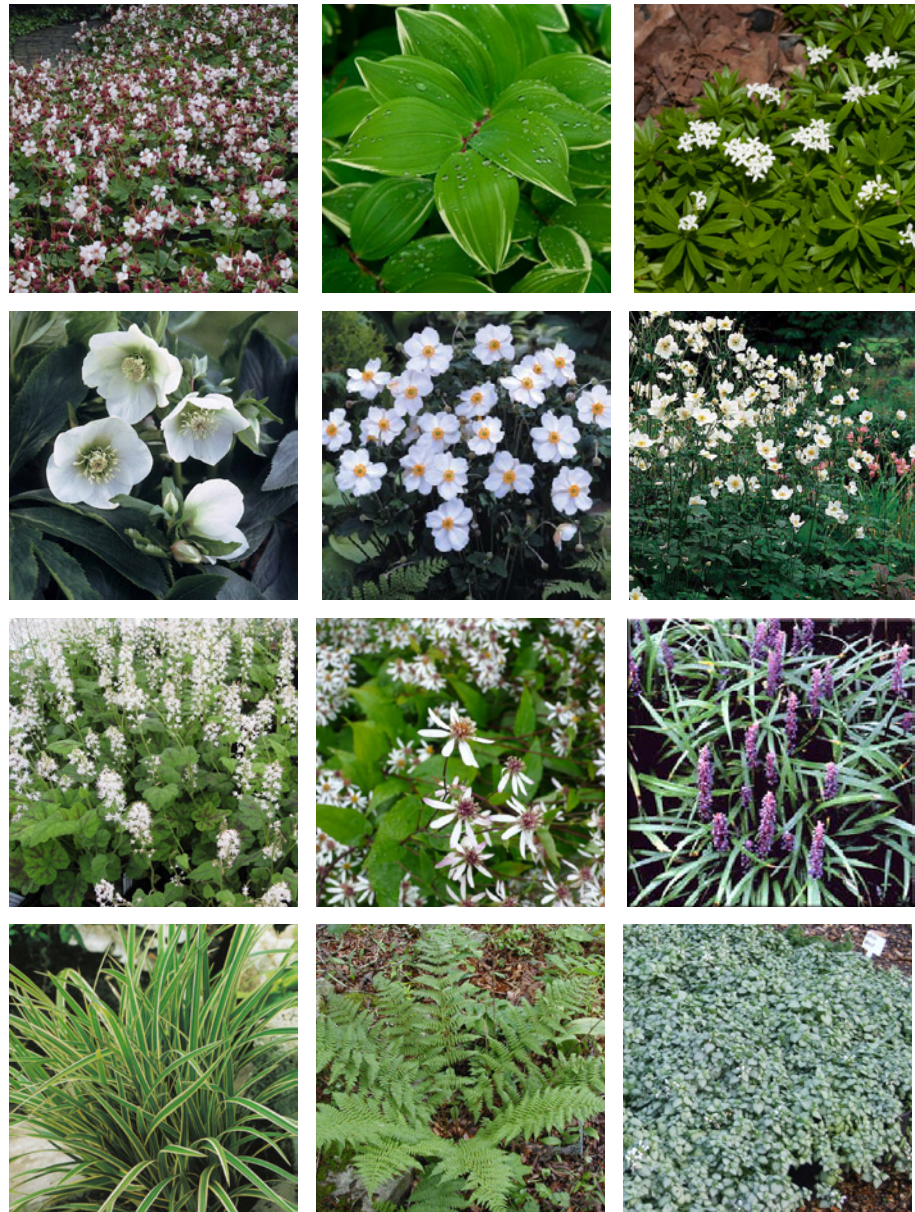

PLANT LIST					
QTY	SYM	BOTANICAL NAME	COMMON NAME	SIZE	REMARKS
PERENNIALS/GROUNDCOVERS					
15	AN	Anemone hybrida 'Honorine Jobert'	Windflower	1 gal.	18" o.c.
12	AD	Aster divaricatus	Wood Aster	1 gal.	18" o.c.
74	CM	Carex moroii 'Ice Dance'	Varigated Sedge	4" pot	9" o.c.
12	DR	Dryopteris marginalis	Evergreen Fern	1 gal.	12" o.c.
44	GM	Geranium macrorrhizum 'Spessart'	White Cransbill	4" pot	15" o.c.
69	GO	Galium odoratum	Sweet Woodruff	3" pot	8" o.c.
20	HE	Helleborus hybridus 'White Lady'	White Hellebore	1 gal.	12" o.c.
64	LM	Lamium maculatum 'White Nancy'	Lamium	3" pot	8" o.c.
68	LS	Liriope spicata	Lily Turf	4" pot	9" o.c.
17	PF	Polygonatum falcatum 'Variegatum'	Variegated Solomnseal	1 gal.	18" o.c.
39	TA	Tiarella cordifolia	Heartleaf Foamflower	4" pot	15" o.c.

PERENNIALS WITHIN GROUNDCOVER:

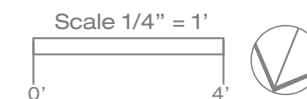
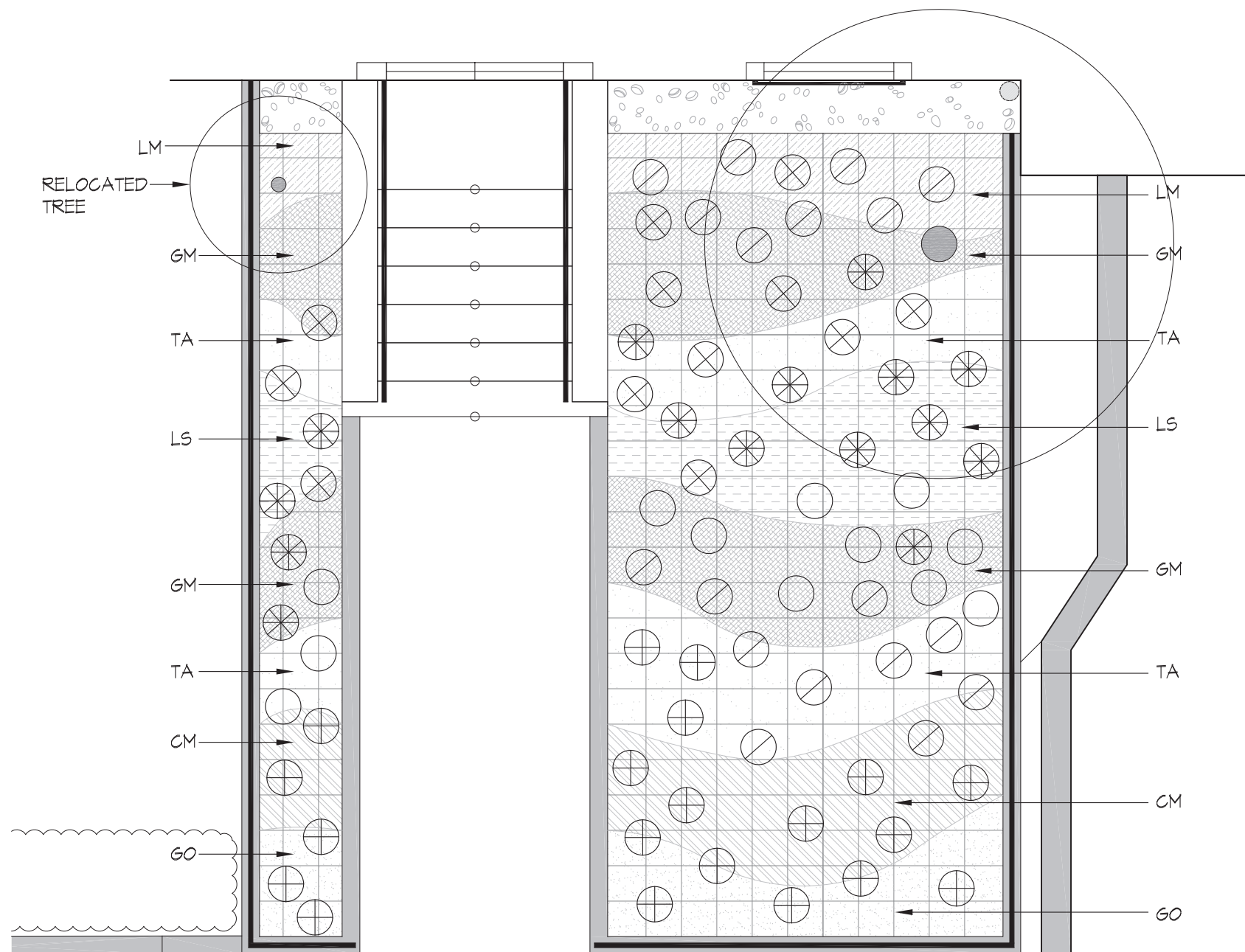
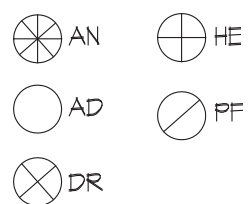

Picket Detail

The Lawler Line® 

Product Information	
Item No.:	QC-702
	Paramount baluster
Dimensions:	
Height:	39 1/2 in.
Weight:	3.75 lb.
Bar Stock:	1/2-9/16 in. sq.

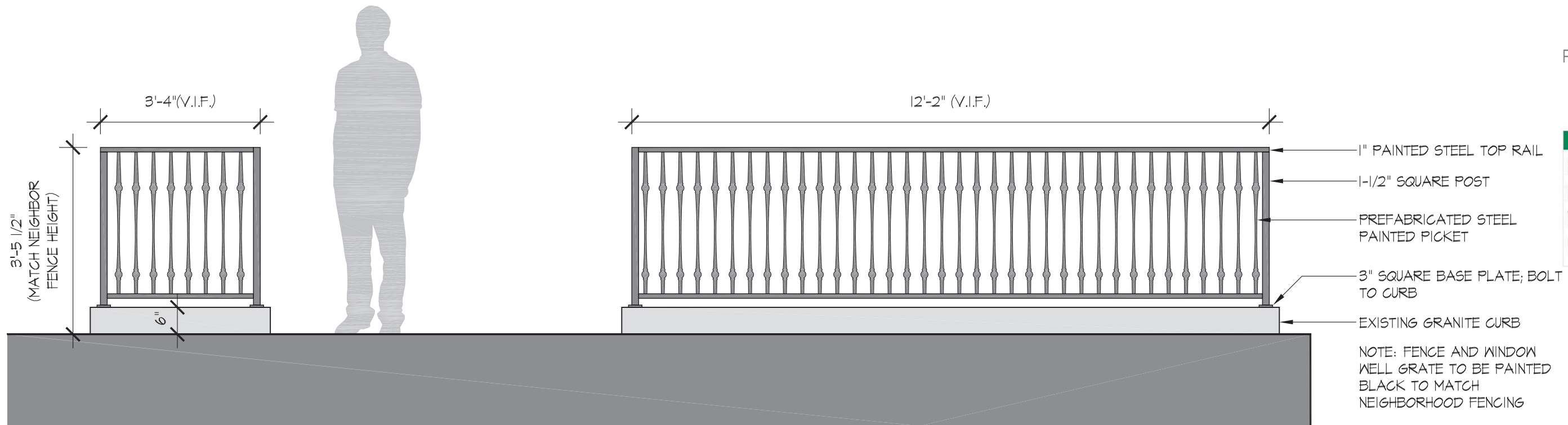

Proposed Fence Elevation - Front Entry
Scale: 1/2" = 1'-0"

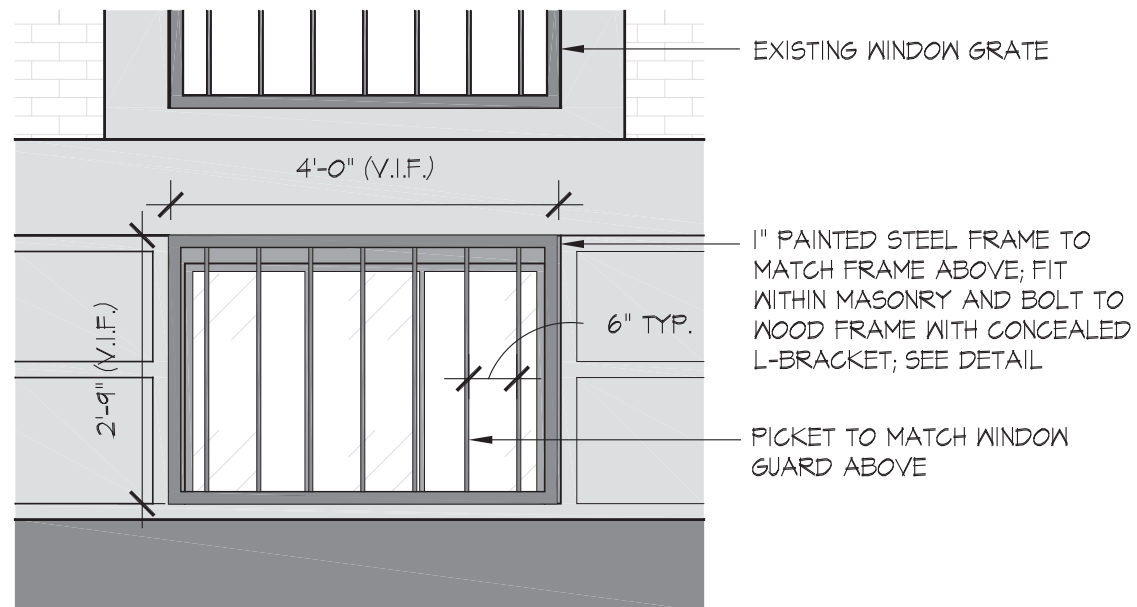

Proposed Window Well Grate
Scale: 1/2" = 1'-0"

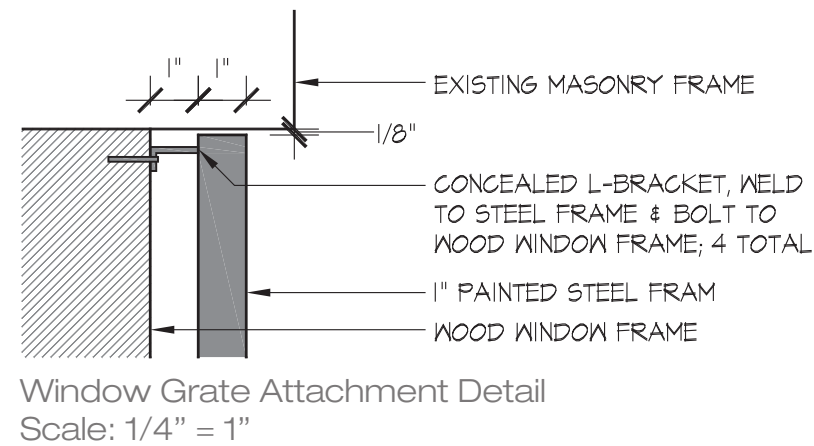

Window Grate Attachment Detail
Scale: 1/4" = 1"



New Lower Window Grate to Match Existing

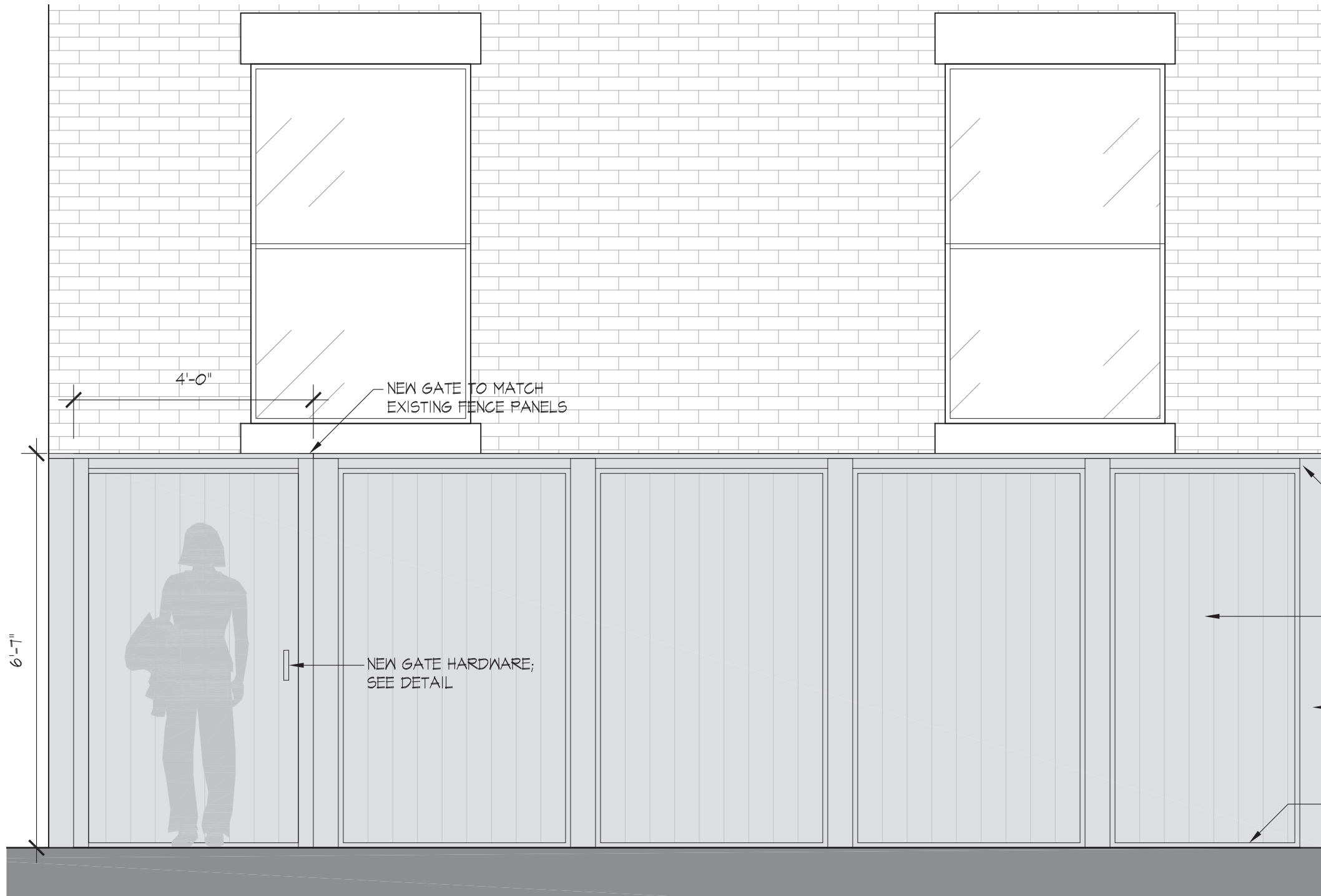

Existing Fence Repair - Elevation
Scale: 1/2" = 1'-0"

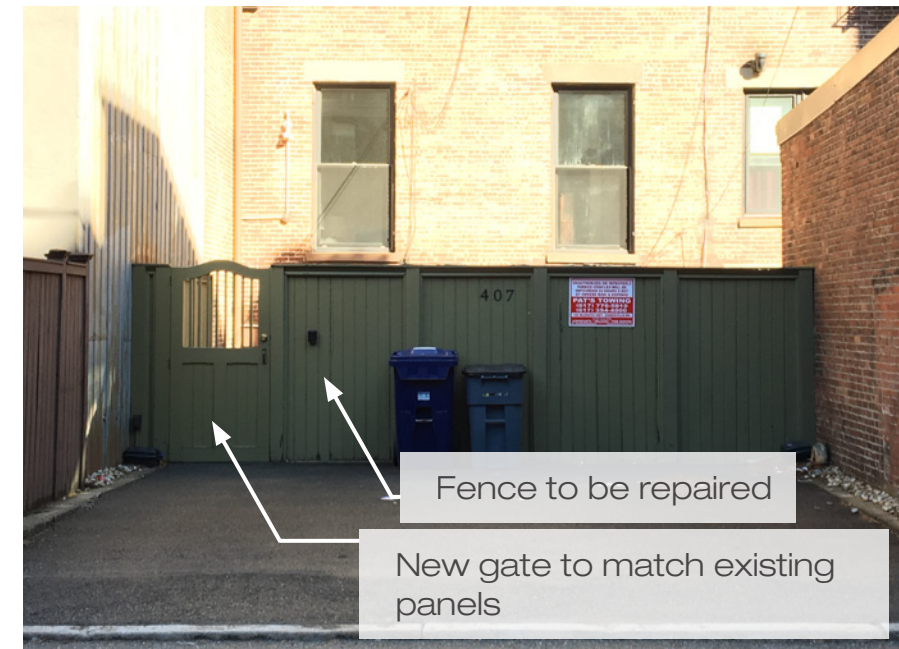

Existing View from Alley 415

- REPAIR AND REPLACE TOP BOARD WHERE NEEDED
- REPAIR AND REPLACE INTERIOR MOLDING WHERE NEEDED; MATCH EXISTING
- NEW 1"x4" T&G BOARDS TO MATCH & REPLACE EXISTING 1"x4" BOARDS
- EXISTING 5" SQ POSTS TO REMAIN
- REPAIR SKIRT MOLDING OR REPLACE TO MATCH EXISTING



Fence Paint Color:
Benjamin Moor 'Pewter'
2121-30



Entry Set by Rocky Mountain Hardware;
Escutcheons: 2-1/4" x 2-1/4";
Dead Bolt: 2-1/4" x 3-1/4"; Finish White Bronze Dark

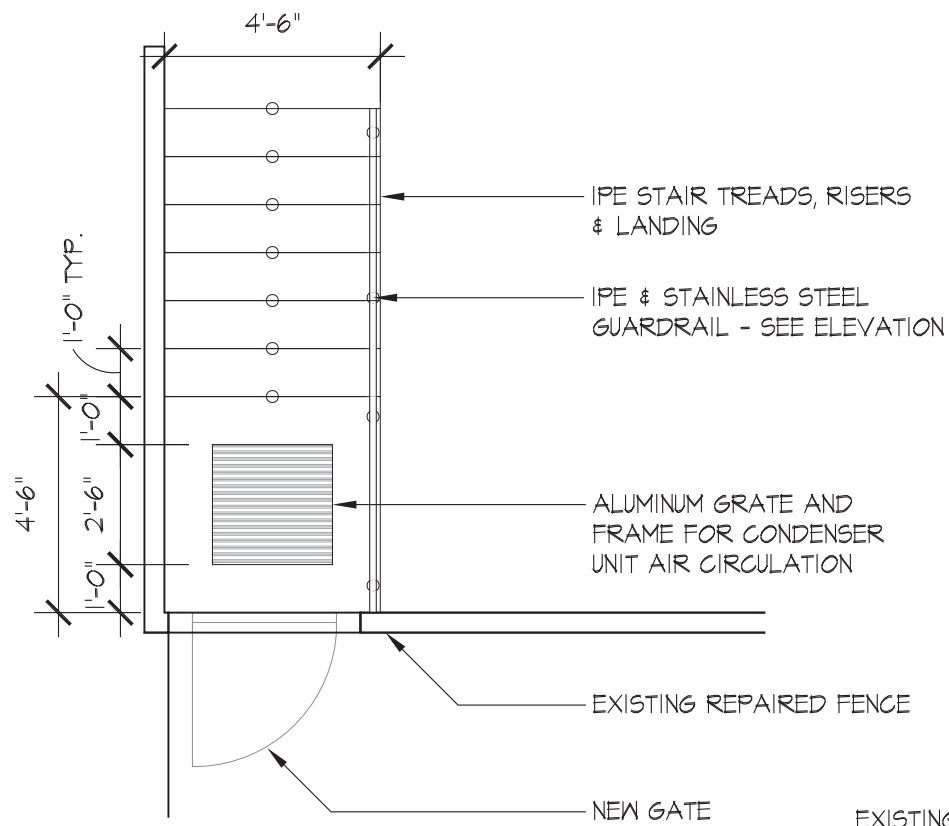

New Interior Stair and Landing - Plan
Scale: 1/4" = 1'-0"



Existing stair to be replaced



Existing stair damage



Existing condenser unit to be relocated under stair

EXISTING FENCE TO BE REPAIRED; SEE FENCE REPAIR DETAIL

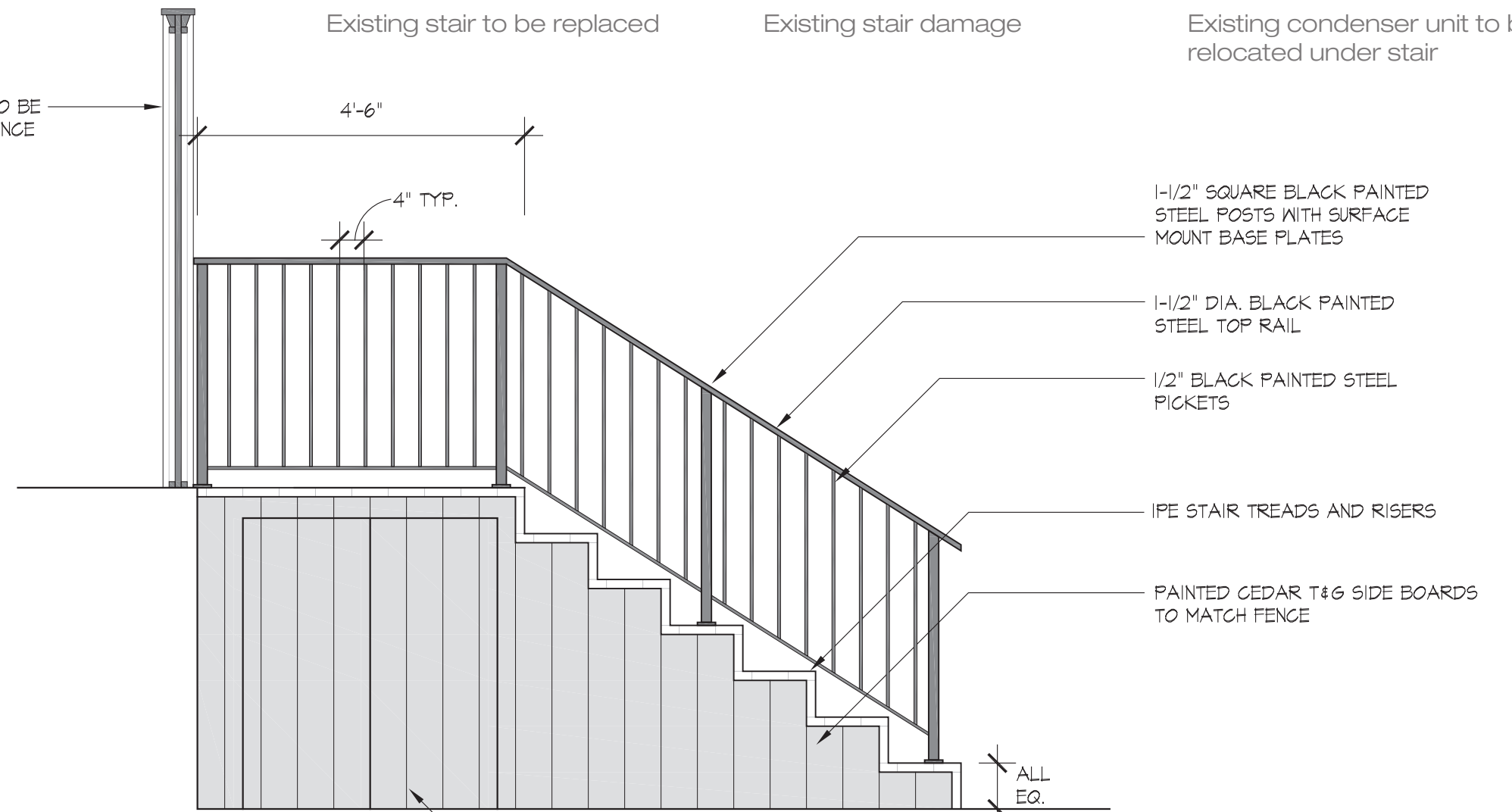

New Stair and Landing - Elevation
Scale: 1/2" = 1'-0"

CONCEALED PUSH TO OPEN DOORS TO ACCESS RELOCATED CONDENSER UNIT

NOTE: NEW STAIR INSIDE COURTYARD WILL NOT BE VISIBLE FROM A PUBLIC WAY